

## Lock – Luggage Compartment Lid– Remove and Install (41 726 0)

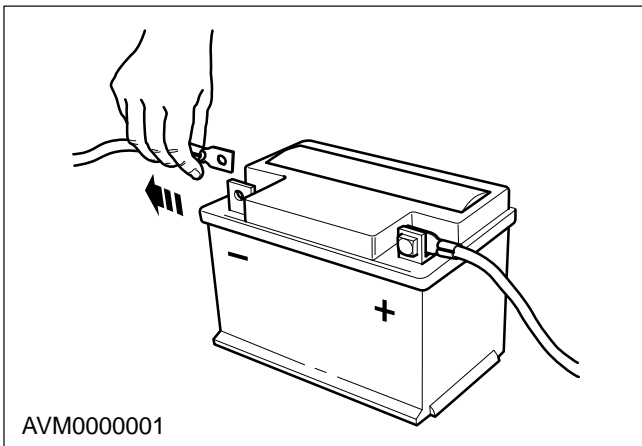

### Remove

1. Disconnect the battery negative lead.

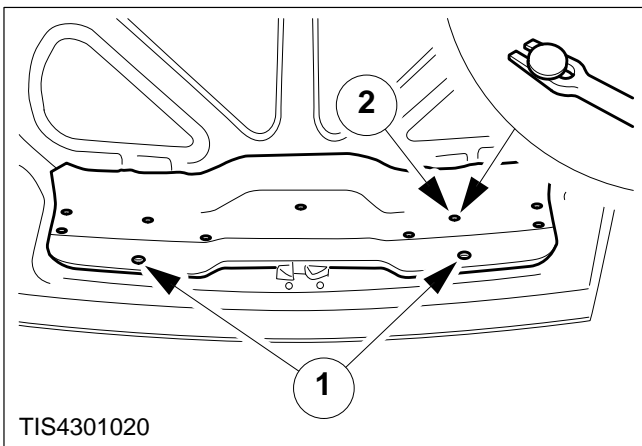

2. Remove the luggage compartment trim panel.

- 1 Two 90 degree twist clips.
- 2 Nine push clips.

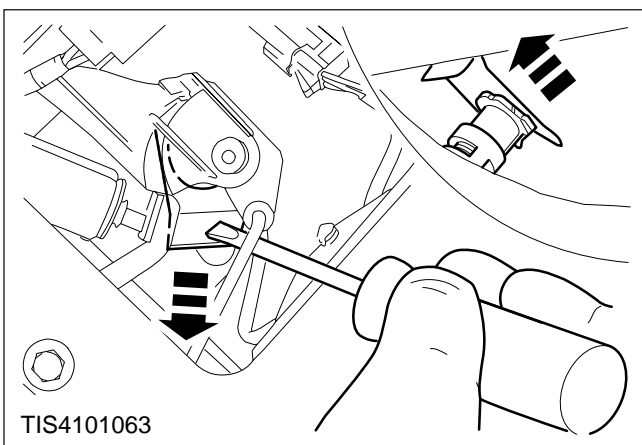

3. Remove the barrel retaining clip.

Push the spring clip to remove.

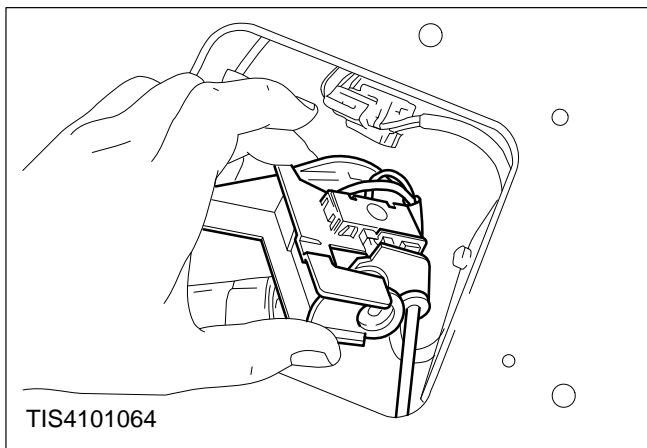

4. **Ease the actuator mechanism out from the compartment lid to access the barrel spacer tube.**

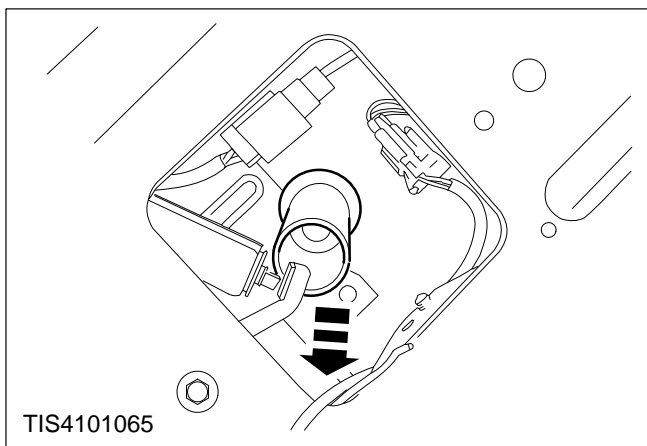

5. **Remove the spacer tube.**

6. **Remove the barrel from the luggage compartment lid.**

Ease out from the panel.

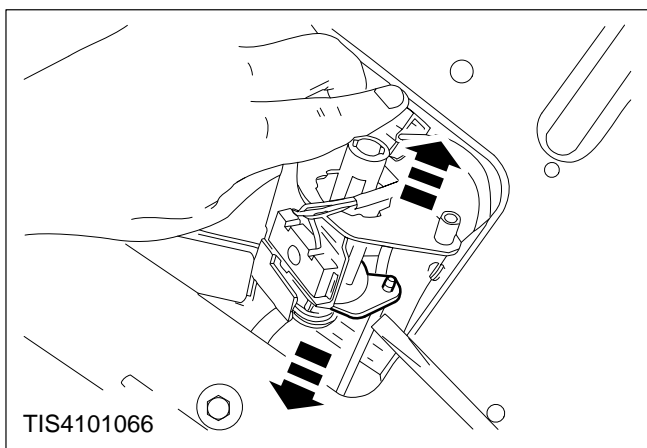

7. **Disconnect the lock actuating rod.**

Turn the actuator mechanism through 90 degrees and pull out the rod.

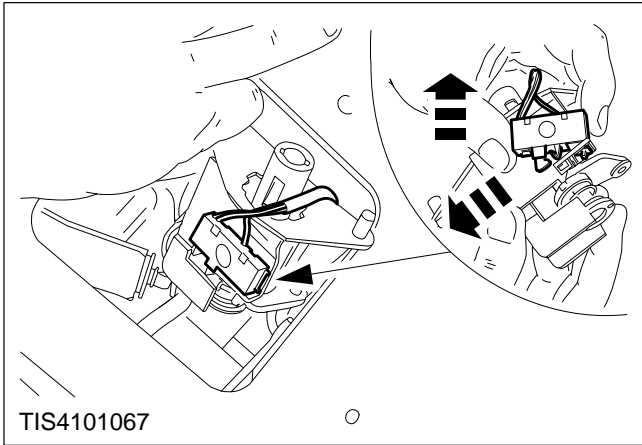

- 8. Disconnect the barrel set/reset switch and remove the actuator mechanism.**  
Carefully push and tilt the switch to remove.

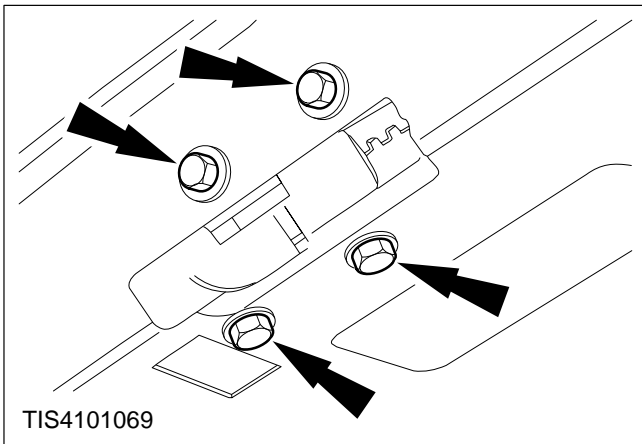

- 9. Remove the four lock retaining bolts.**

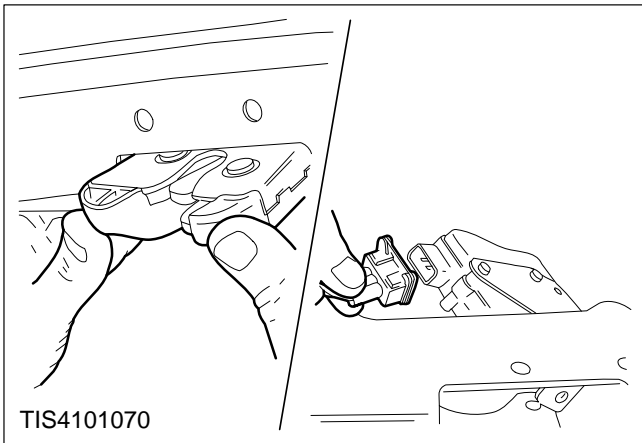

- 10. Push up the lock to access and disconnect the lock motor multiplug.**

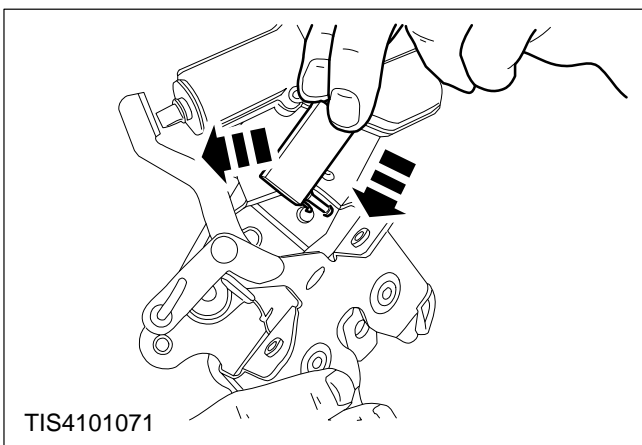

- 11. Displace the lock set/reset switch.**  
Push and tilt the switch to remove.

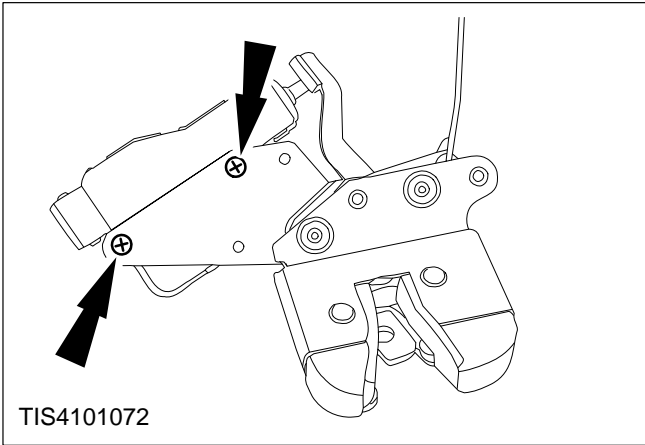

**12. Remove the lock motor.**  
Two screws.

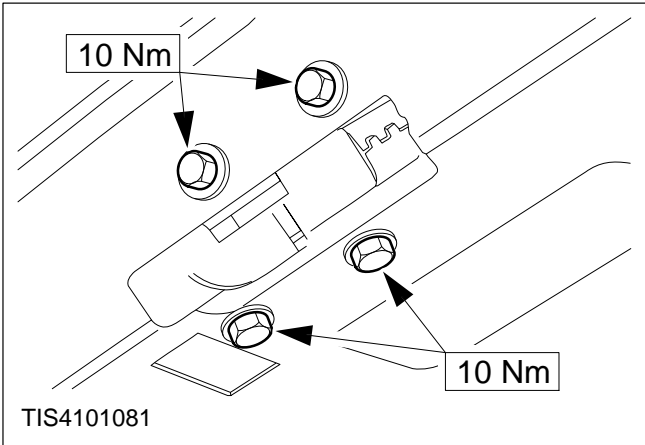

Install  
**13. Refit the components in reverse order.**