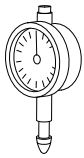
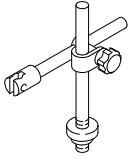
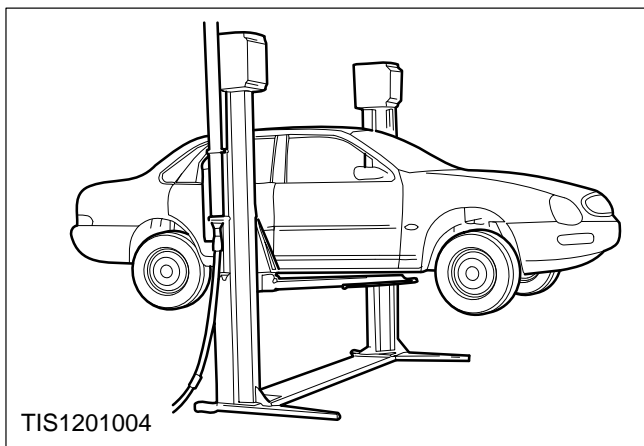

Brake Disc – Run-out – Check (Both sides) (12 221 0)**Special Tools**

	15-046 Dial Indicator Gauge
	15-022 Dial Gauge Holding Fixture

**Check**

1. Slacken the wheel nuts, raise the vehicle and remove the front and/or rear road wheels.

2. Refit the wheel nuts

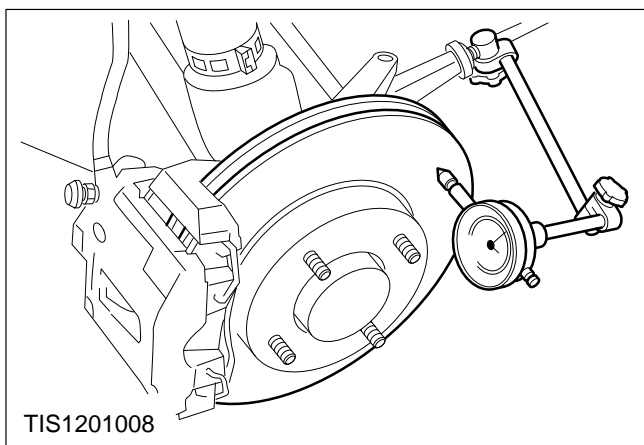

3. Measure the front brake disc run-out.

- Clean the disc face before measuring.
- Measure the run-out at the mid-point of the brake pad contact area.

4. Total disc run-out should not exceed 0,10 mm, if this figure is exceeded, the cause must be eliminated.

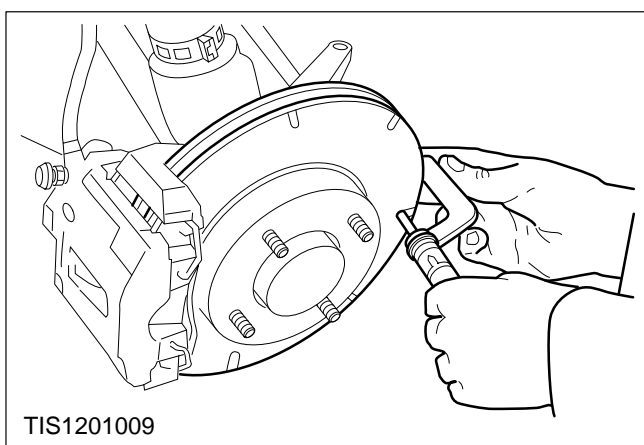

5. Check the front brake disc thickness variation.

- Using a suitable micrometer measure the disc thickness at eight positions 45° apart and 15 mm in from the outer edge of the disc.
- If any of these readings vary by 0,01 mm or more, or if the disc thickness is less than the permitted minimum the disc should be changed.

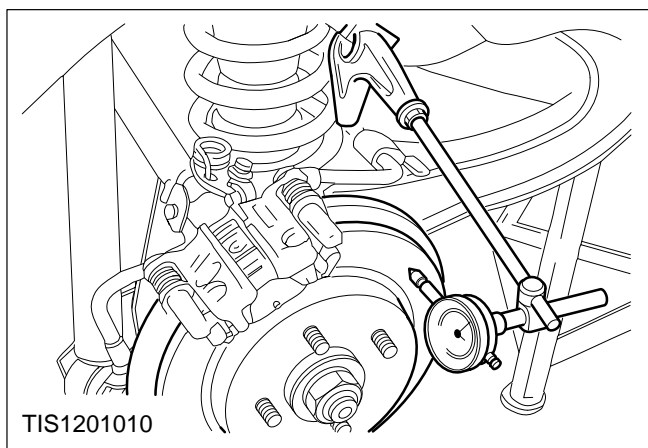

6. Measure the rear brake disc run-out.

- Clean the disc face before measuring.
- Measure the run-out at the mid-point of the brake pad contact area.

7. Total disc run-out should not exceed 0,10 mm, if this figure is exceeded, the cause must be eliminated.

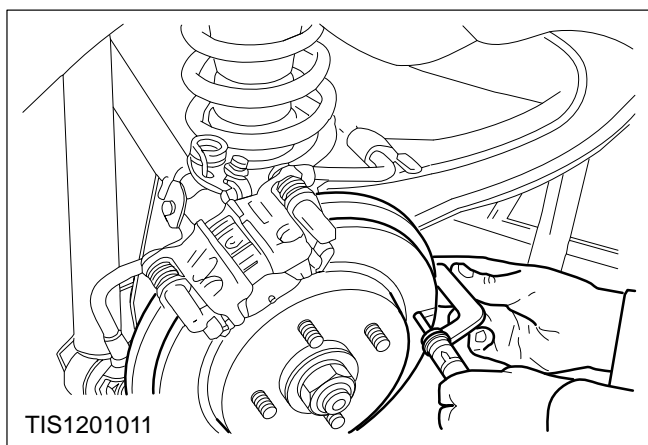

8. Check the rear brake disc thickness variation.

- Using a suitable micrometer measure the disc thickness at eight positions 45° apart and 15 mm in from the outer edge of the disc.
- If any of these readings vary by 0,01 mm or more, or if the disc thickness is less than the permitted minimum the disc should be changed.

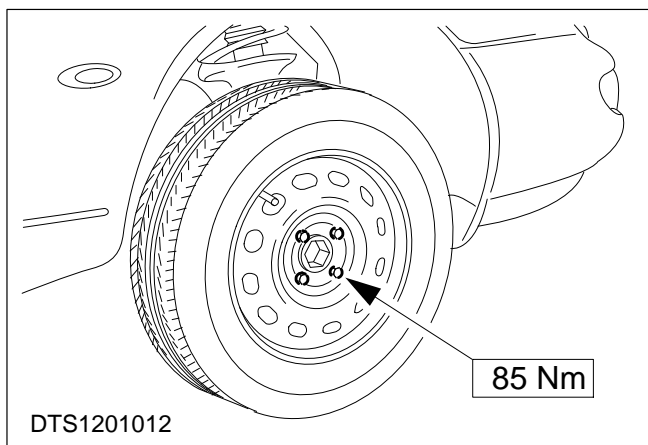

9. Remove the wheel nuts, refit the road wheels and lower the vehicle.