

Motor – Traction Control –Remove and Install (12 795 0)

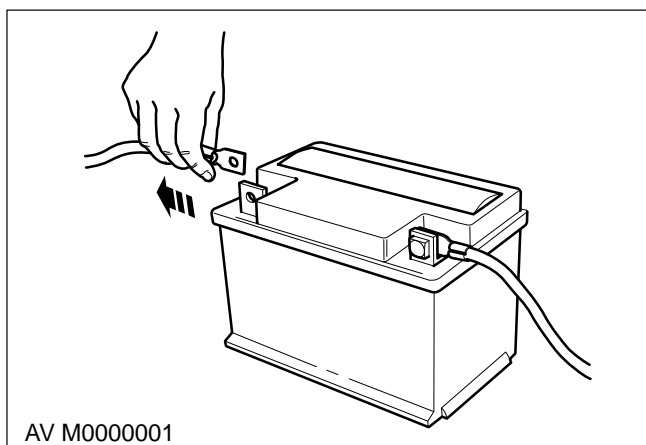

Remove

1. **Disconnect the battery earth lead.**

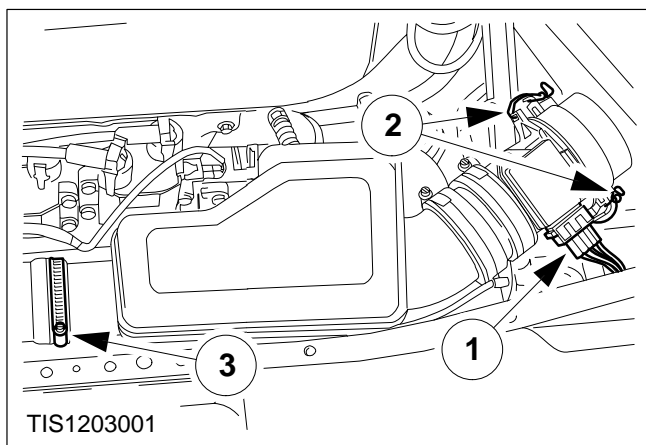

2. **Remove the resonator box and MAF sensor as one assembly.**

- 1 Disconnect the MAF sensor multiplug.
- 2 Unclip the MAF sensor retaining clips.
- 3 Remove the resonator box retaining clip.

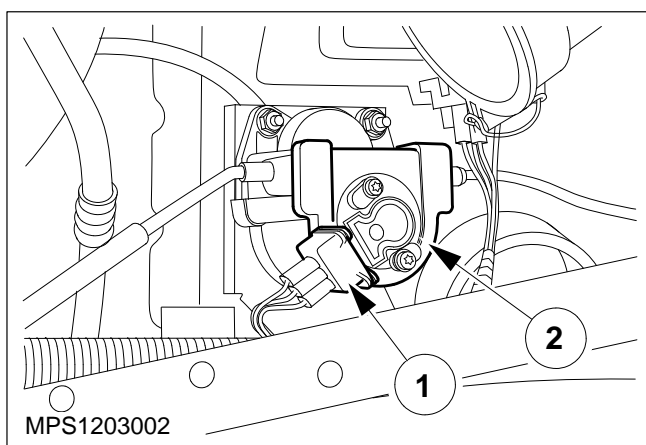

3. **Disconnect the traction control motor multiplug.**

- 1 Disconnect the traction control motor multiplug.
- 2 Remove the motor cover.

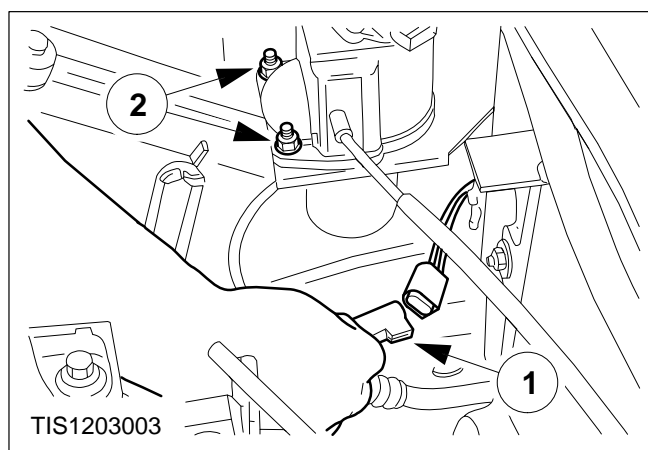

4. Detach the traction control motor.

- 1 Disconnect the motor feed multiplug.
- 2 Remove the traction control motor retaining nuts.

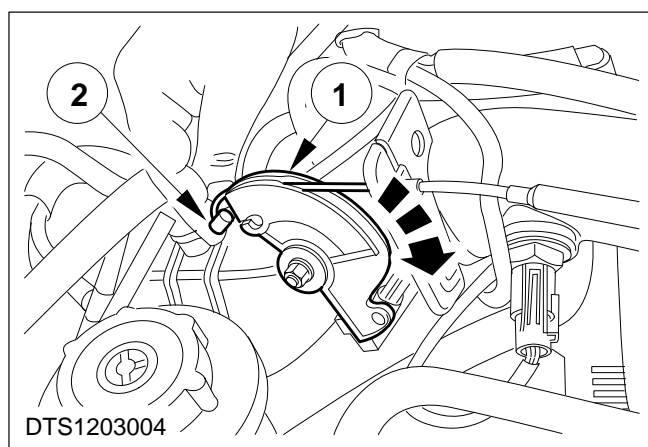

5. Disconnect the throttle cable from the throttle quadrant.

- 1 Rotate the quadrant.
- 2 Disconnect the throttle cable from the quadrant.

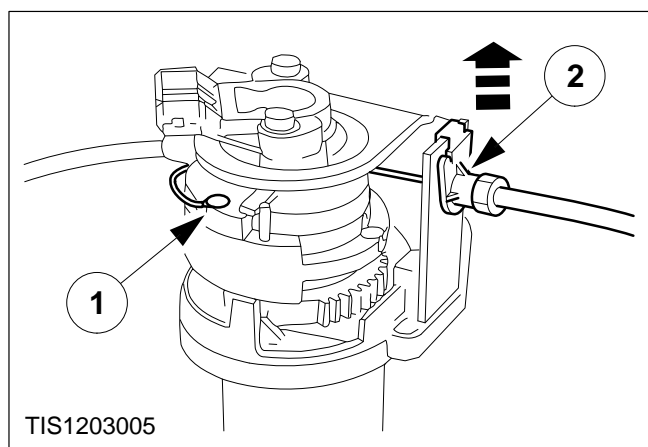

6. Disconnect the throttle cable from the upper motor pulley.

- 1 Disconnect the cable nipple from the pulley.
- 2 Disconnect the cable from the motor housing.

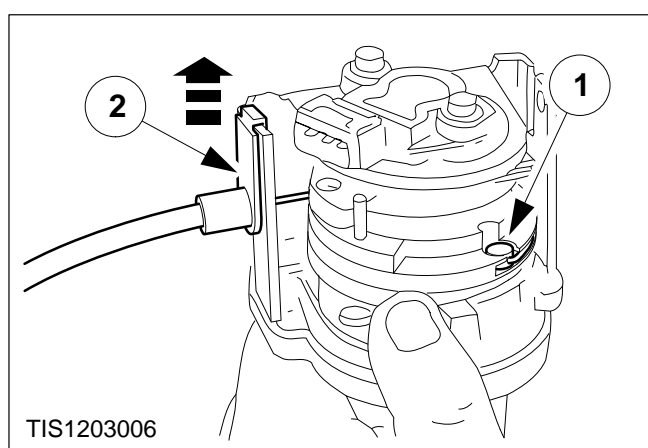

7. Disconnect the throttle cable from the lower motor pulley.

- 1 Disconnect the cable nipple from the pulley.
- 2 Disconnect the cable from the motor housing.

8. Remove the traction control motor.

Install

9. Reconnect the throttle cables to the lower and upper motor pulleys.

10. Reconnect the throttle cables to the motor housing.

11. Refit the motor cover.

12. Reconnect the throttle cable to the throttle quadrant.

13. Refit the traction control motor.

1 Refit the traction control motor retaining nuts.

2 Reconnect the motor feed multiplug.

14. Reconnect the traction control motor multiplug.

15. Refit the resonator box and MAF sensor as one assembly.

16. Reconnect the battery earth lead.

