

## Sensor – Heated Oxygen (Pre-Catalyst) (DOHC Variants) – Remove and Install (29 200 0)

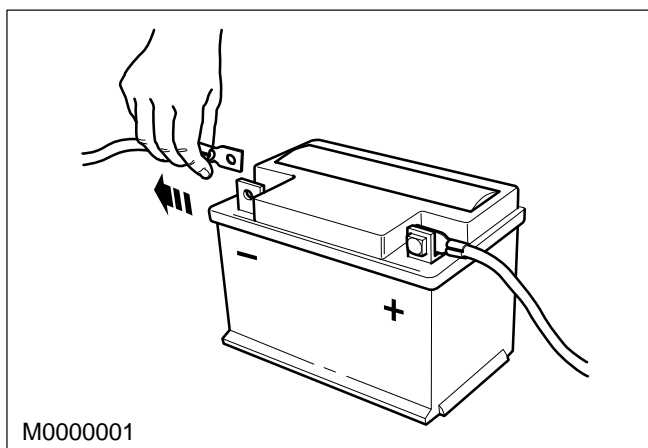

### Remove

1. Disconnect the battery earth lead.

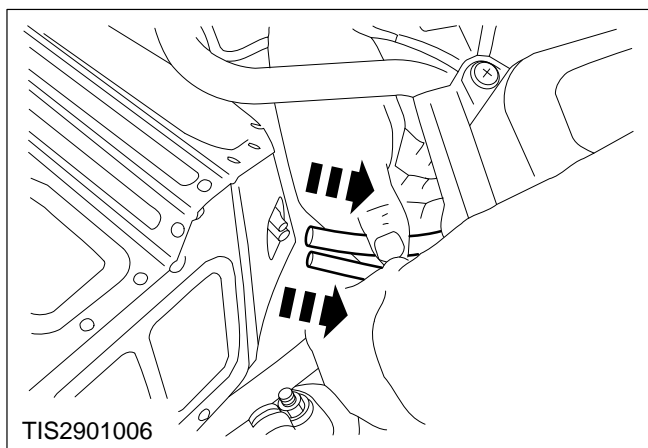

2. Disconnect the Pressure transducer EGR system hoses.

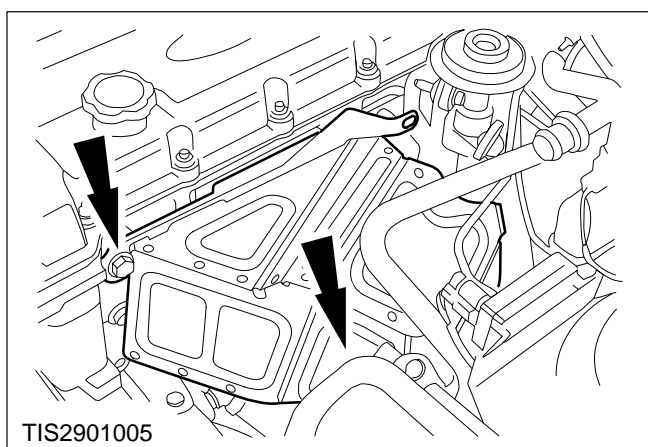

**⚠ WARNING:** The exhaust manifold and heatshield may be hot.

3. Unscrew the bolts and remove the heatshield.

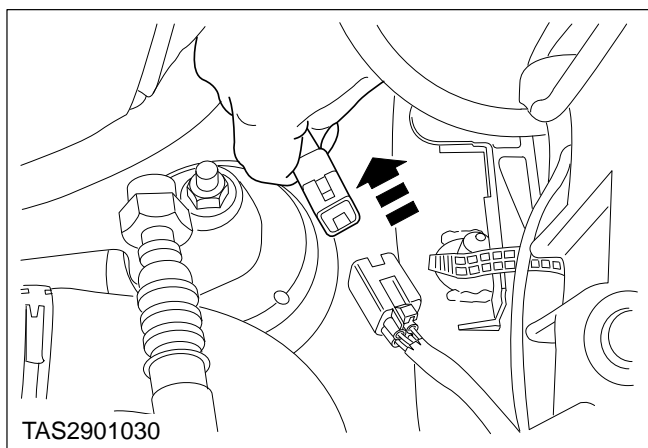

**⚠ CAUTION:** Do not pull on the wiring; pull on the multiplug body.

**4. Disconnect the HO2S multiplug.**

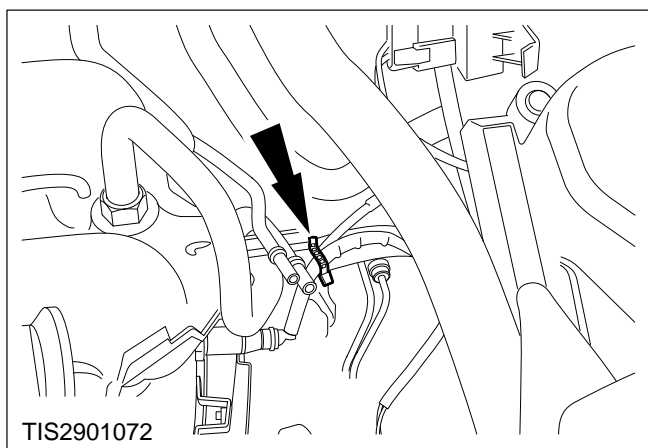

**5. Carefully cut the HO2S loom tie.**

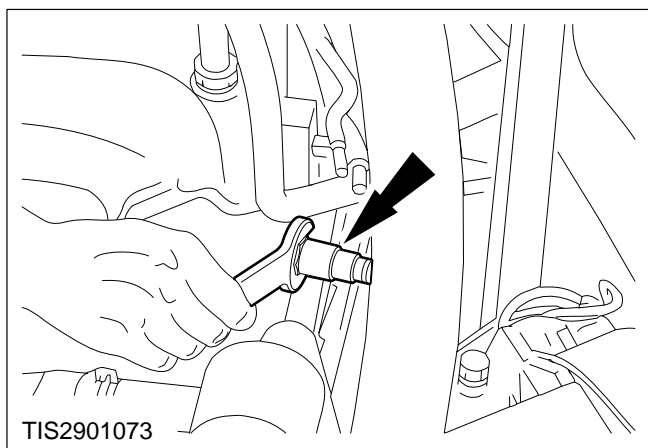

**6. Unscrew the HO2S.**

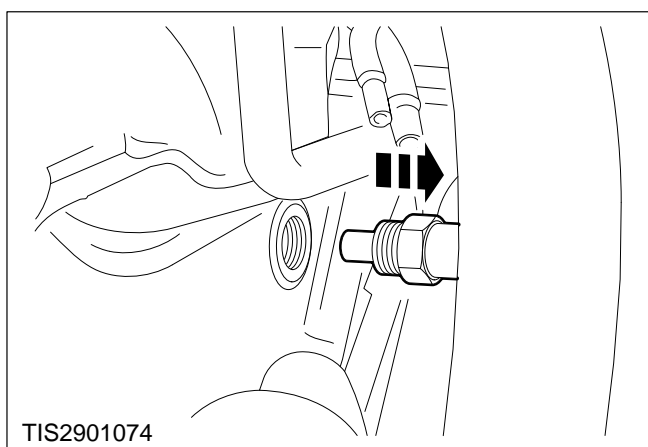

**7. Remove the HO2S.**

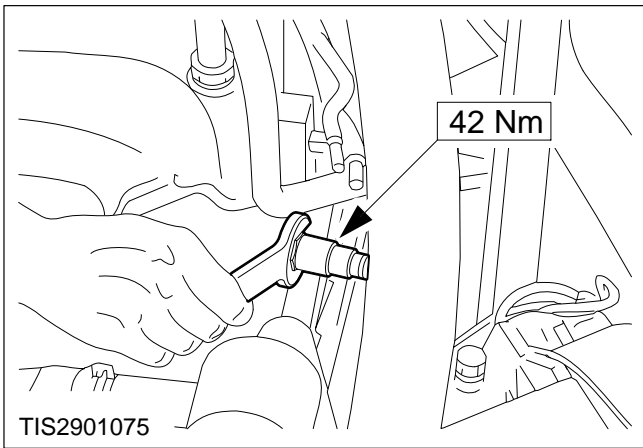

## Install

8. Refit the components in reverse order.