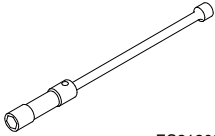

Compression – Engine Hot – Check (21 111 0)

Special Tools

 <p>ES21202</p>	<p>21-202 Socket, spark plugs</p>
--	--

Materials

<p>Lubricant 'Never Seeze'</p>	<p>ESE-M1244-A</p>
------------------------------------	--------------------

Proprietary Tools

<p>Motometer compression pressure recorder no. 623.000.1101</p>
<p>Connector for Motometer compression pressure recorder no. 622.004.1005</p>

NOTE: Check the compression pressure at operating temperature.

1. General note.

Measurement of the actual compression pressure depends on a number of factors and can only be carried out when certain conditions apply.

2. Disconnect the fuel pump relay (R17) in the auxiliary fuse box.

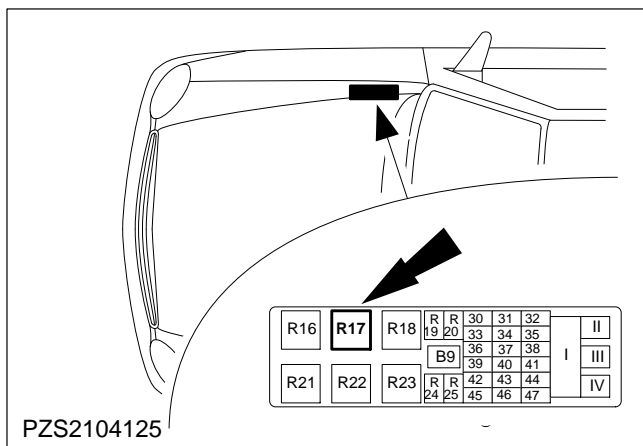

3. Disconnect the valve with the crankcase breather hose.

4. Remove the ignition coil cover.

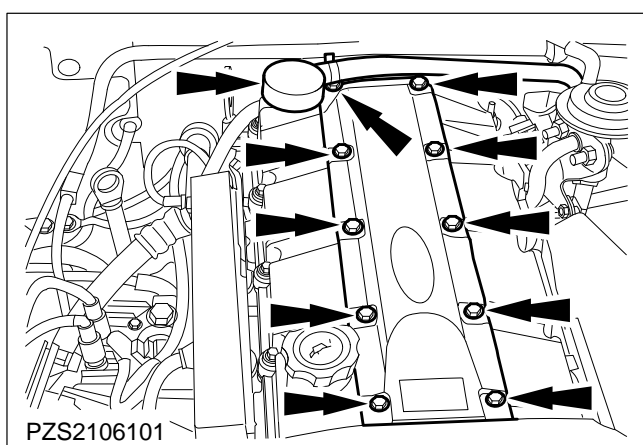

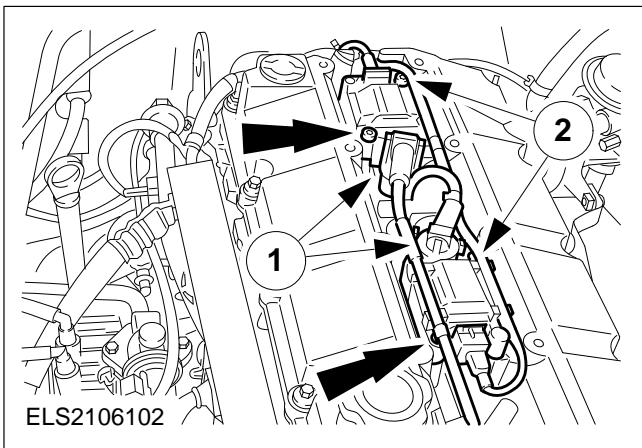

5. Disconnect the spark plug connectors and remove the ignition coils.

- 1 Spark plug connectors
- 2 Ignition coils.

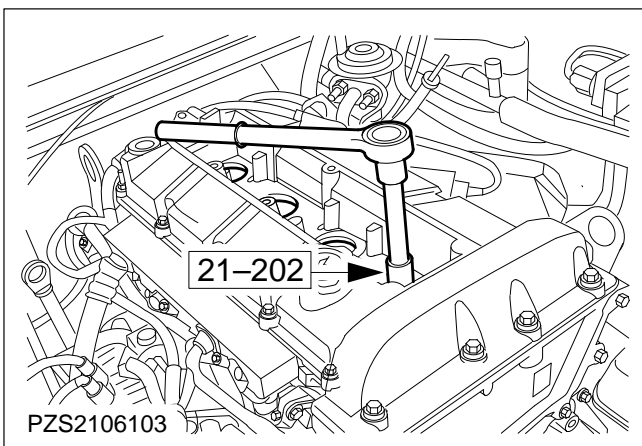

6. Remove the spark plug.

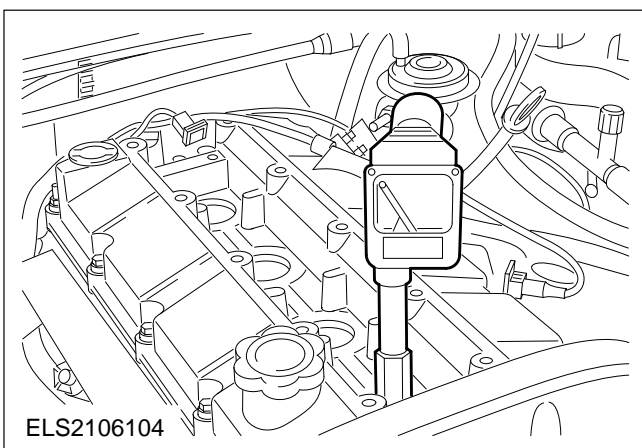

7. Measure the compression pressure.

- Fit the connector and connect the compression pressure recorder.

NOTE: Actuate the starter motor until the needle on the compression pressure recorder does not go up any more.

- Carry out the measurement procedure according to the instructions supplied with the compression pressure recorder.

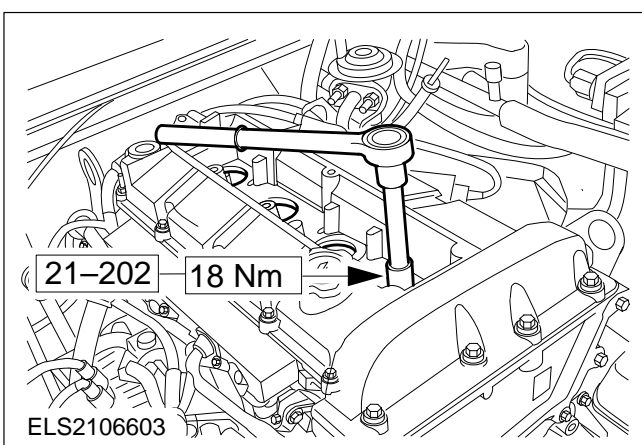

NOTE: Apply lubricant (ESE-M1244-A) to the spark plug thread.

8. Install the spark plug.

9. Repeat the measuring procedure for the other cylinders as described in sub-operations 6. to 8.

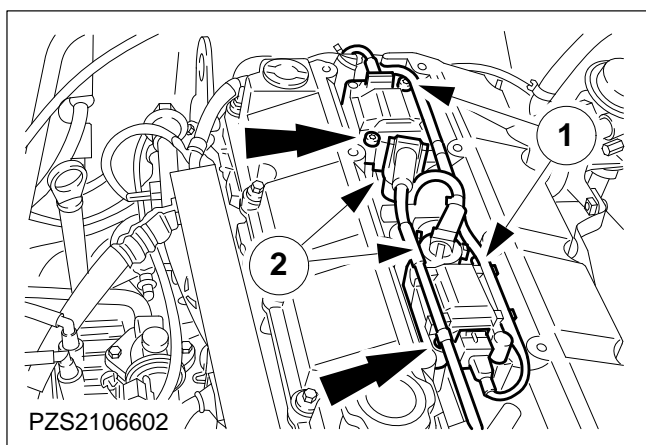

10. Install the ignition coils and connect the spark plug connectors.

- 1 DIS ignition coils
2 Spark plug connectors

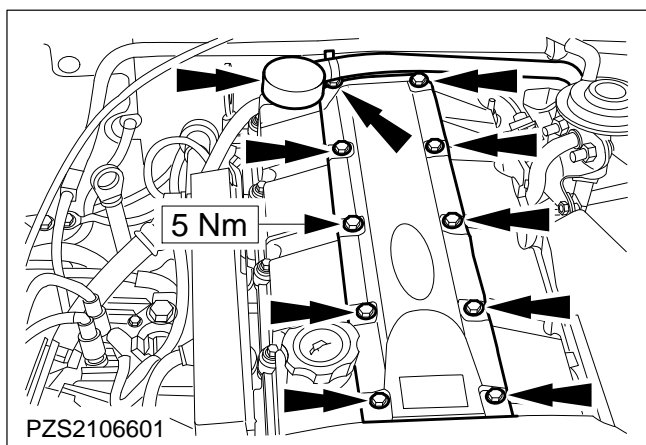

11. Fit the ignition coil cover.

12. Connect the valve with the crankcase breather hose.

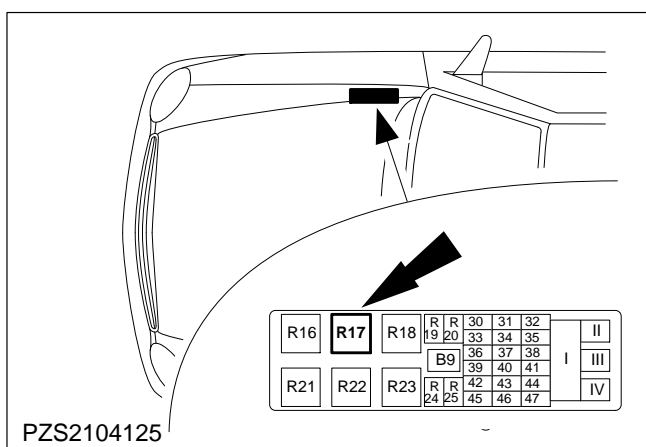

13. Connect the fuel pump relay in the auxiliary fuse box.

14. Clear the fault code in the PCM (EEC V) with FDS 2000.