

Description and Operation

Engine wiring harness

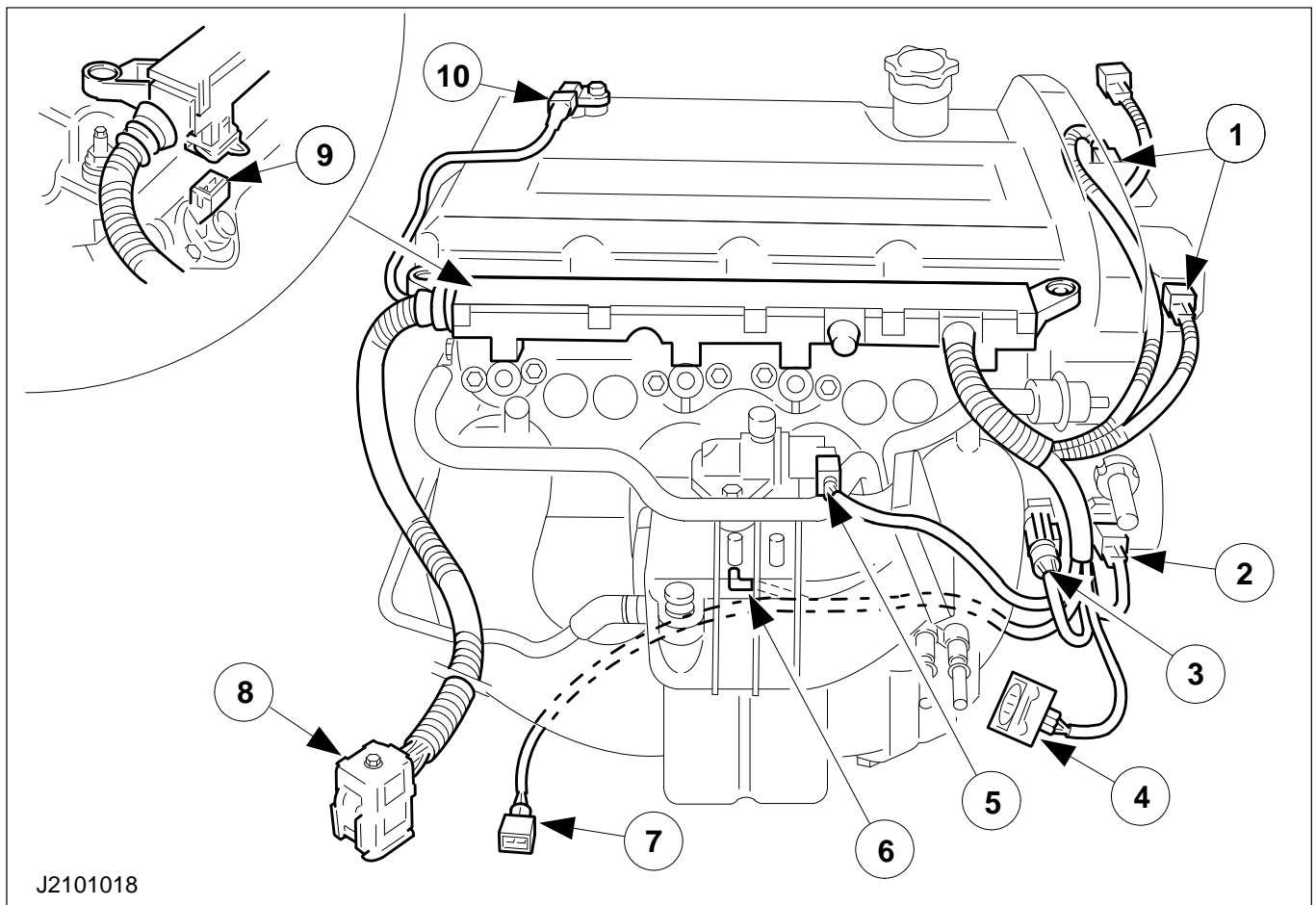

Item	Description
1	DIS ignition coils
2	Coolant temperature sender unit
3	Engine coolant temperature (ECT) sensor
4	Throttle position sensor (TPS)

5	Idle air control (IAC) valve
6	Oil pressure switch
7	Crankshaft position sensor (CPS)
8	Central connector
9	Injectors
10	Camshaft position sensor (CID)

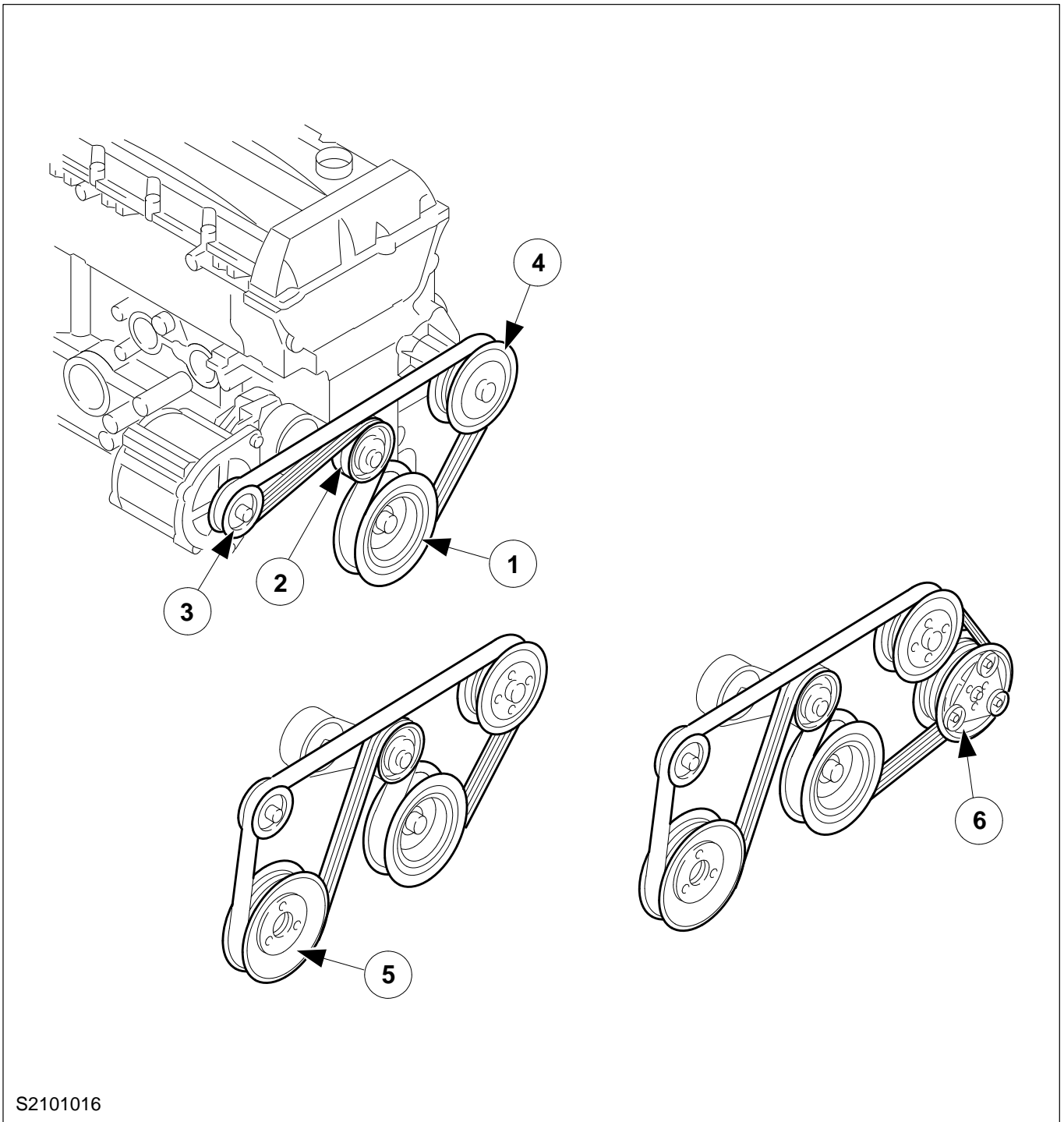

Item	Description
1	Crankshaft belt pulley
2	Automatic belt tensioner
3	Alternator
4	Water pump

5	Power steering pump
6	Air conditioning compressor

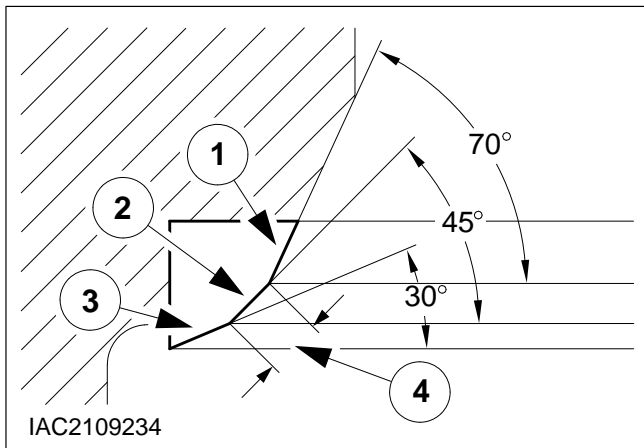

Locations of the angles on the valve seat.

1. Locations of the angles on the valve seat.

- 1 Upper correction angle
- 2 Valve seat angle
- 3 Lower correction angle
- 4 Valve seat width

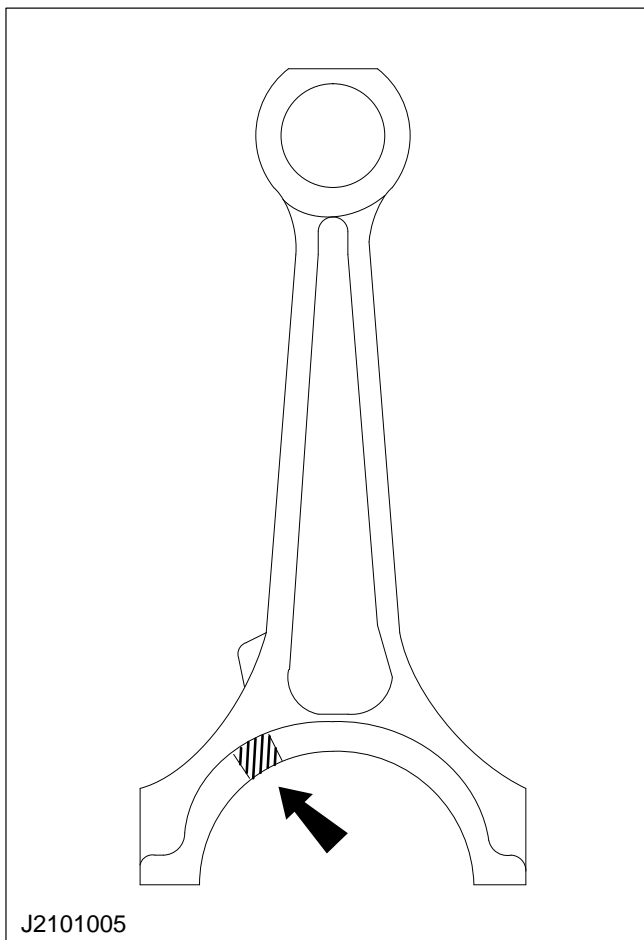

Revised parts from '95 MY onwards

2. Connecting rods

- In place of the existing oil splash bore, there is now a recess on each side of the connecting rod.
- This recess conveys the oil from the bearing shells to the cylinder bore.
- This provides additional lubrication on the pressurised side of the cylinder bore.
- New connecting rod bolts marked "KX120" on the head.

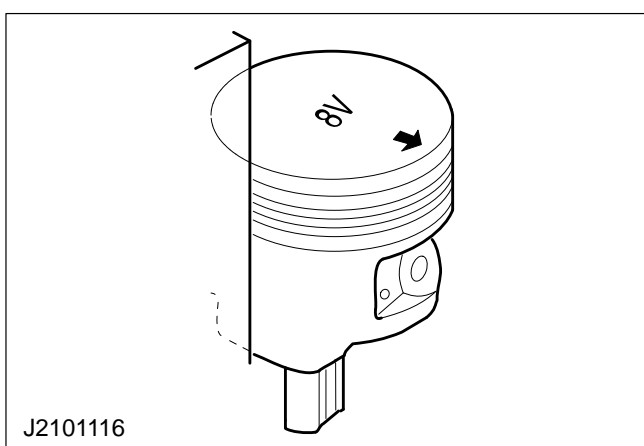

NOTE: Coated pistons do not have valve cut-outs in the piston crown (from build month 05/97).

3. Pistons

- The distance from the piston crown to the first piston ring has been reduced to 5 mm.
- The piston rings are phosphated.
- The tolerances have been reduced.

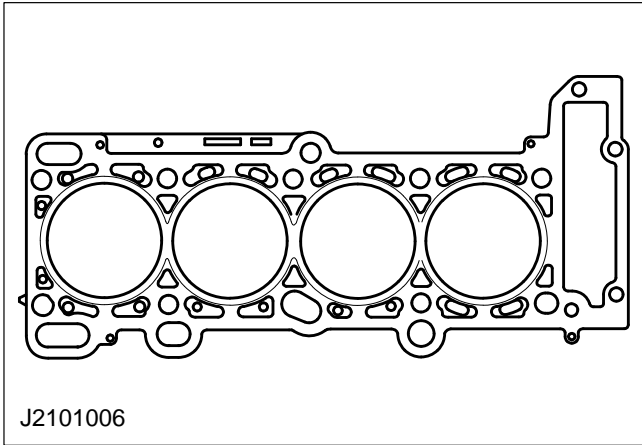

4. Cylinder head gasket.

With effect from the '95 model year, a multi-layered steel gasket is used.

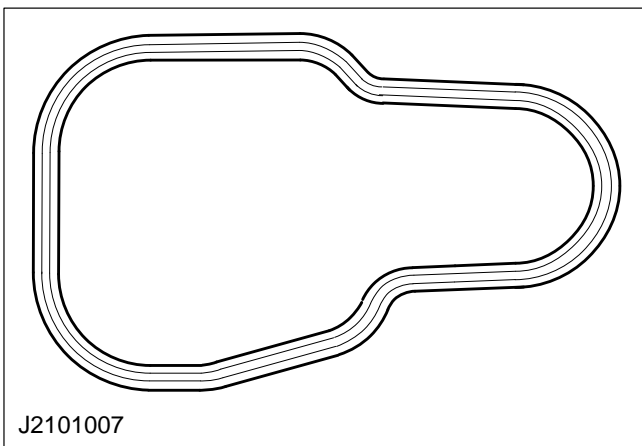

5. Inlet manifold gasket.

- Four Viton gaskets arranged in the inlet manifold.
- The four gaskets are not symmetrical.

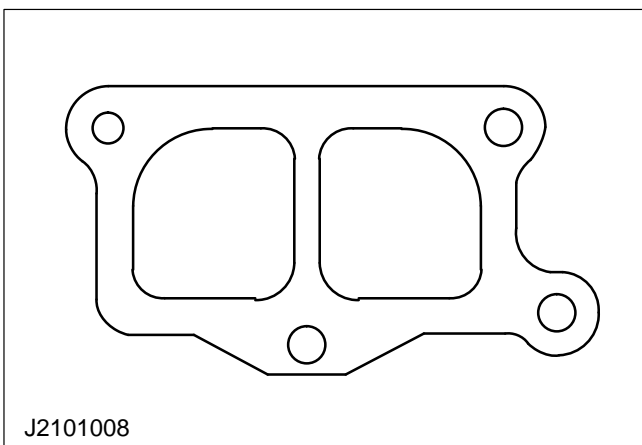

6. Exhaust manifold gasket.

- A two layered steel gasket is used in production from '95 MY onwards.
- Two gaskets per engine.

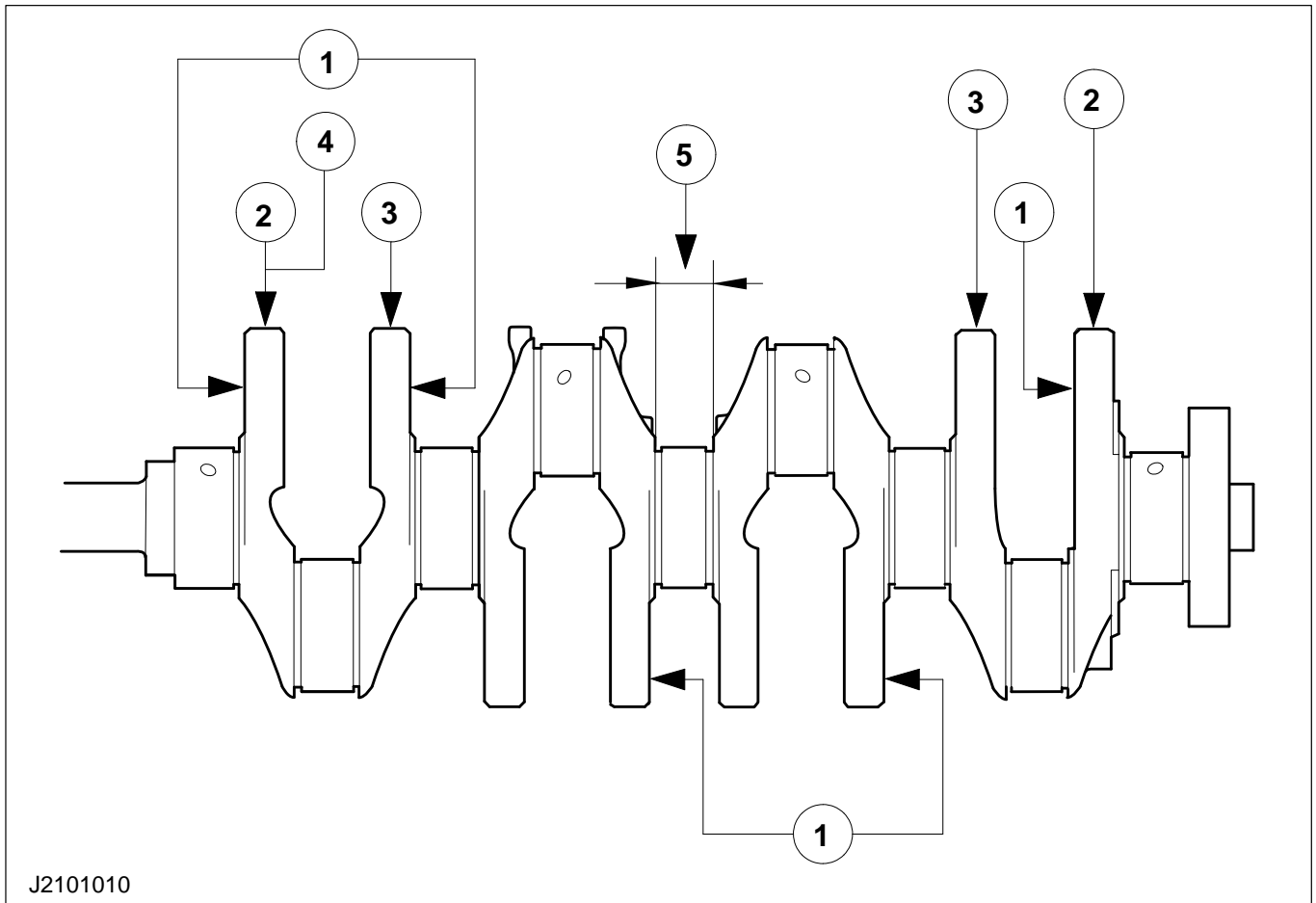

Item	Description
1	Yellow line for standard size (\varnothing 54,99 - 54,98) main bearing journals.
1	Red line for standard size (\varnothing 55,00 - 54,99) main bearing journals.
2	Green line for production undersize (0,25) main bearing journals.
3	Green line for production undersize (0,25) main bearing journals.
4	Yellow line for undersize (0,38) centre main bearing journal width.
5	Centre main bearing journal width.