

## Cable – Accelerator (Diesel Variants) – Remove and Install (23 826 0)

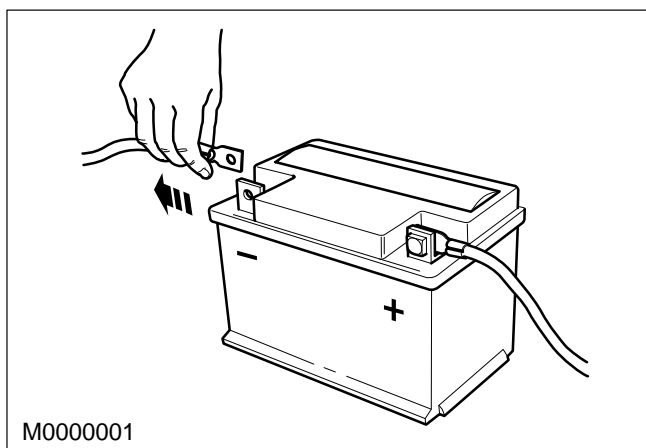

Remove

1. Disconnect the battery earth lead.

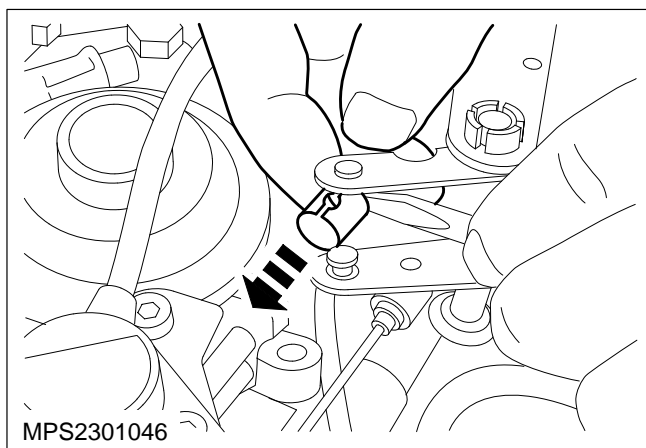

2. Remove the inner cable retaining clip.

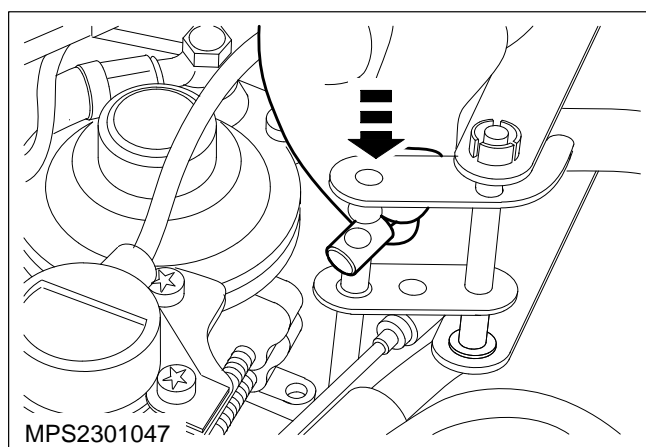

3. Disconnect the inner cable from the injection pump mechanism.

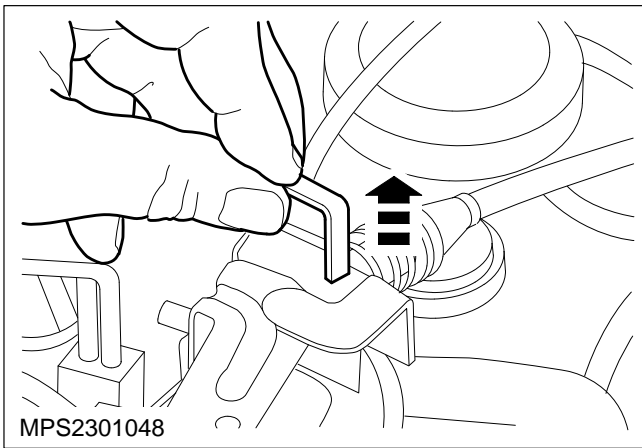

**4. Remove the outer cable retaining clip.**

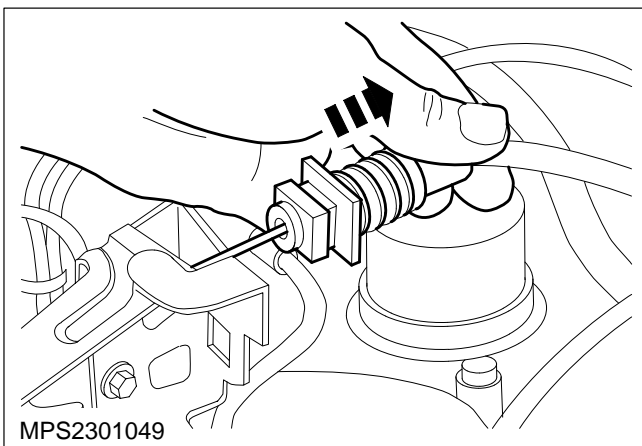

**5. Disconnect the outer cable from the bracket.**

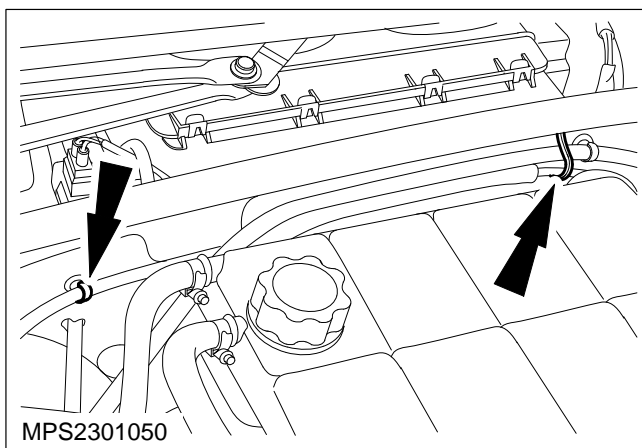

**6. Cut the cable ties which secure the outer cable to the bulkhead.**

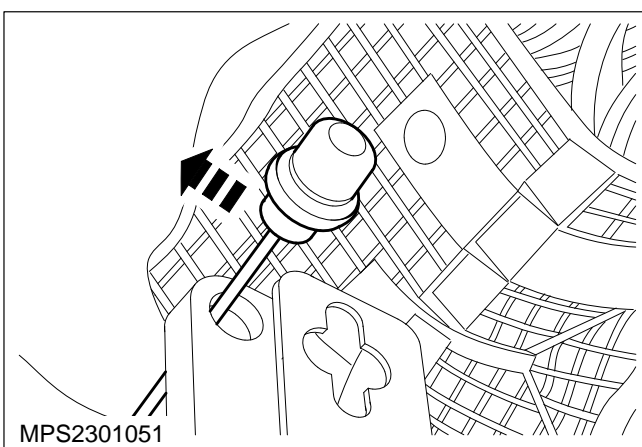

**7. Unclip the inner cable from the accelerator pedal.**

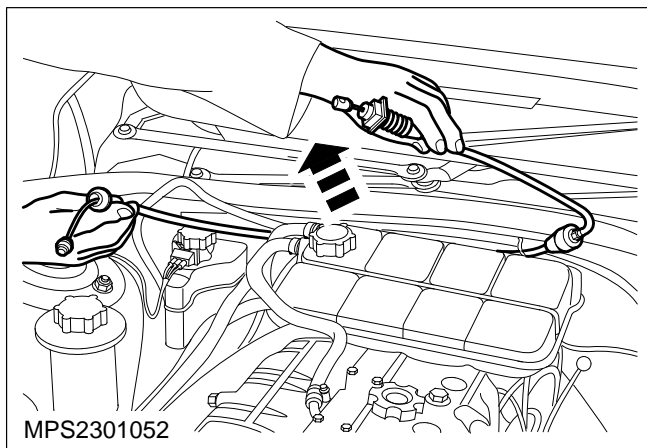

**8. Remove the accelerator cable.**

Install

**9. Refit the components in reverse order.**

**10. Adjust the accelerator cable (refer to Operation No. 23 811 0).**