

Air Cleaner Assembly (Diesel Variants 97¼ MY onwards) – Remove And Install (23 174 0)

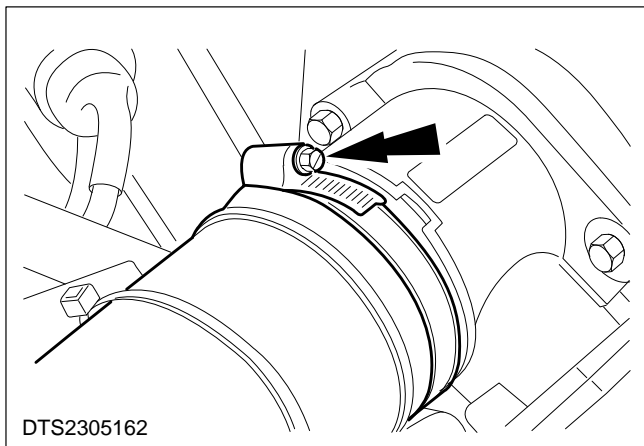

Remove

1. Disconnect the air cleaner outlet tube from the mass air flow sensor.

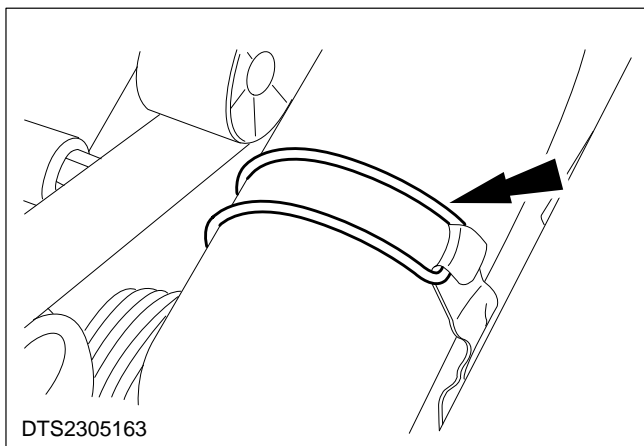

2. Remove the air cleaner outlet tube retaining band.

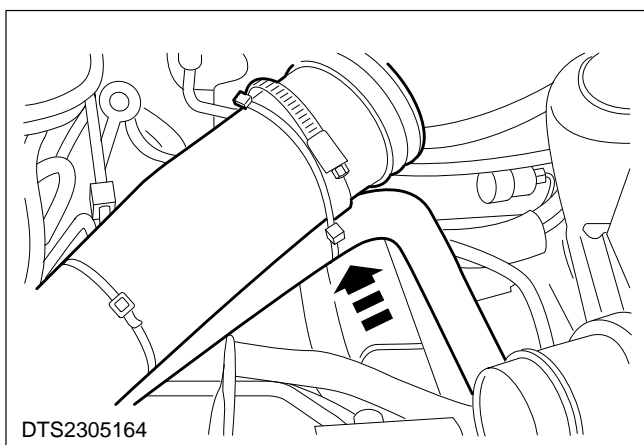

3. Position the air cleaner outlet tube to one side.

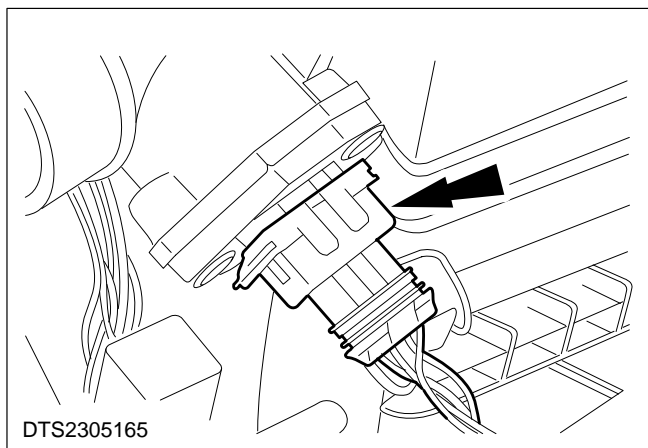

4. Disconnect the mass air flow sensor electrical connector.

5. Raise and support the vehicle.

6. Remove the road wheel.

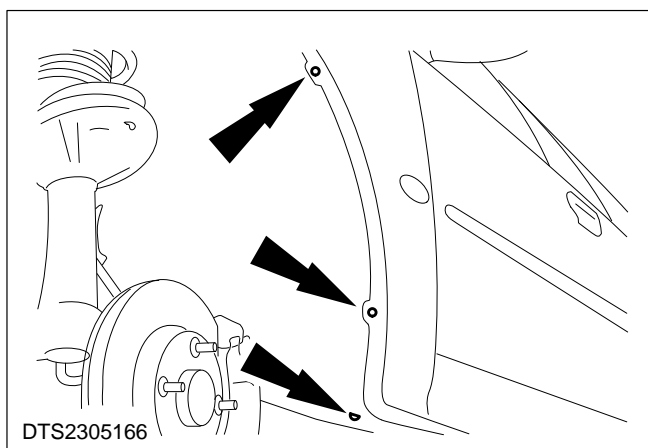

7. Remove the front fender splash shield.

- Remove the three rear retainers.

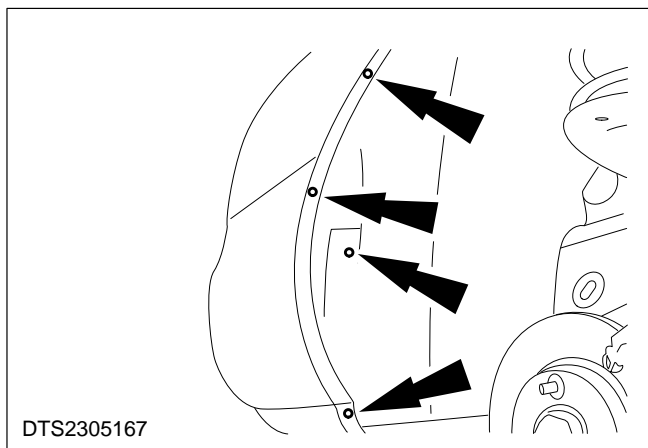

8. Remove the front fender splash shield (continued).

- Remove the four front retainers.

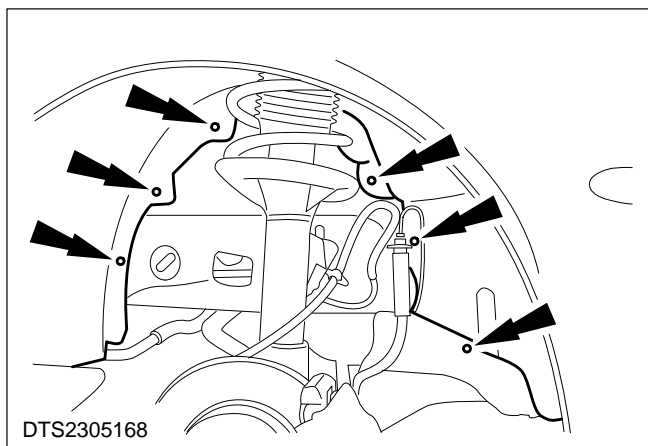

9. Remove the front fender splash shield (continued).

- Remove the six inner retainers.

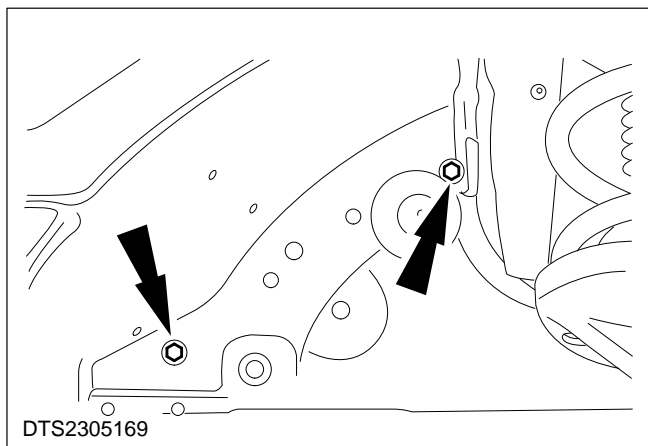

10. Remove the air cleaner retaining nuts.

11. Lower the vehicle.

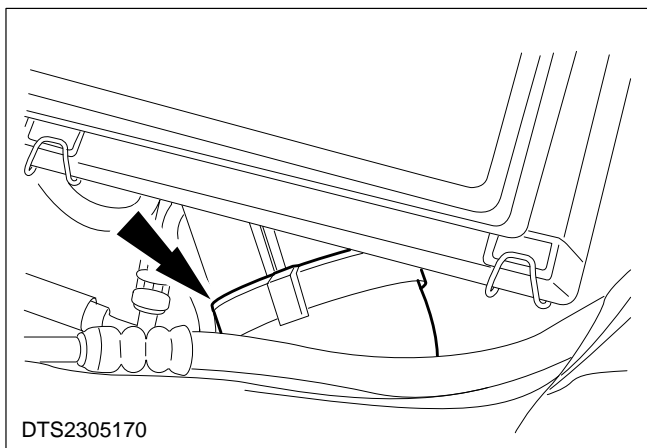

12. Disconnect the air cleaner inlet tube.

13. Remove the air cleaner.

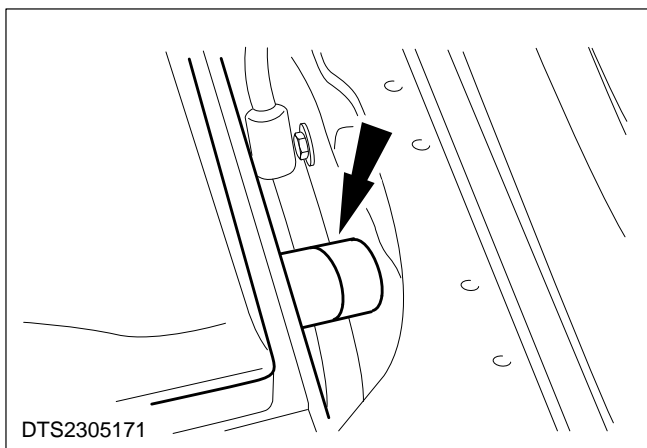

Install

NOTE: Make sure that the air cleaner locating peg fits correctly in the locating hole inner fender.

14. To install, reverse the removal procedure.