

Clutch Master Cylinder – Remove and Install (16 856 0)

Materials

Brake fluid (Super Dot 4)	ESD-M6C57-A
------------------------------	-------------

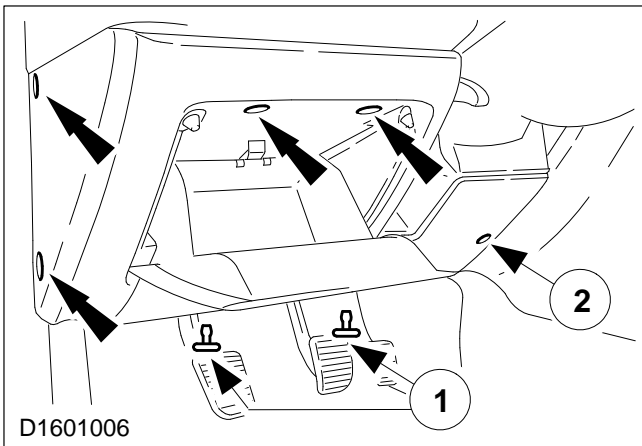

Remove

1. Remove the upper footwell trim cover.

- 1 Remove the footwell trim cover clips.
- 2 Undo the screws (five off) and remove the trim cover.

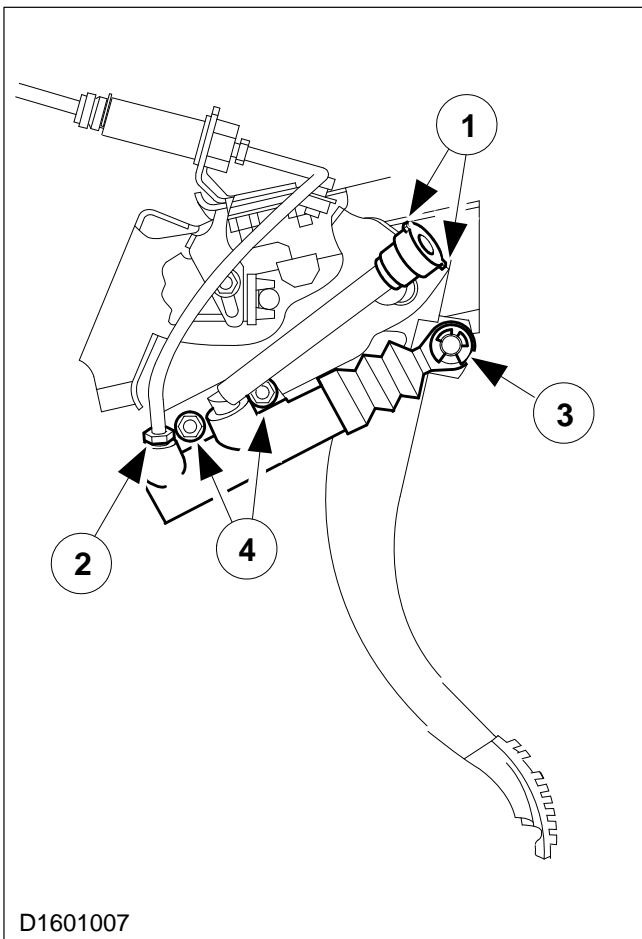

⚠ CAUTION: Brake fluid will escape when the lines are disconnected.

2. Disconnect the lines from the master cylinder.

- 1 Press in the lugs and disconnect the quick-release coupling of the supply line.
- 2 Detach the pressure line
- 3 Pull the retaining clip off the clutch pedal.
- 4 Unscrew the nuts and remove the master cylinder.

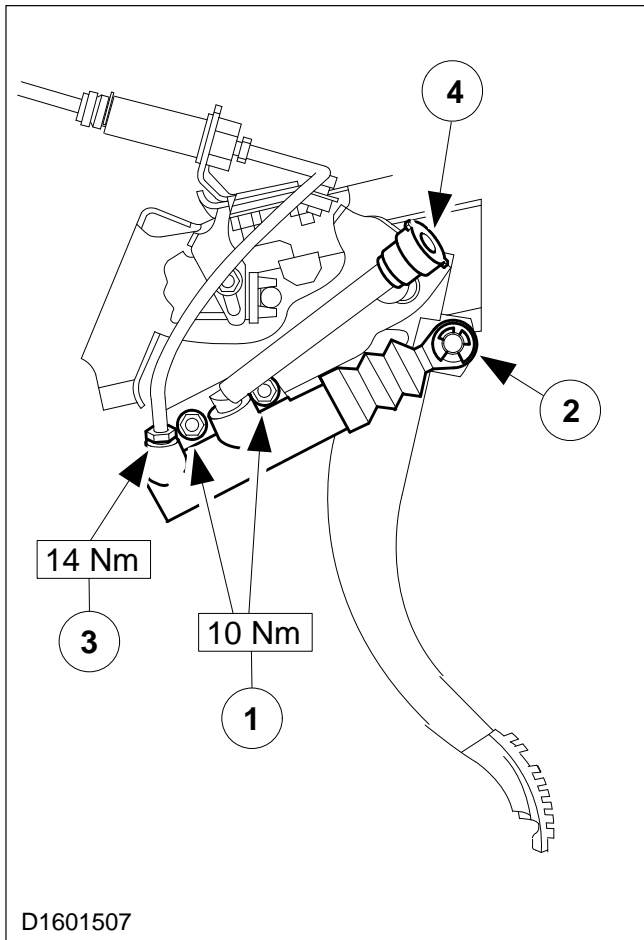

Install

3. Install the master cylinder.

- 1 Fit the master cylinder and tighten the nuts.
- 2 Fit the retaining clip to the clutch pedal.
- 3 Connect the pressure line to the master cylinder.
- 4 Connect the supply line to the quick-release coupling.

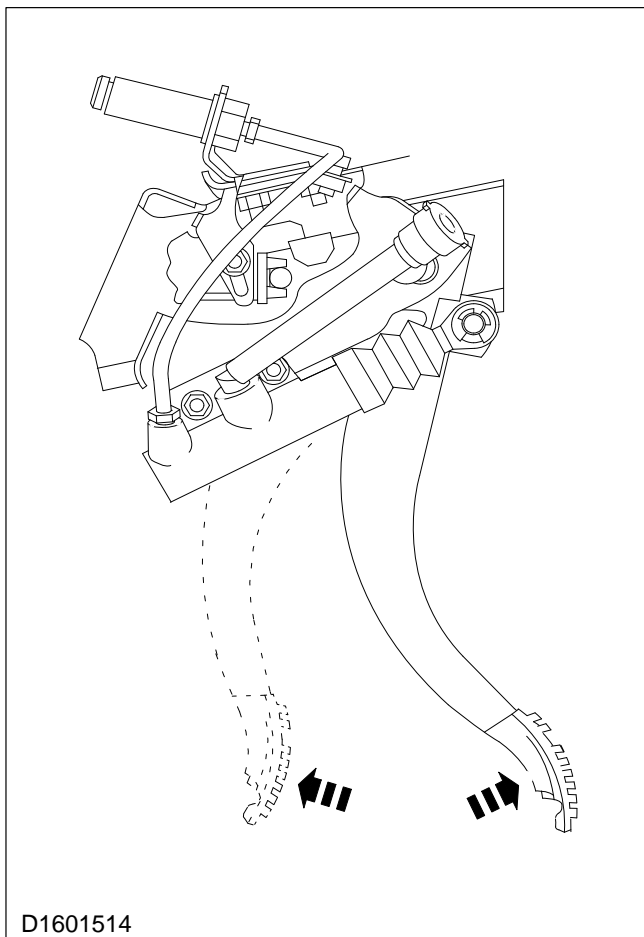

NOTE: The pedal travel must be limited by the master cylinder and not by switches or insulating matting.

4. Measure the clutch pedal travel.

Check the upper and lower stops.

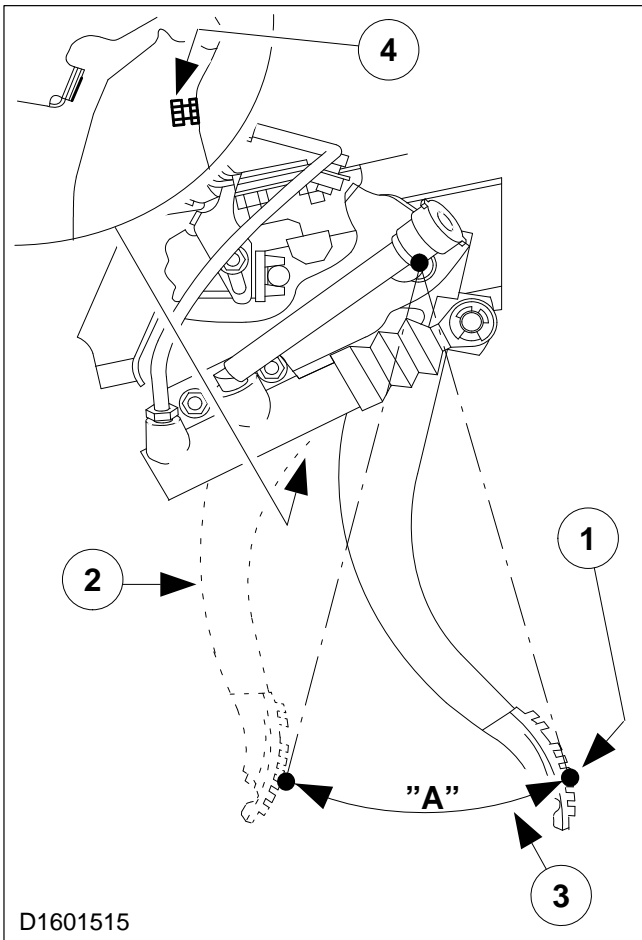

Excepting 2,3 DOHC 16V variants built from May '96 (build code TC) to May '97 (build code VB).

5. Measure the clutch pedal travel (continued).

- 1 The measurement reference point is the third groove (from the bottom) in the pedal rubber.
- 2 Depress the pedal as far as the stop.
- 3 Release the pedal and measure dimension "A". Dimension "A" = $140 \pm 3\text{mm}$.
- 4 Set dimension "A" with the pedal stop screw.

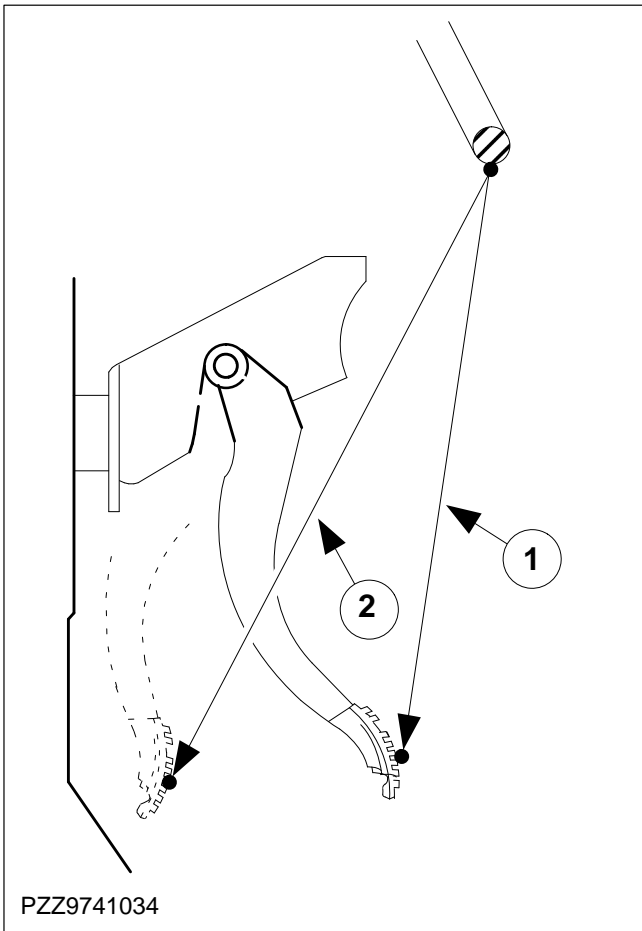

Only for 2,3 DOHC 16V variants built from May '96 (build code TC) to May '97 (build code VB).

NOTE: From June '97 onwards (build code VR) the adjusting screw on the pedal mounting is set in production at the maximum pedal travel.

6. Measure the clutch pedal travel (continued).

- Adjust the height of the steering wheel to the lowest position.

NOTE: The pedal travel must not be restricted by insulating matting.

NOTE: The measurement reference point is the third groove (from the bottom) in the pedal rubber.

- 1 Measure and record the distance between the bottom edge of the steering wheel and the clutch pedal.
- 2 Depress the clutch pedal as far as the stop, then measure and record the distance between the bottom edge of the steering wheel and the clutch pedal.

The difference between the first and second measurements must be 135 mm ± 5mm.

NOTE: To achieve the maximum pedal travel screw in the adjusting screw.

- If the recorded measurement exceeds the tolerance, adjust the pedal stop screw.
- Repeat the measurement.

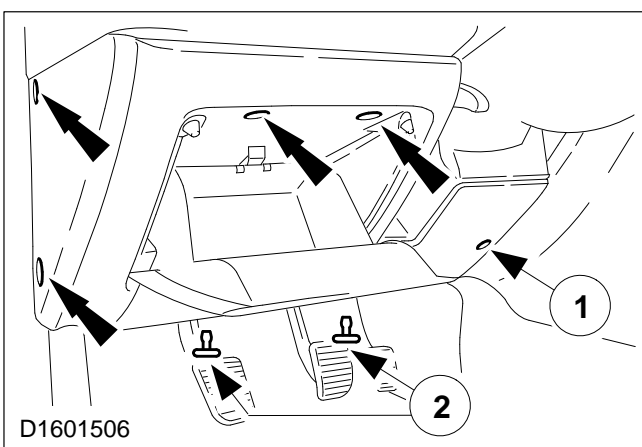

7. Fit the upper footwell trim panel.

- 1 Fit the trim panel and secure it with the screws (five off).
- 2 Fit the footwell trim panel clips.

8. Bleed the hydraulic system as described in Operation No. 16 843 0.