

Steering Wheel – Centralise (13 523 0)

NOTE: This procedure details adjustments where misalignment of the steering wheel is less than 30°. For steering wheel misalignments of more than 30°, remove the steering wheel and initially re-align to less than 30° misalignment.

1. Drive the vehicle in a straight line on a level road surface, note the angular position (misalignment) of the steering wheel spokes.

2. Raise the vehicle.

3. Mark the position of the track rods and track rod ends.

4. Slacken the track rod end lock nuts.

- 1 Slacken the track rod end locknuts.
- 2 Release the bellows outer clips.

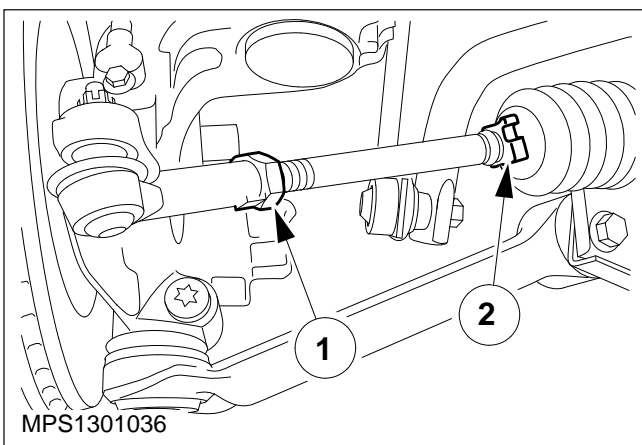
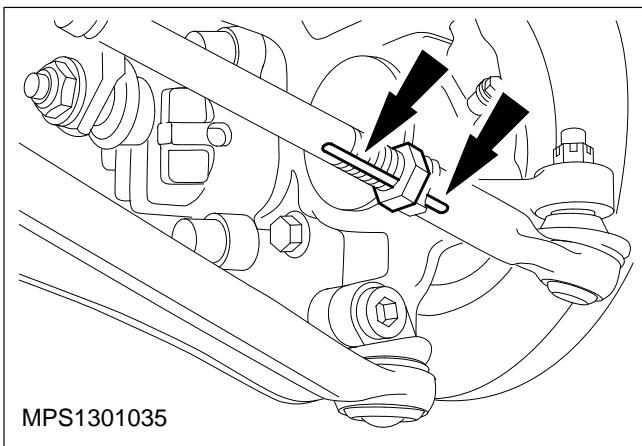
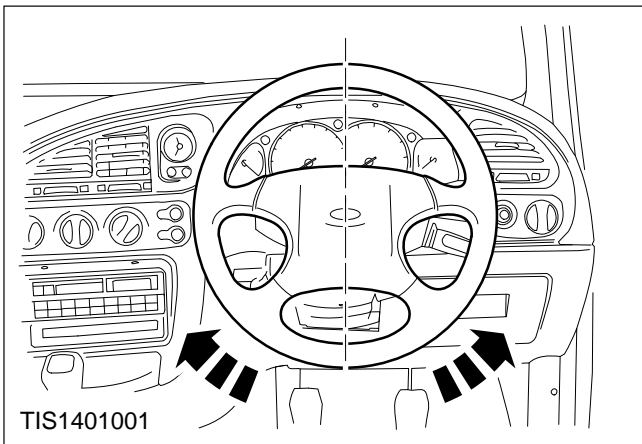

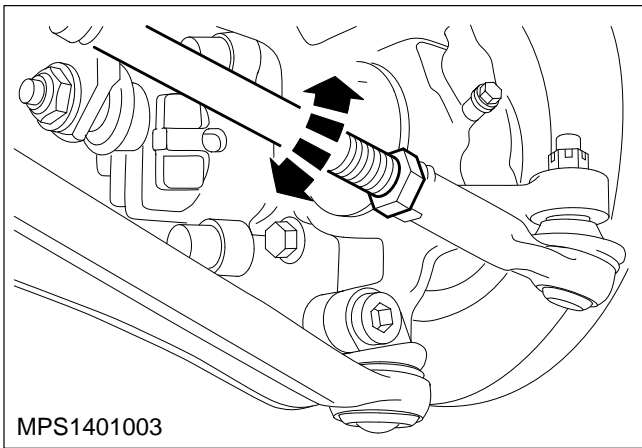

5. **Rotate both the track rods in the same direction approximately 30° for every 1° of steering wheel misalignment/angular error.**
 - If the steering wheel has an anti-clockwise angular error, both track rods must be rotated clockwise, when viewed from the left hand side of the vehicle.
 - If the steering wheel has a clockwise angular error, both track rods must be rotated anti-clockwise when viewed from the left-hand side of the vehicle.
6. **Check the front wheel alignment (refer to Operation Numbers 14 111 0 and 14 111 3).**

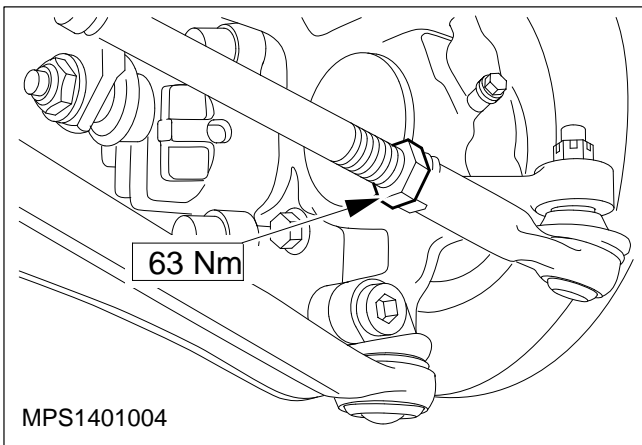

7. **Tighten the track rod end locknuts.**
8. **Secure the bellows with new clips and lower the vehicle.**