

Description and Operation

The power assisted steering gear fitted to the Scorpio '95 is of the conventional rack and pinion type as used on most previous models. The steering gear is mounted to the front crossmember assembly. This type of steering gear may be fitted to either left or right-hand drive variants.

Hydraulic fluid pressure is supplied to the steering gear by a hydraulic pump with a remote reservoir. The reservoir is attached to the suspension leg turret at the upper right-hand corner of the engine compartment.

The steering column is attached, at the lower end, to a flexible coupling by means of a clamp plate and bolt and the flexible coupling, in turn, is attached to the steering gear pinion shaft with a pinch bolt.

The steering column incorporates a well proven multi-position steering lock with a high security 'Tibbe' lock barrel. The steering column assembly is fixed to a dash panel extension with four nuts.

All vehicles have an adjustable reach and height steering column that is operated by a lever on the left-hand side of the column.

Petrol variants incorporate a pressure switch within the system that sends a signal to the engine management system to drop the engine speed when the fluid pressure gets too high.

All variants include a fluid cooler that is mounted in front of the radiator.

The Servotronic power steering system fitted to the Scorpio V6 24V incorporates a module located behind the fuse/relay box and an actuator fitted to the steering gear valve body. The module receives signals from the speed sensor and depending upon the vehicle speed activates the actuator to increase or decrease the fluid pressure to create high or low steering efforts.

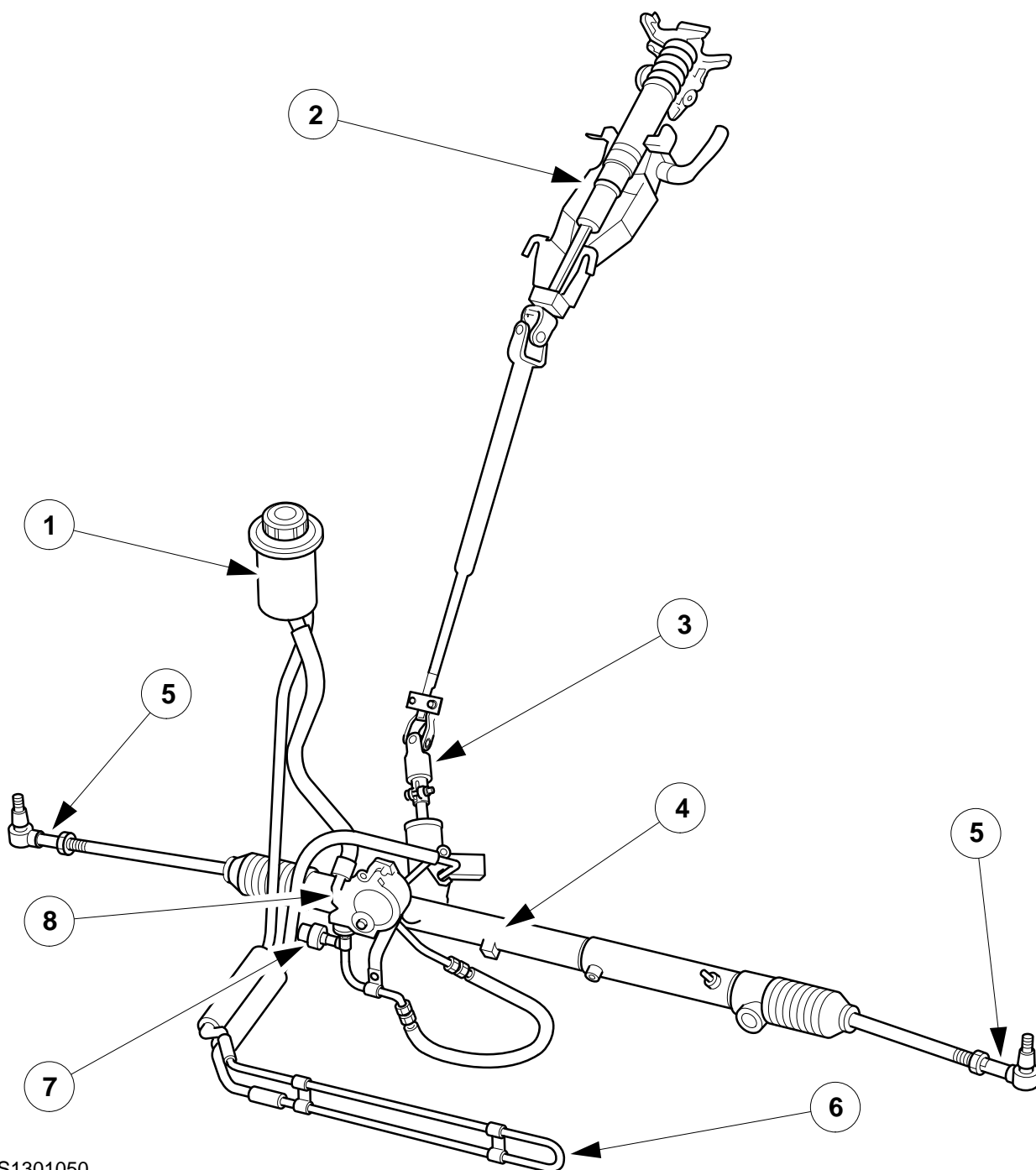

TIS1301050

Item	Description
1	Reservoir
2	Steering column
3	Flexible coupling
4	Steering gear
5	Track rod end
6	Fluid cooler
7	Pressure switch
8	Power steering pump