

## Air Conditioning Evaporator – Remove and Install (34 622 0)

2,9 V6 24V Cosworth only

### Workshop Equipment

Servicing unit	
----------------	--

### Materials

O-rings (green)	
-----------------	--

### Remove

**NOTE:** “Safety Regulations” and “General Requirements and Safety Precautions for Servicing and Repairs” at the beginning of this section.

#### 1. Standard preparatory measures:

- Make a note of the radio keycode.
- Make a note of the preset radio stations.
- Lay protective covers on the fenders.

**⚠ CAUTION:** Disconnect the battery negative lead.

#### 2. Drain the air conditioning system as described in Op. no. 34 620 0.

#### 3. Disconnect the multiplug.

- 1 Idle speed control valve (ISC valve).
- 2 Intake air temperature sensor (IAT sensor).

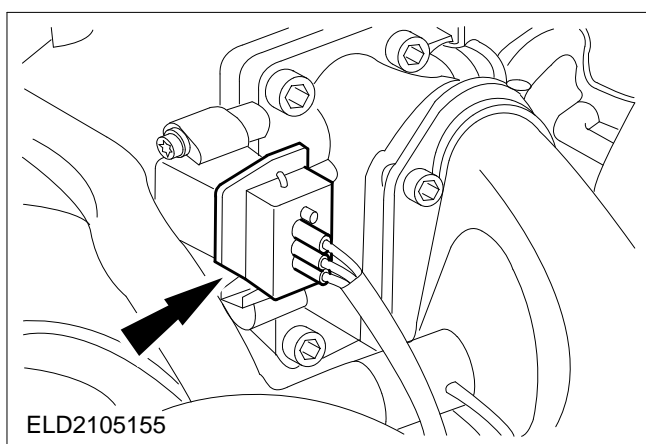
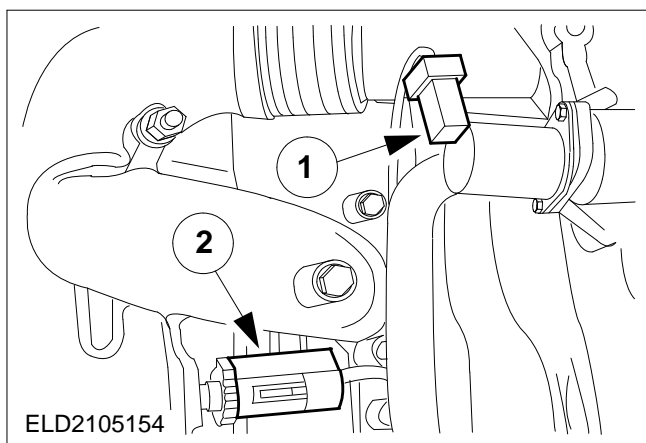

#### 4. Disconnect the multiplug from the throttle position sensor (TP sensor).

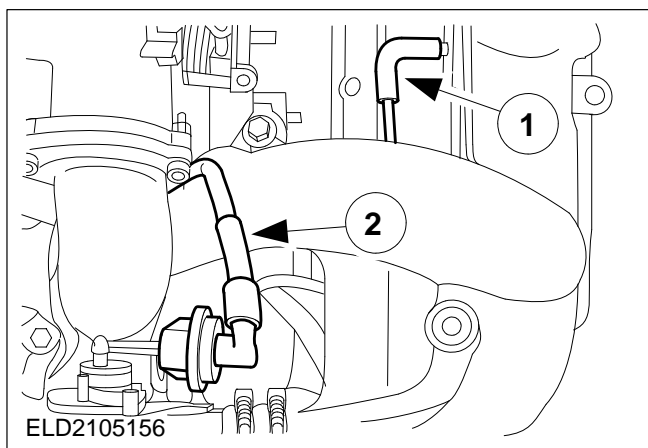

**5. Disconnect the control line and vacuum line.**

- 1 Control line from the plenum section connecting line.
- 2 Vacuum pipe to the fuel pressure control valve.

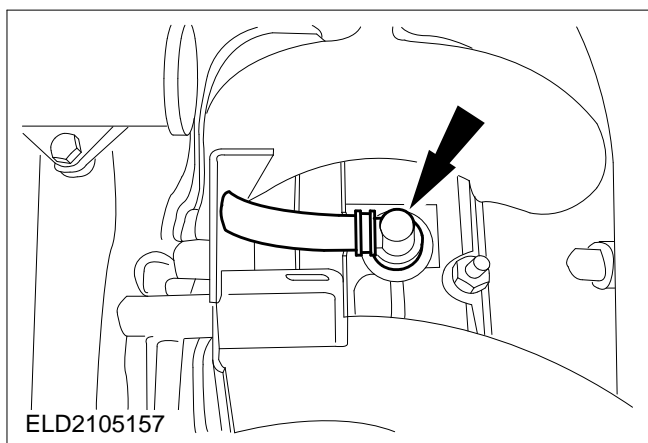

**6. Disconnect the crankcase breather hose.**

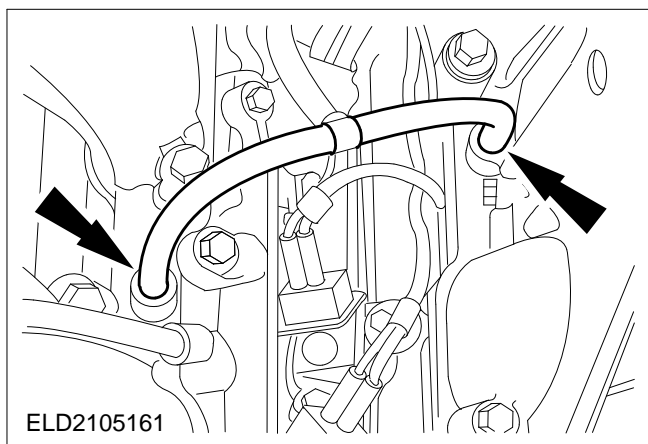

**7. Disconnect the two engine breather vacuum pipes.**

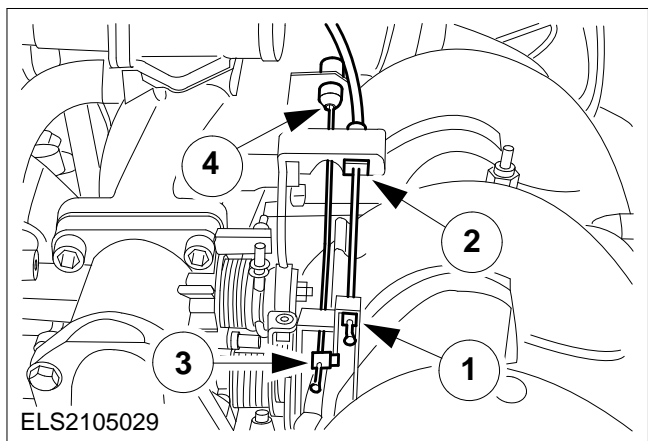

**8. Remove the accelerator cable and the cable of the speed control system.**

- 1 Unhook the accelerator cable.
- 2 Press the rubber retainer out of the bracket.
- 3 Unhook the cable of the speed control system.
- 4 Press the plastic bush off the speed control system cable.

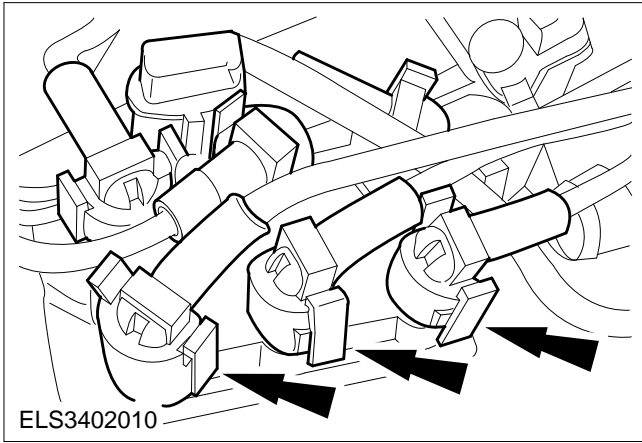

**9. Disconnect the three multiplugs from the EDIS module.**

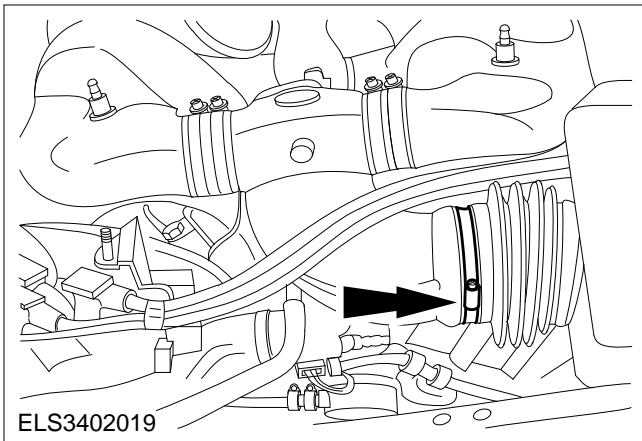

**10. Detach the air intake hose from the air cleaner.**

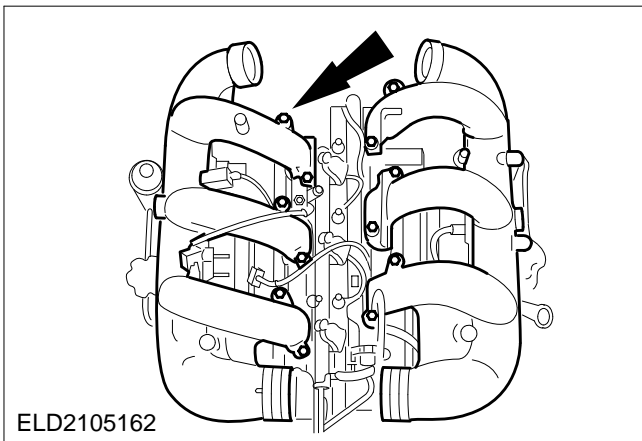

**11. Detach the plenum sections (six bolts on the right, six bolts on the left) (V-shaped connecting pipe removed for clarity).**

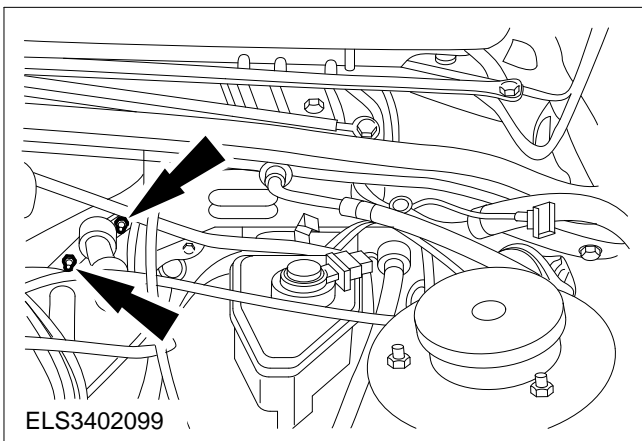

**12. Detach the seal retaining plate.**

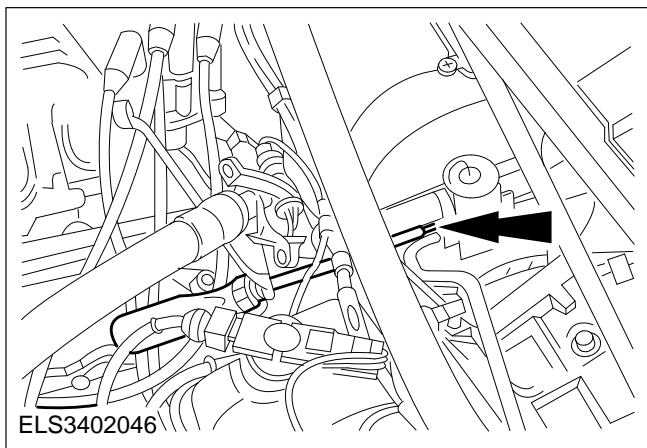

**13. Detach the lines from the expansion valve.**

Remove the O-rings.

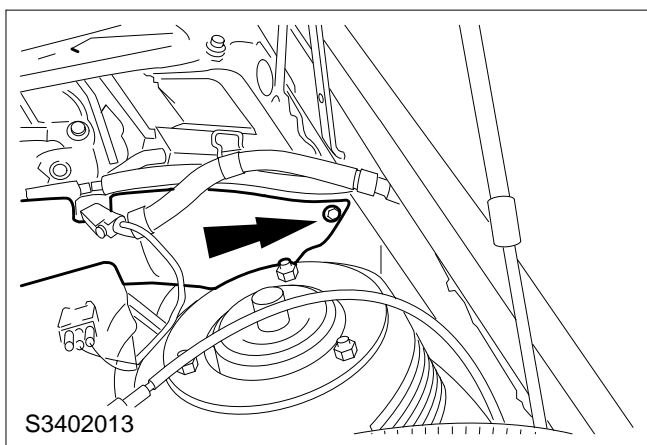

**14. Detach the trim from the bulkhead cover panel.**

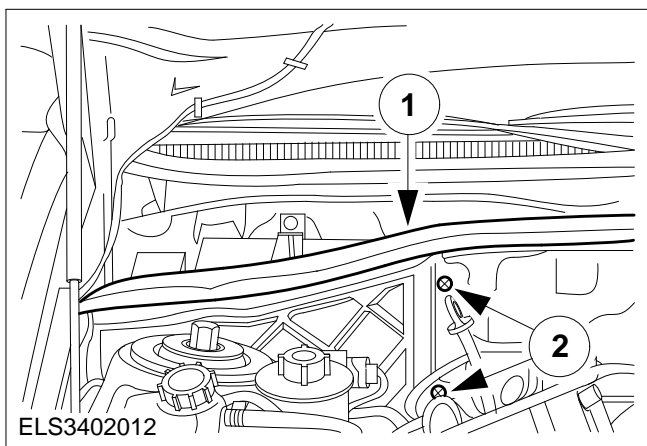

**15. Detach the bulkhead extension from the passenger side.**

- 1 Remove the rubber seal.
- 2 Remove the two bolts.

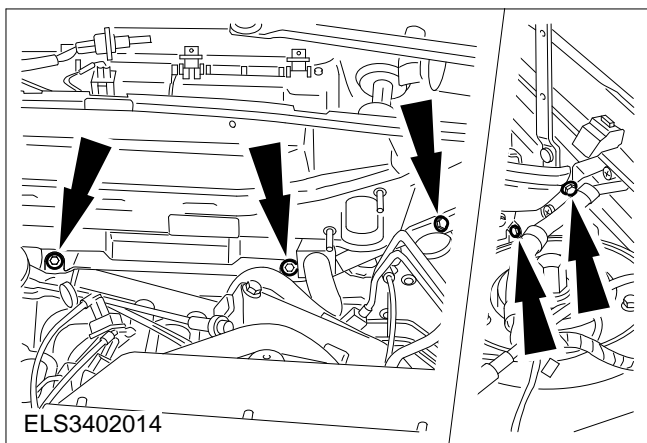

**16. Detach the bulkhead extension.**

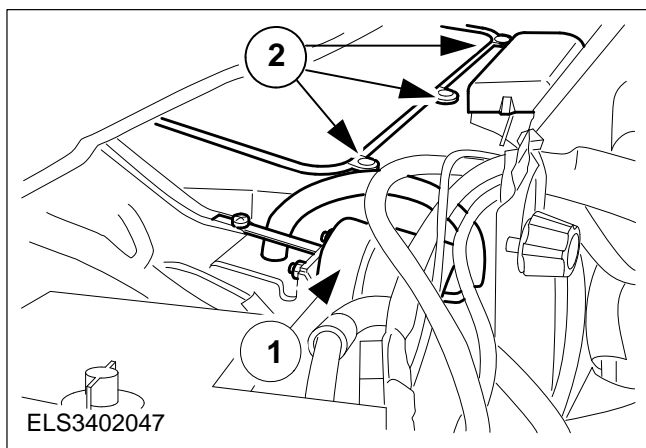
**17. Remove the evaporator housing.**

1 Remove the vacuum motor.

- Unscrew the bolt.
- Unscrew the two nuts.
- Disconnect the vacuum pipe from the vacuum accumulator.

2 Detach the air conditioning housing cover.

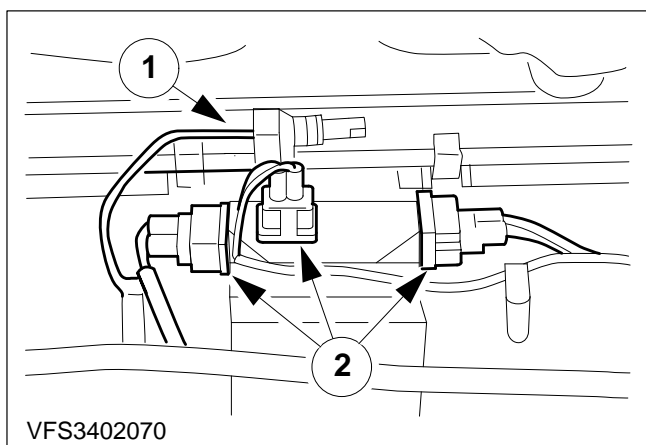
**18. Remove the evaporator housing (continued) (air conditioning with ATC only).**

1 Disconnect the multiplug from the exterior temperature sensor.

2 Disconnect the three multiplugs from the heater blower control (HBC) module.

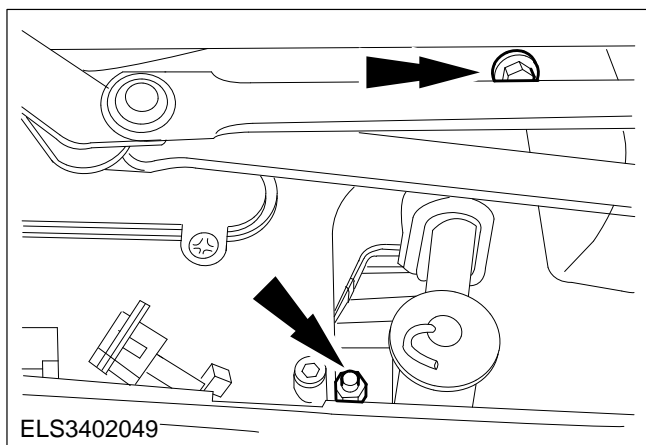
**19. Remove the evaporator housing (continued).**

- Disconnect the blower motor wiring and ground lead.
- Disconnect the multiplugs from the control motor and the de-ice switch.
- Remove the vacuum accumulator.
- Remove one bolt and one nut on each side.

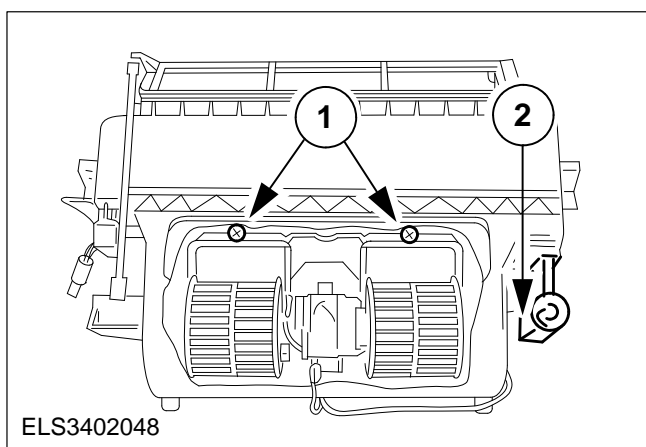
**20. Remove the evaporator.**

1 Remove the two bolts.

2 Detach the expansion valve (two bolts).

Remove the 21 clips and separate the housing halves.

Install

**NOTE:** Torques

**21. Refit the components in the reverse order.**

**22. Fit the expansion valve.**

**23. Fit the evaporator housing.**

**NOTE:** Fit new O rings to the lines.

**24. Attach the lines to the expansion valve.**

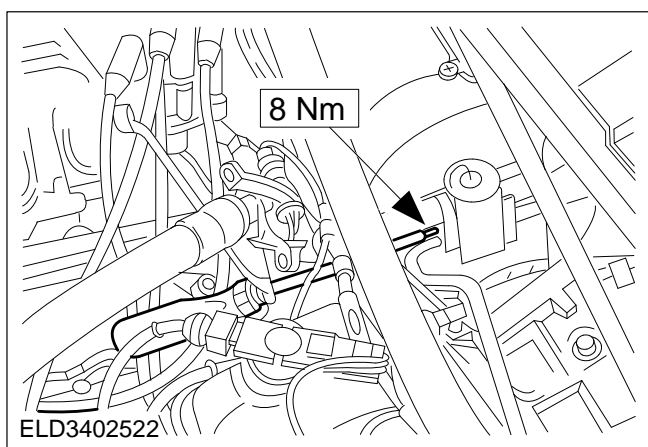
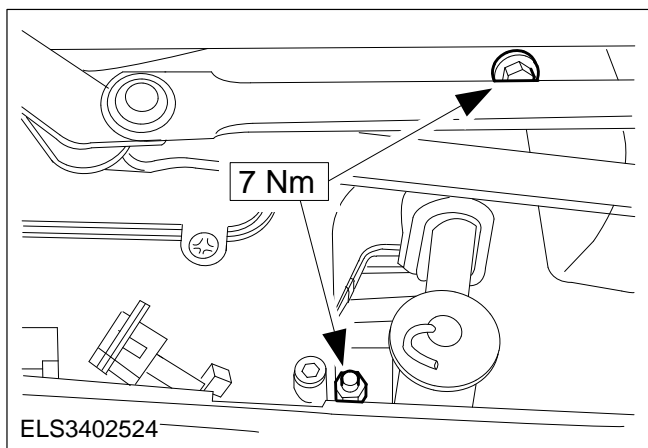
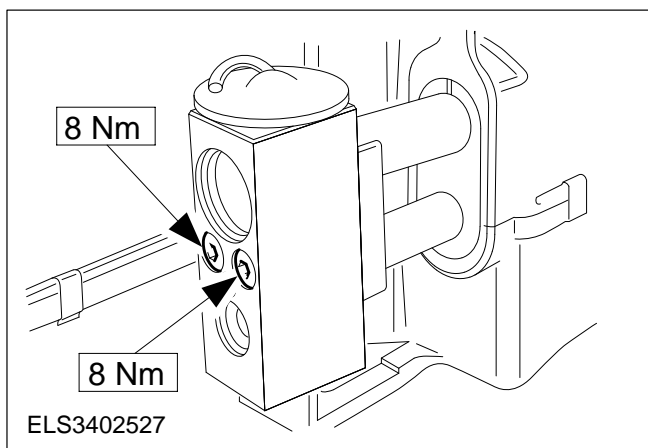

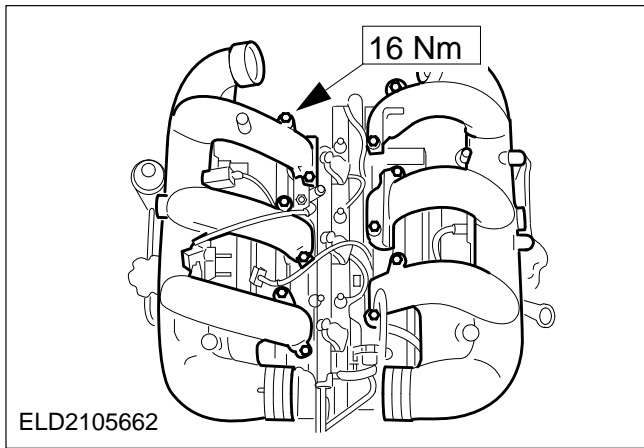

**25. Fit the plenum sections (six bolts on the right, six bolts on the left) (V-shaped connecting pipe has been removed for clarity).**

**26. Standard finishing operations:**

- Connect the battery negative lead.
- Remove the protective covers.
- Enter the radio keycode.
- Reprogramme the preset radio stations.
- Reset the clock.
- Road test the vehicle to collect data for the PCM.

**27. Evacuate and fill the air conditioning system as described in Op. no. 34 620 0.**