

Expansion Valve – Remove and Install (34 623 0)

Workshop Equipment

Servicing unit	
----------------	--

Materials

O-rings (green)	
-----------------	--

Remove

NOTE: “Safety Regulations” and “General Requirements and Safety Precautions for Servicing and Repairs” at the beginning of this section.

1. Standard preparatory measures:

- Make a note of the radio keycode.
- Make a note of the preset radio stations.
- Put protective covers on the fenders.

⚠ CAUTION: Disconnect the battery negative lead.

2. Drain the air conditioning system as described in Op. no. 34 620 0.

3. Detach the seal retaining plate.

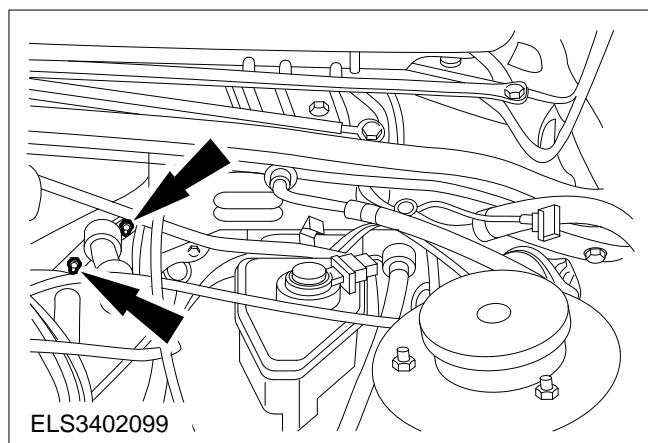

4. Detach the lines from the expansion valve.

Remove the O-rings.

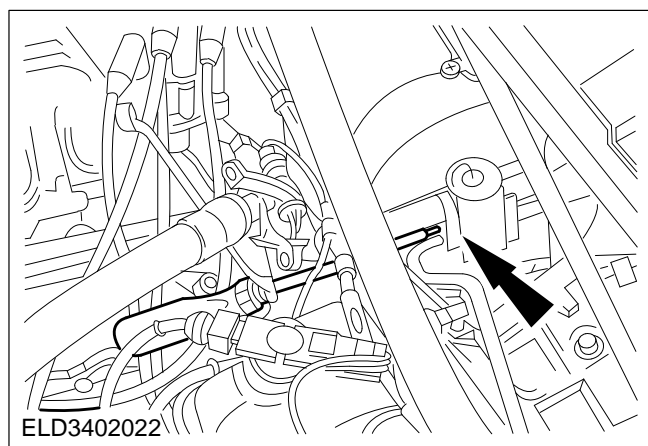

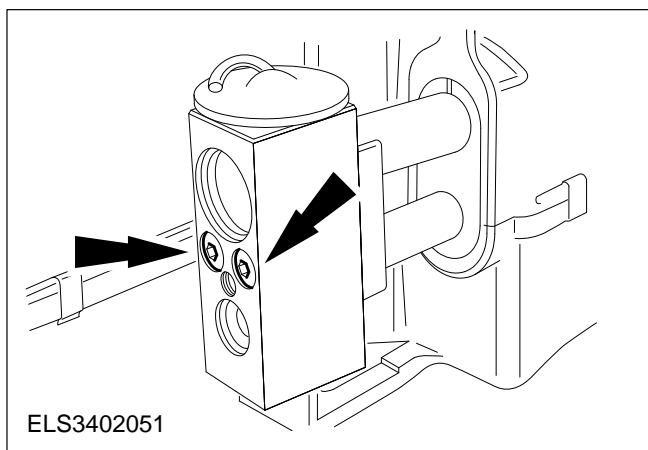

5. Remove the expansion valve.

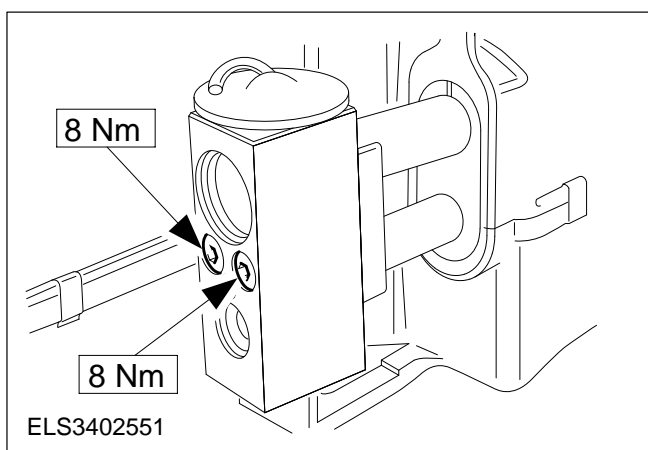

Install

6. Fit the expansion valve.

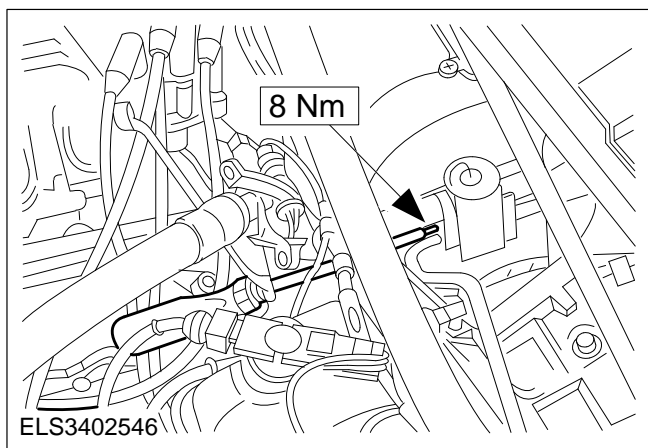

NOTE: O-rings.

7. Connect the lines to the expansion valve.

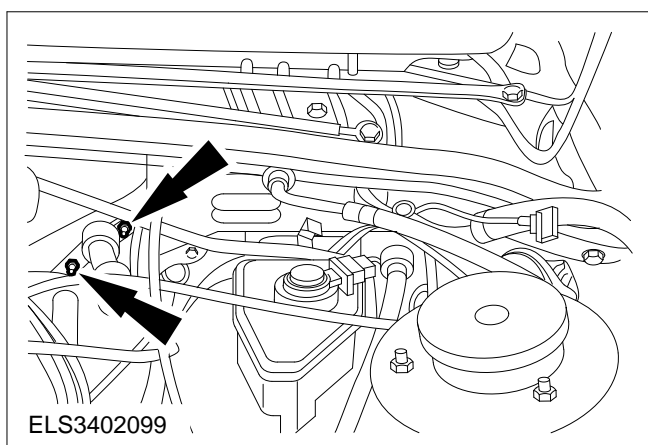

8. Fit the seal retaining plate.

9. Standard finishing operations:

- Connect the battery negative lead.
- Enter the radio keycode.
- Remove the protective covers.
- Reprogramme the preset radio stations.
- Reset the clock.
- Road test the vehicle to collect data for the PCM.

10. Evacuate and fill the air conditioning as described in Op. no. 34 620 0.