

Gear Selector Mechanism – Remove and Install (17 634 0)

Materials

Cable ties	
------------	--

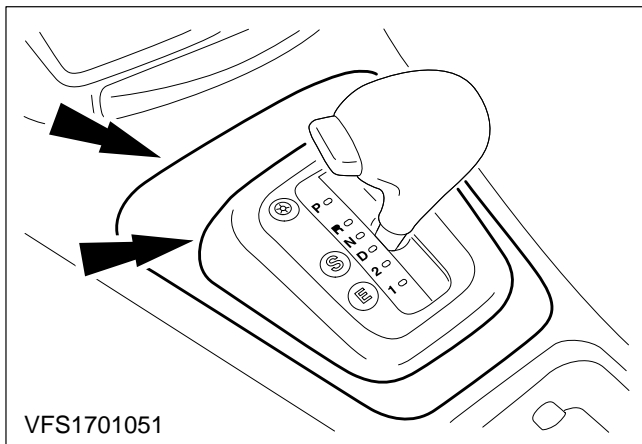

Remove

1. Remove the bezel and cover for the selector lever assembly.

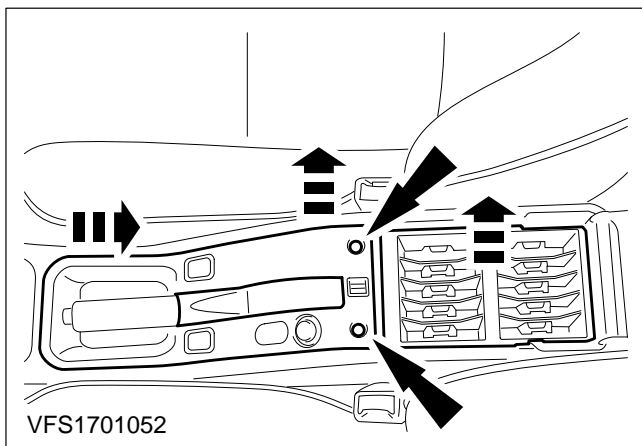

2. Remove the cassette holder from the centre console.
3. Remove the switch console.

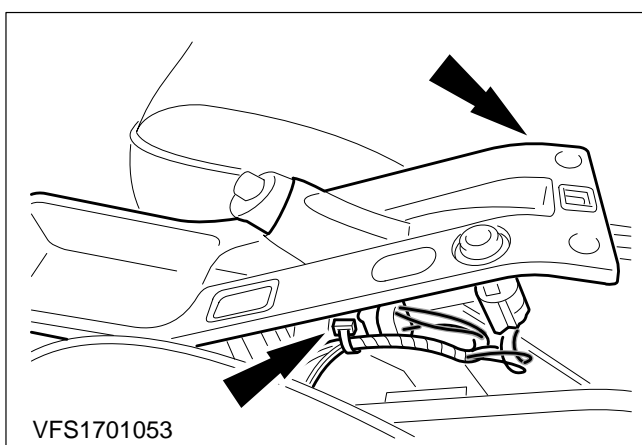

4. Lift the switch console over the handbrake lever and cut the cable ties.

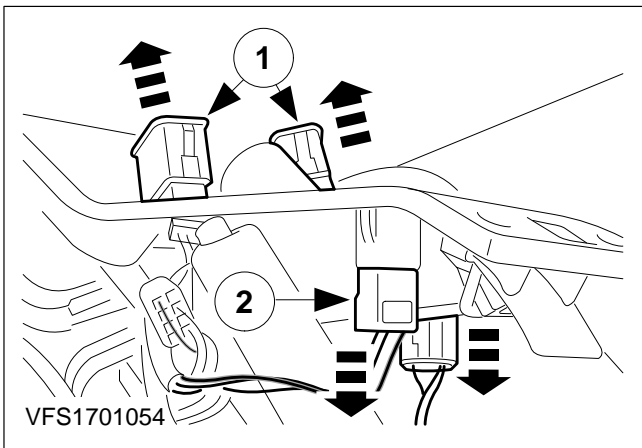

5. Disconnect the plugs.

- 1 Push both switches out from below.
- 2 Disconnect the multiplug.

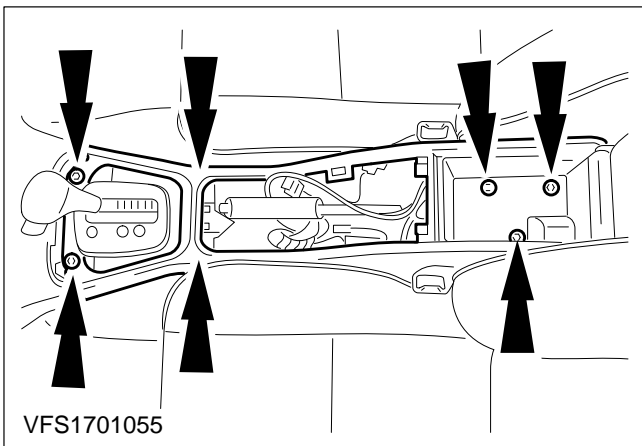

6. Remove the centre console.

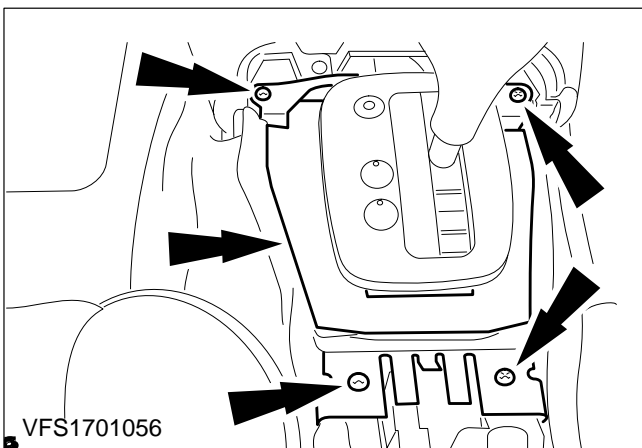

7. Take out the damping plate.

8. Detach the centre console bracket.

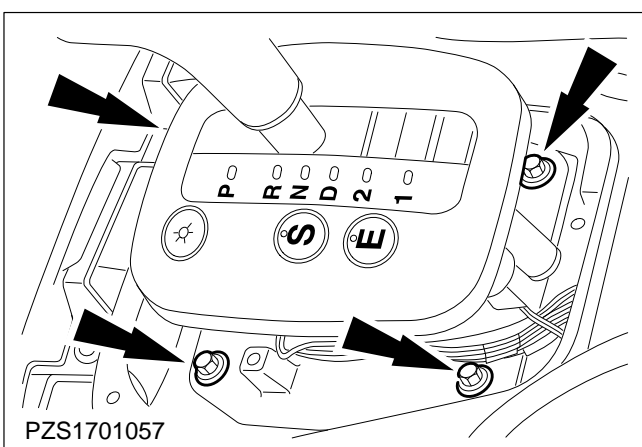

9. Remove the selector lever assembly.

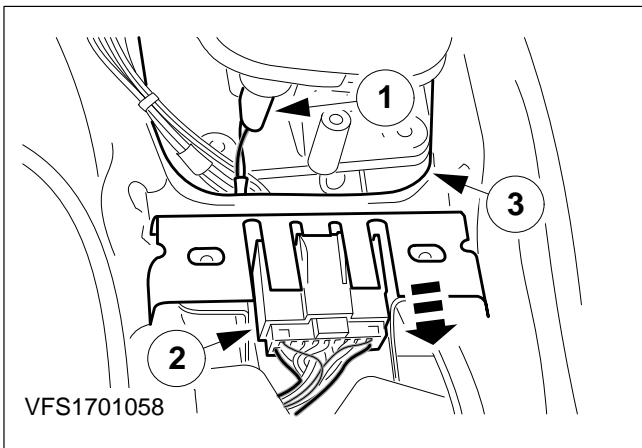
**10. Disconnect the wiring loom multiplug.**

- 1 Remove the light for the selector lever assembly.
- 2 Withdraw the multiplug from the centre console bracket and disconnect it.
- 3 Lift the centre console bracket slightly and draw the wiring loom and multiplug through.

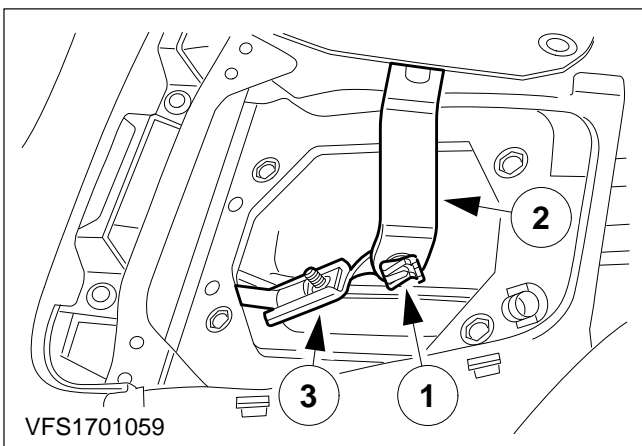
**11. Detach the selector rod from the selector lever assembly.**

- 1 Retaining clip
- 2 Selector lever
- 3 Selector rod

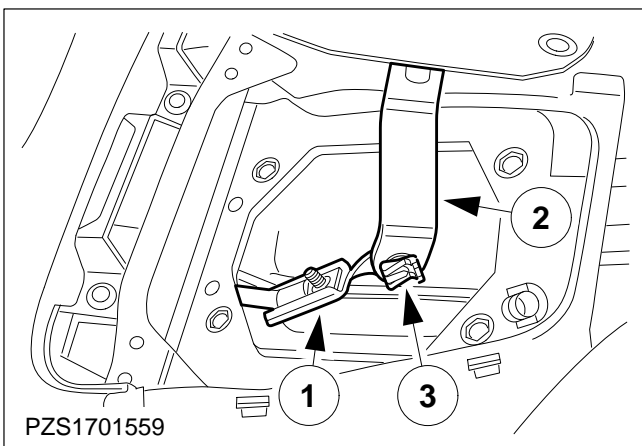
**Install****12. Attach the selector rod to the selector lever assembly.**

- 1 Selector rod
- 2 Selector lever
- 3 Retaining clip

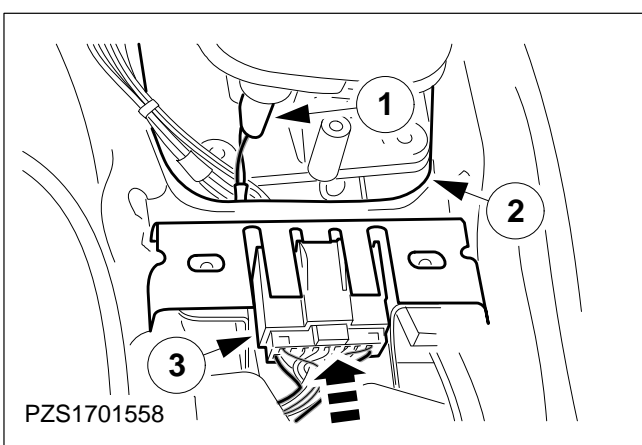
**13. Connect the wiring loom multiplug.**

- 1 Fit the light for the selector lever assembly.
- 2 Lift the centre console bracket slightly and draw the wiring loom and multiplug through.
- 3 Connect the multiplug and secure it in the centre console bracket.

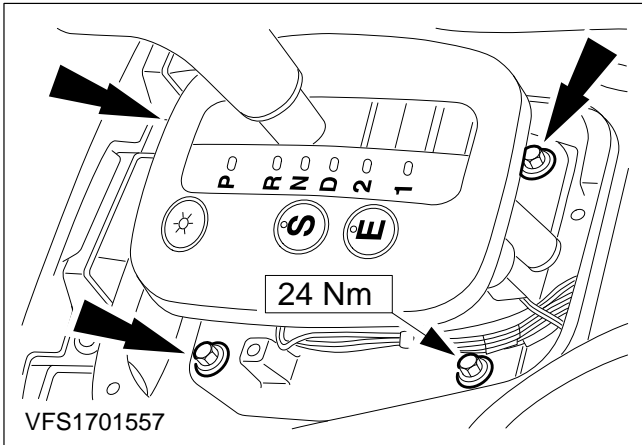

14. Install the selector lever assembly.

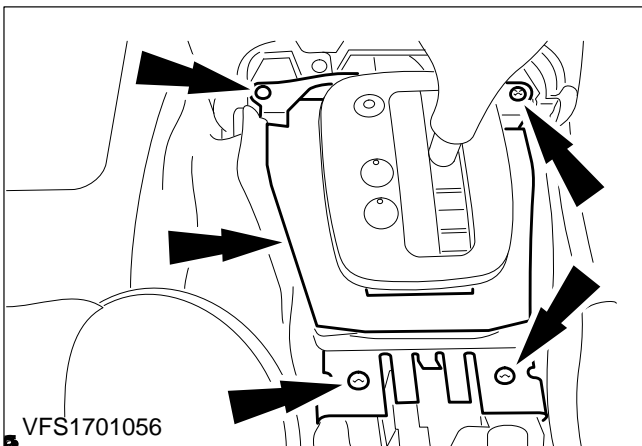

15. Fit the damping plate.

16. Attach the centre console bracket.

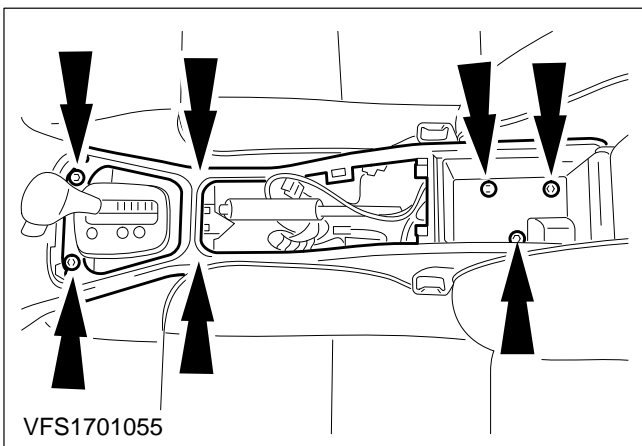

17. Install the centre console.

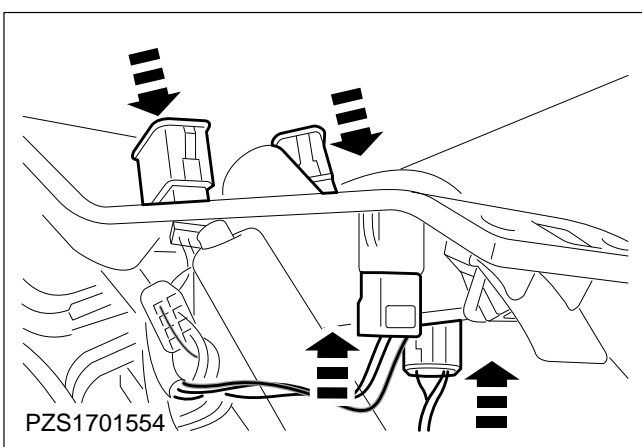

18. Connect the plugs and fit the two switches.

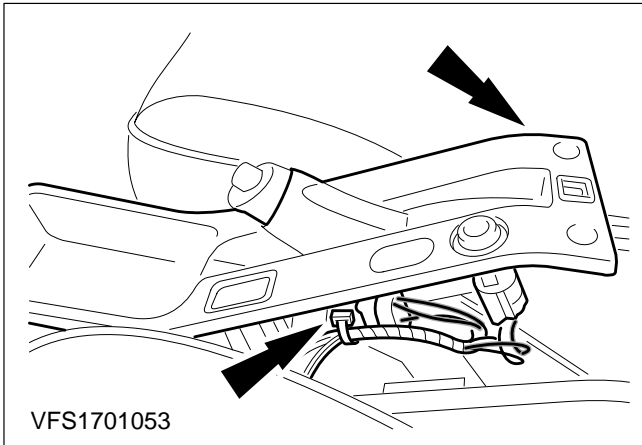

19. Slide the switch console over the handbrake lever.

20. Secure the cables with cable ties.

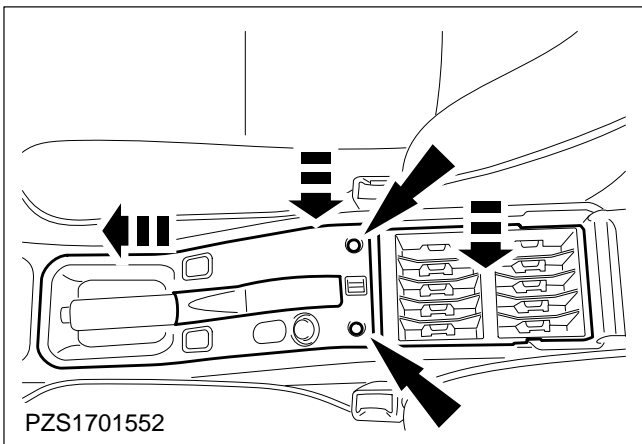

21. Install the switch console.

22. Fit the cassette holder in the centre console.

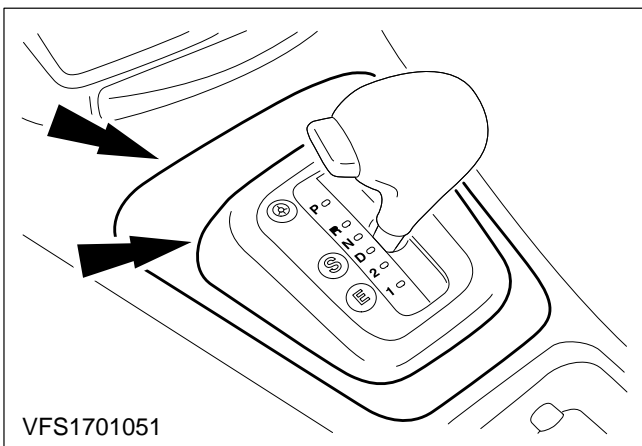

23. Install the bezel and cover of the selector lever assembly.