

**Module – Multiplex (Door) – Remove and Install (33 669 0)****Remove**

**⚠ CAUTION:** Disconnect the battery negative lead.

1. **Remove the front door trim panel (refer to Operation Number 43 705 0).**

**NOTE:** When cut, the exposed butyl surfaces should not be touched as the natural oils from the skin will prevent effective rebonding.

2. **Locally detach and fold back the foam watershield.**

In order to remove or partially detach a foam watershield from a door, a plastic knife (disposable cutlery) should be used to cut through the bead of butyl material.

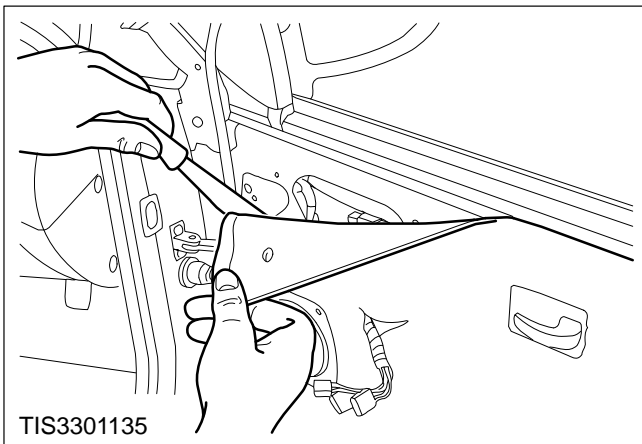

3. **Remove the screw retaining the multiplug support bracket.**

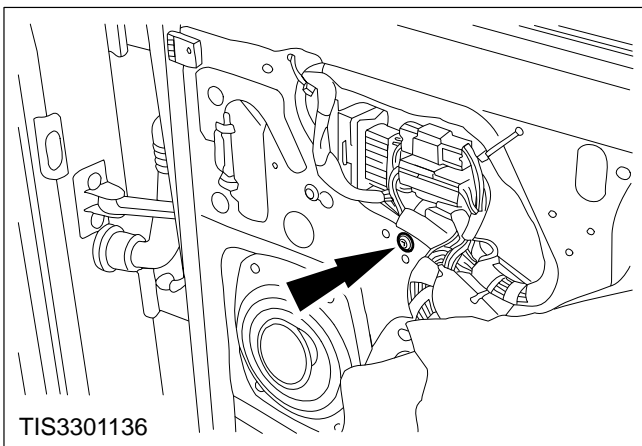

4. **Unhook the multiplug support bracket from the wiring loom and pull it through the aperture.**

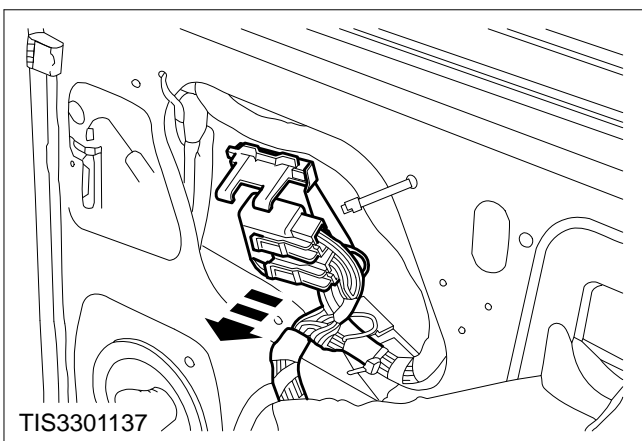

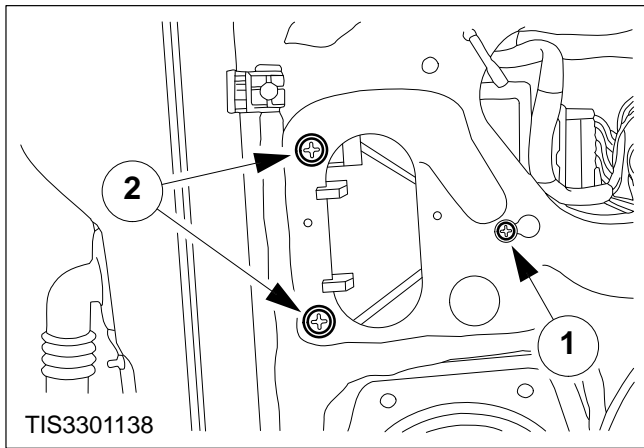
**5. Detach the multiplex door module.**

- 1 Slacken the pinch screw.
- 2 Remove the two retaining screws.

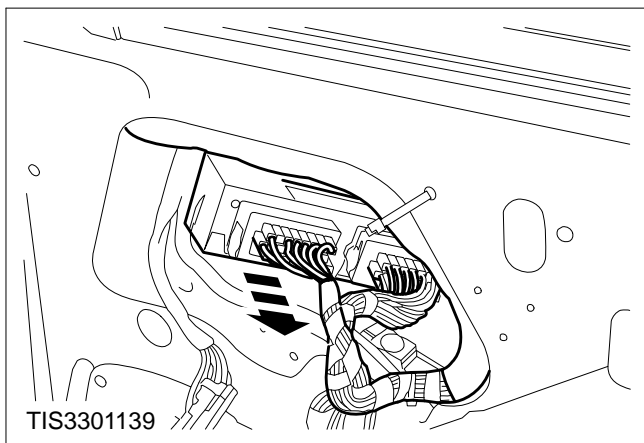
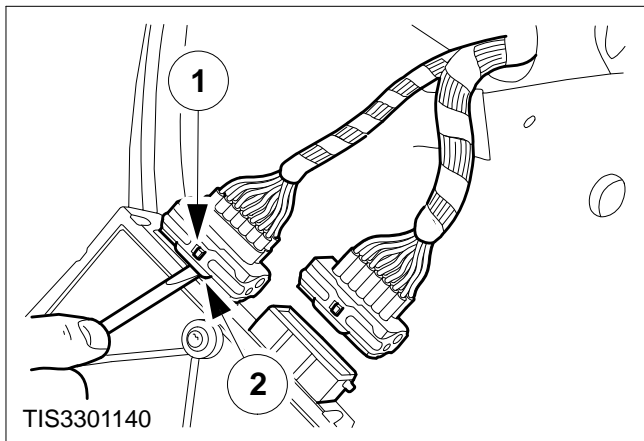
**6. Slide the module sideways to release and manoeuvre the module out through the aperture.****7. Disconnect two multiplugs and remove the module.**

- 1 Depress the plastic clip.
- 2 Lever the metal retaining clip upwards.

**Install****8. Refit the components in reverse order.**