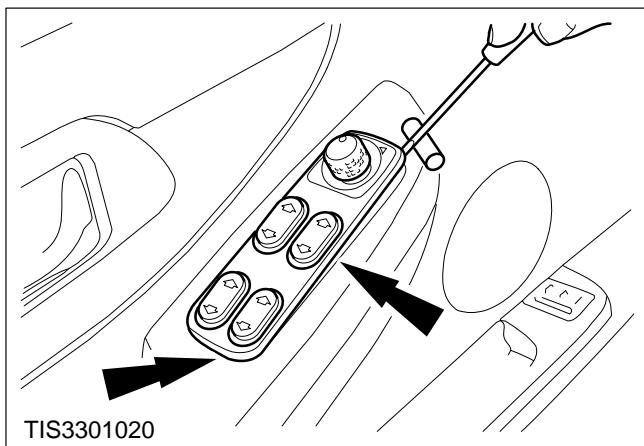
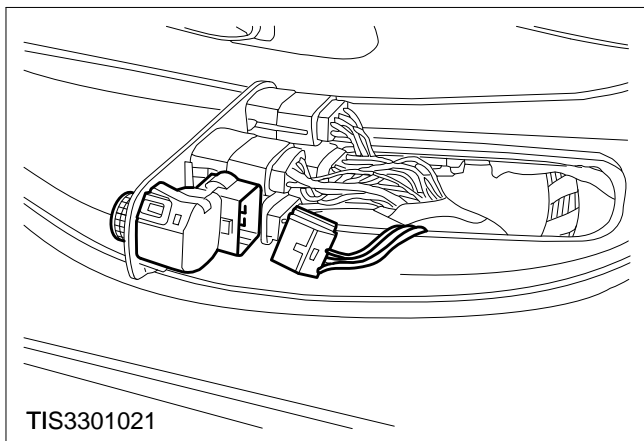
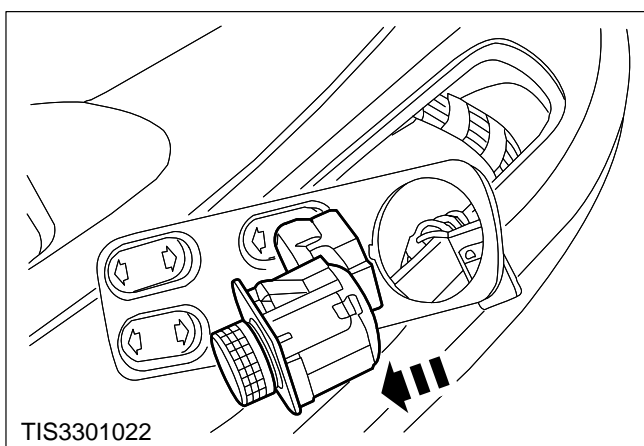

Switch – Door Mirror Control – Remove and Install (33 519 0)**Remove**

⚠ CAUTION: Disconnect the battery negative lead.

1. Prise out the switch panel assembly.

Use a pad between the screwdriver and the surround to prevent damage.

**2. Disconnect the multiplug.****3. Remove the switch.**

Install

4. Refit the components in reverse order.