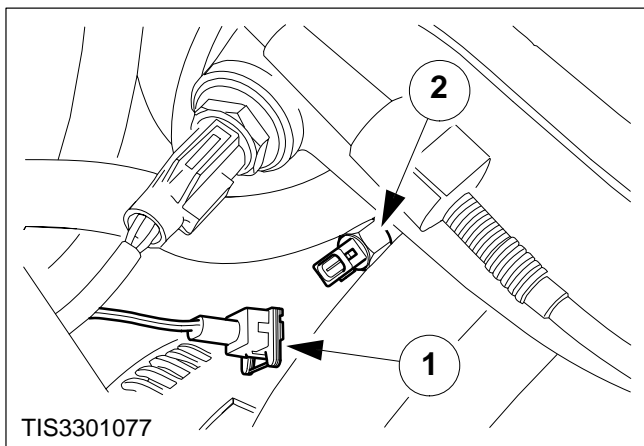

Switch – Thermal – Radiator Fan – Remove and Install (33 555 0)**Remove**

⚠ CAUTION: Disconnect the battery negative lead.

- 1. Drain sufficient coolant into a clean tray to allow the switch to be removed without coolant spillage.**
- 2. Remove the switch (DOHC 8V shown).**
 - 1 Disconnect the multiplug.
 - 2 Unscrew and remove the switch.

**Install**

- 3. Refit the components in reverse order.**

Refill the coolant system and check the coolant level in the expansion tank.

