

## Exhaust System (Diesel) – Remove and Install (25 204 0)

### Material

Anti-seize Grease	SAM-1C-9107A
-------------------	--------------

**⚠ CAUTION:** The rubber insulators supporting the catalyst are constructed of a special material to cope with the high temperatures in this area. It is important, therefore, that these remain the correct specification and Part Number.

**NOTE:** The exhaust systems are of two-piece construction for production, including the catalyst/muffler assembly, and three or four piece construction for service replacement exhaust systems. However, for the purposes of this section only we will be referring to the exhaust system as that portion starting from the flange joint after the turbocharger and in front of the catalyst centre/muffler.

It is therefore necessary to cut the production exhaust to enable fitment of the replacement one or two piece rear muffler assembly.

The centre muffler of the production system cannot be replaced without also fitting a new rear muffler.

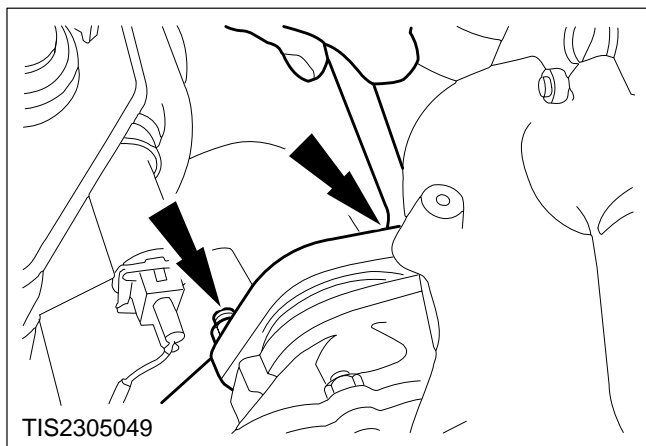

### Remove

Muffler – Centre/Rear (Diesel) – Renew (25 241 0) and Catalyst (Diesel) – Renew (25 250 0)

1. **Disconnect the exhaust from the turbocharger flange.**

Two nuts.

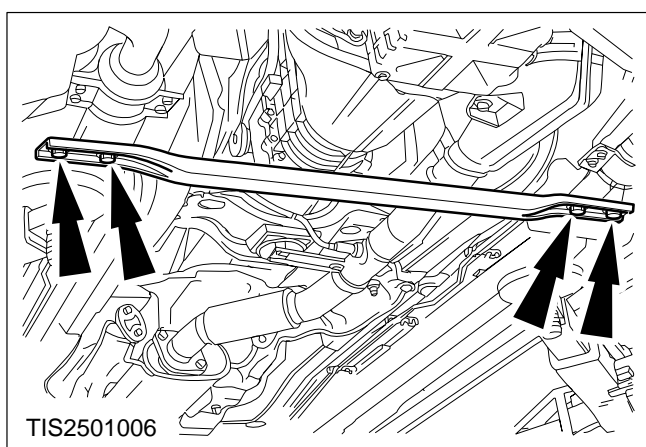

2. **Remove the crossmember.**

Four bolts.

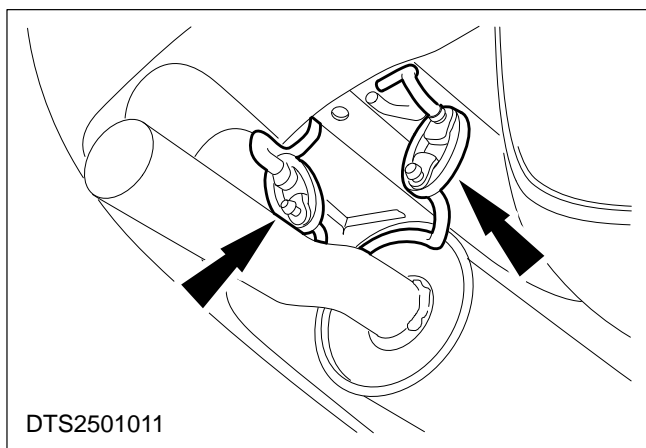

**NOTE:** If the catalyst is to be refitted care must be taken not to damage the assembly, excessive force may damage the internal ceramic substrates.

**3. With the assistance of another technician remove the exhaust rear section.**

- Unhook the two rear insulators.
- Unhook the two front insulators.
- Unhook the two centre insulators.

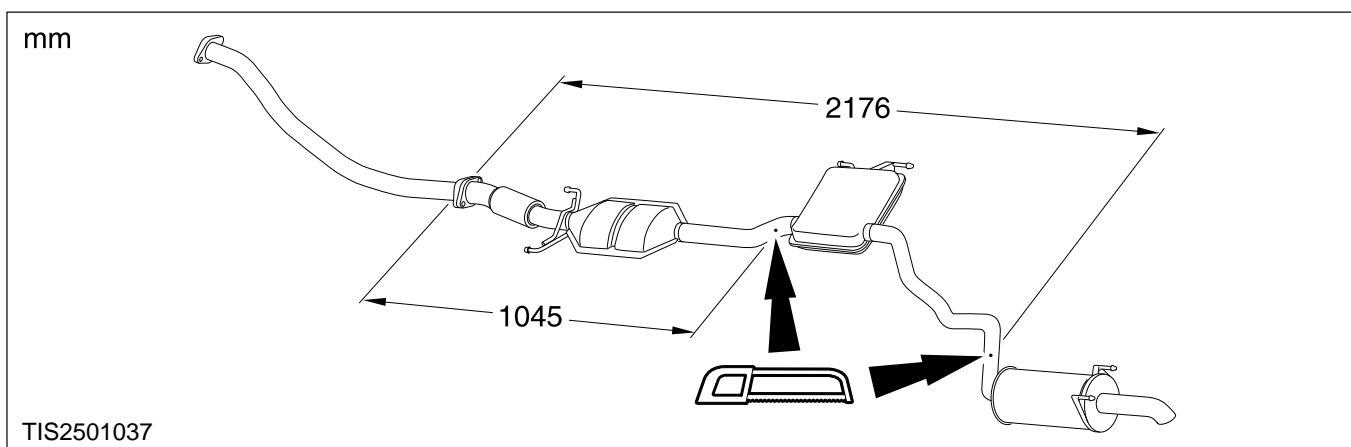

### Install

**4. Cut the exhaust pipe as specified to suit the model type and extent of replacement.**

- Clean the manifold flange to remove any carbon deposits.
- Clean the manifold studs and coat with anti-seize grease.

**5. Assemble the exhaust system.**

Loosely connect the replacement exhaust components.

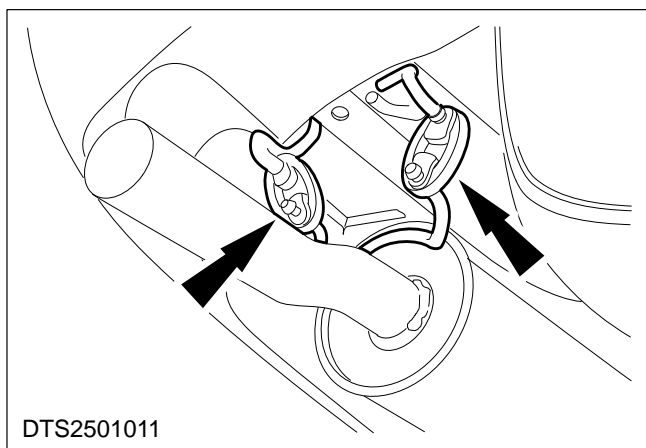

**6. With the assistance of another technician refit the exhaust rear section.**

- Examine the rubber insulators for damage or fatigue.
- Refit the two centre insulators.
- Refit the two front insulators.
- Refit the two rear insulators.

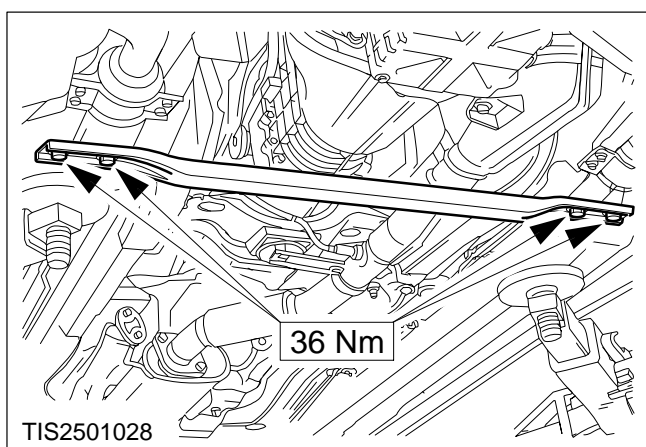

**7. Refit the crossmember.**

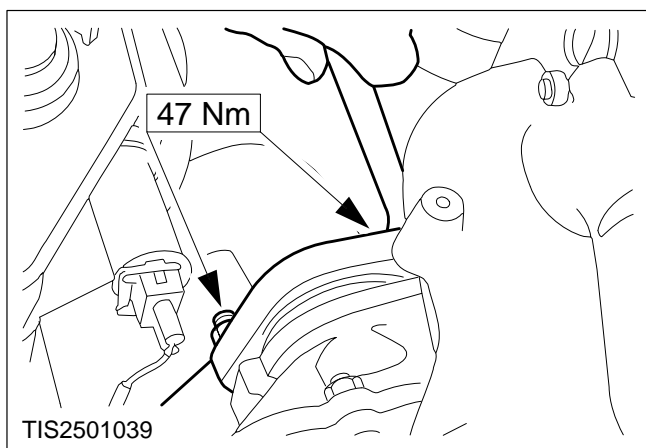

**⚠ CAUTION:** You must never use jointing compound forward of the catalyst when installing exhaust components.

**8. Fit the exhaust to the turbocharger flange.**

**9. Check the alignment of the system and tighten the nuts.**

Two nuts.