

Rear Axle and Suspension Assembly – Remove and Install (15 212 0)

Workshop Equipment

Trolley jack	
Transmission jack	

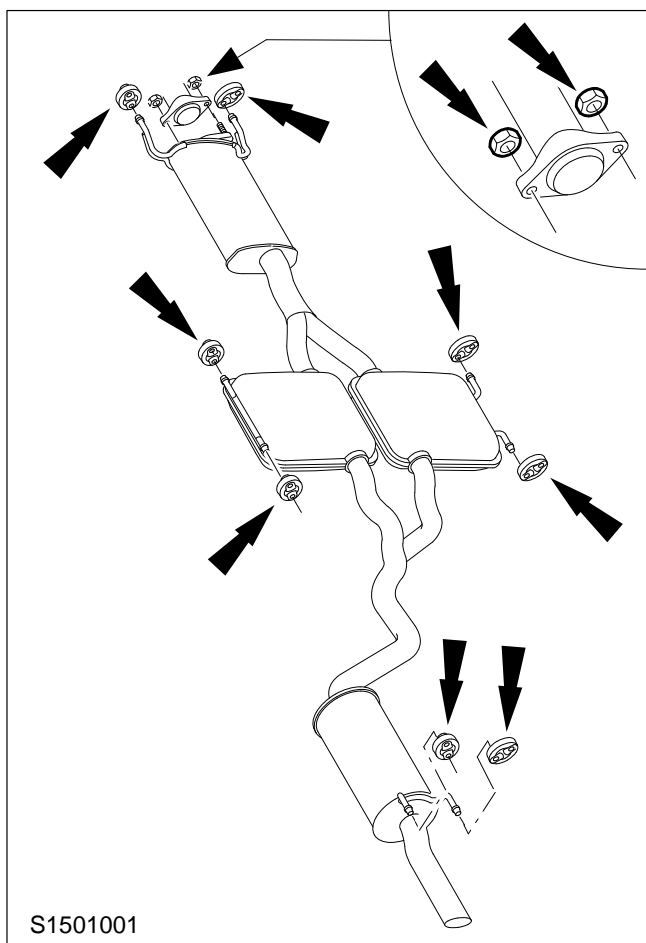

Remove

1. Remove the rear part of the exhaust system.

- Raise the vehicle.
- Disconnect the exhaust system at the middle flange (two bolts).
- Unhook the rear part of the exhaust system from the rubber mountings and lay it to one side.

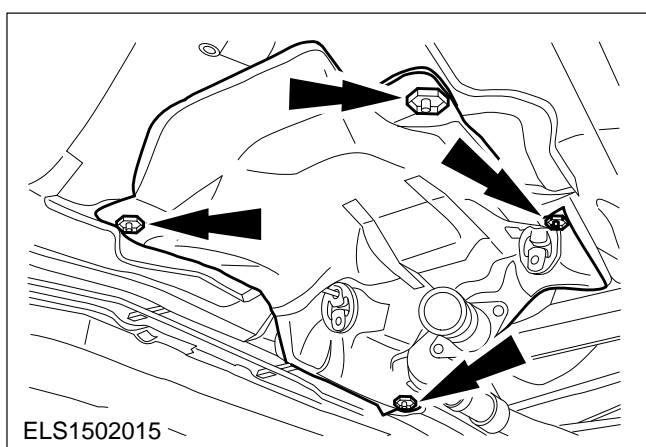

2. Detach the exhaust system front heat shield.

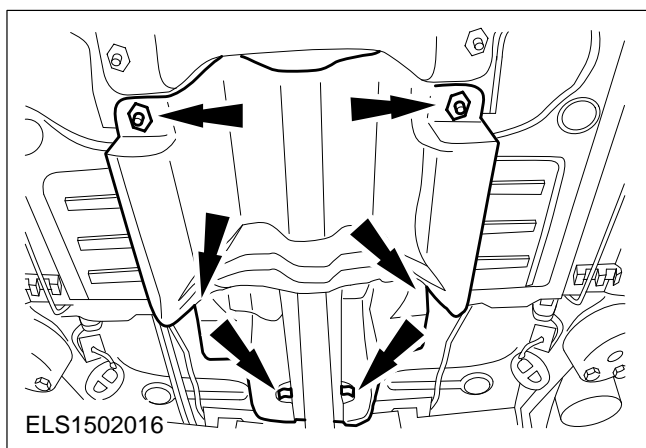

3. Detach the exhaust system rear heat shield.

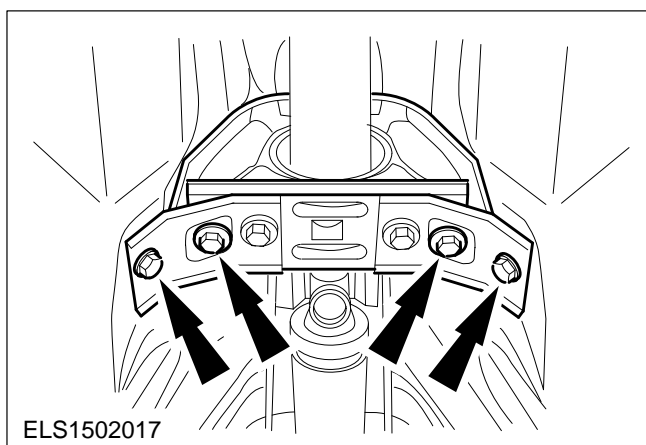

4. Release the driveshaft centre bearing.

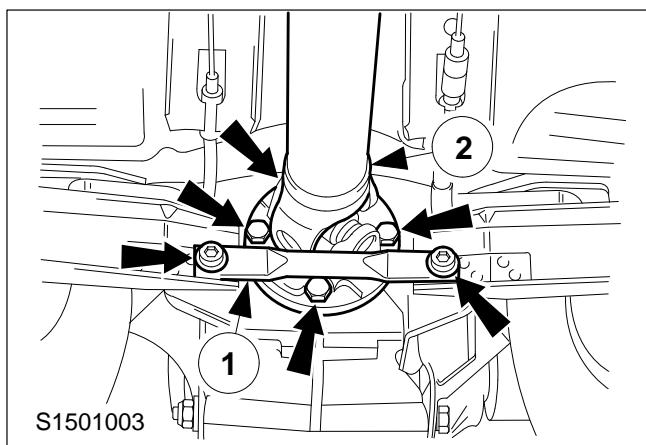

⚠ CAUTION: The driveshaft is precision-balanced by bolts of different lengths. Mark the location of the driveshafts and the bolts.

5. Detach the driveshaft from the rear axle.

NOTE: The transverse brace will no longer be fitted in vehicles built from Jan '96 onwards.

- 1 Detach the transverse brace from the rear axle.
 - 2 Remove the four bolts.
- Slide the driveshaft forwards, detach it from the rear axle flange and suspend it to one side.

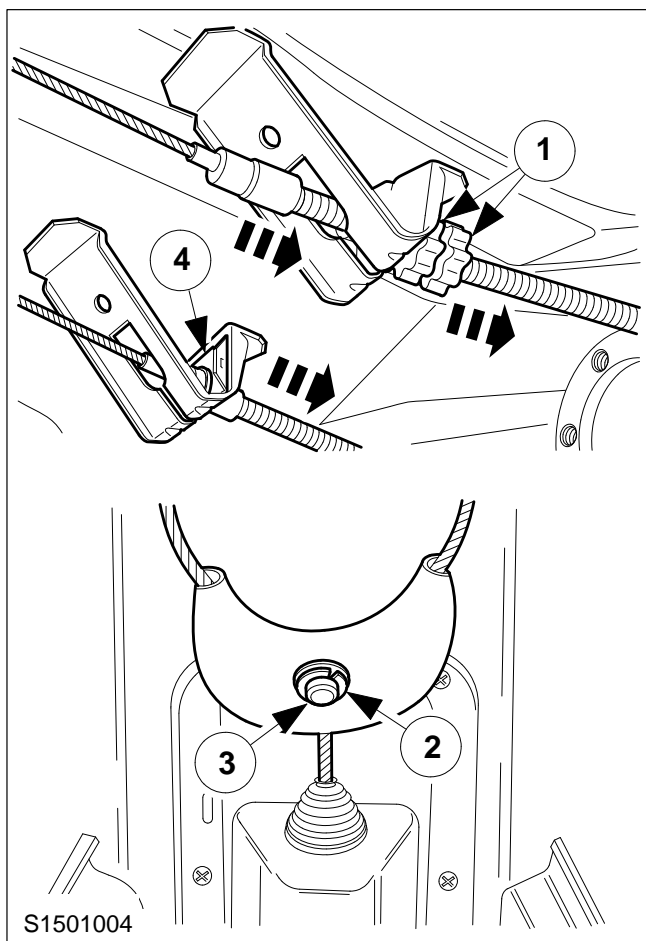

6. Detach the handbrake cable equaliser and brake cable covers.

- 1 Press back the locking pin and slacken the lock nut. Back off the adjusting nut and lock nut sufficiently.
- 2 Remove the clip.
- 3 Press the pin up out of the handbrake cable equaliser.
 - Pull the handbrake cable equaliser off the cable from the handbrake lever.
- 4 Prise out the U-shaped retainer using a small screwdriver.
 - Pull both outer cables out from the back of the brackets.

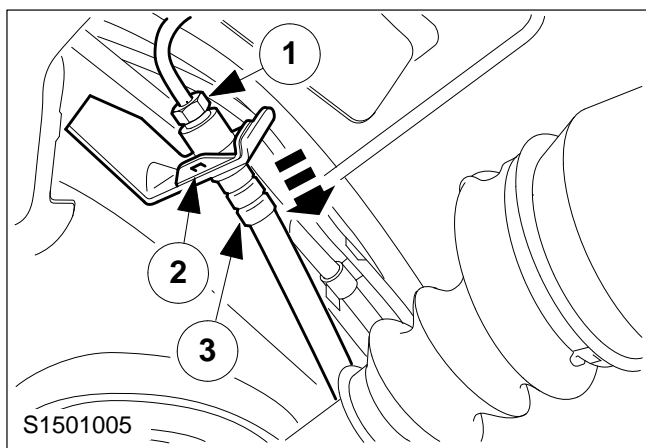

⚠ WARNING: Observe the safety precautions for handling brake fluid.

7. Detach the brake pipes and brake hoses on the right and left-hand sides (left-hand side shown).

NOTE: Seal the ends of the brake pipes and brake hoses with suitable plugs.

- 1 Unscrew the brake pipe.
- 2 Remove the U-shaped retainer.
- 3 Pull the brake hose out of the bracket.

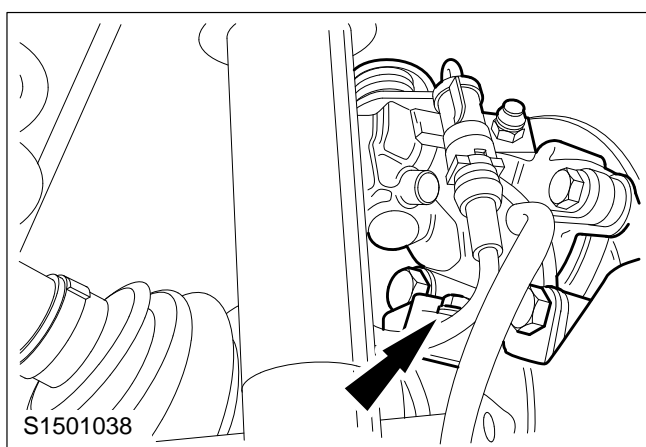

8. Unscrew the rear ABS sensor sender unit on both sides.

- Unclip the ABS sensor cables from the rear axle body (three clips each).
- If necessary disconnect the cables for the auxiliary warning system and unclip them from the crossmember.

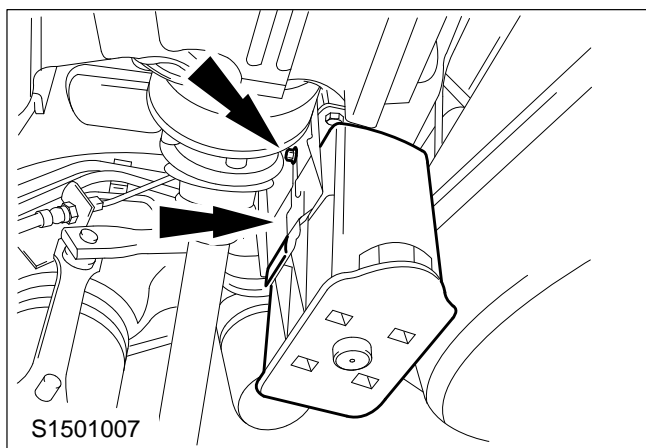

Petrol-engined variants only.

9. Detach the EVAP canister.

Loosen the bolt on the bracket, unhook the EVAP canister and tie it up to one side.

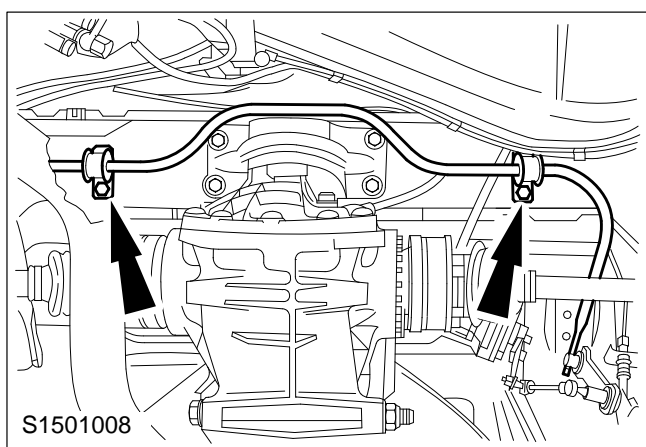

10. Detach the stabiliser bar from the bodywork (shown in vehicle up to Dec '95).

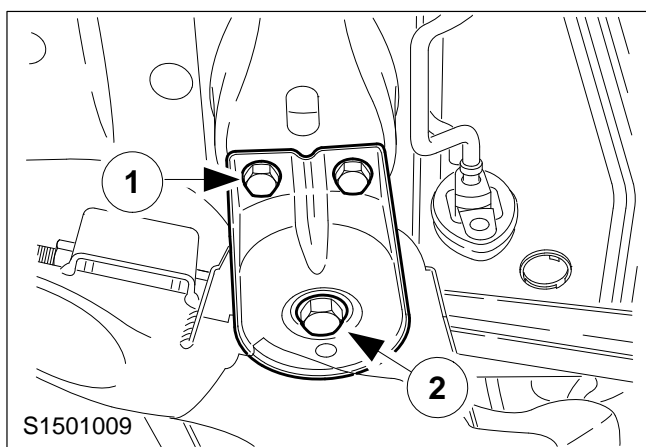

11. Detach the right and left-hand crossmember guide plates.

- 1 Unscrew the two bolts in each case.
 - 2 Slacken the bolt of the crossmember guide plate three turns.
- Lower the vehicle until the coil springs are under a light load.
 - Support the differential assembly on a trolley jack.
 - Unscrew the guide plate bolt on both sides.

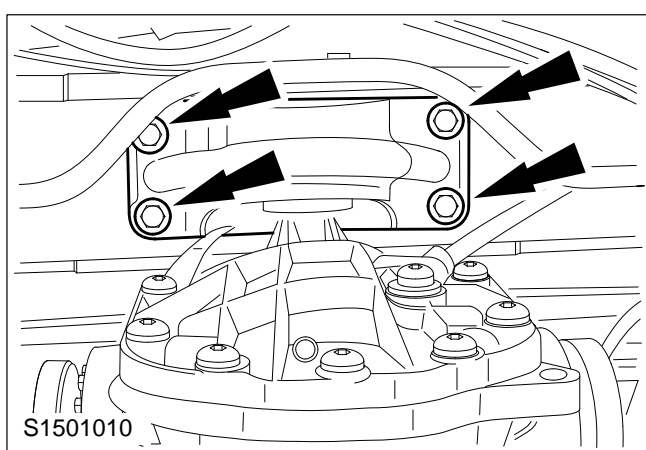

Models up to Dec '95 only.

12. Detach the differential mounting from the floor assembly.

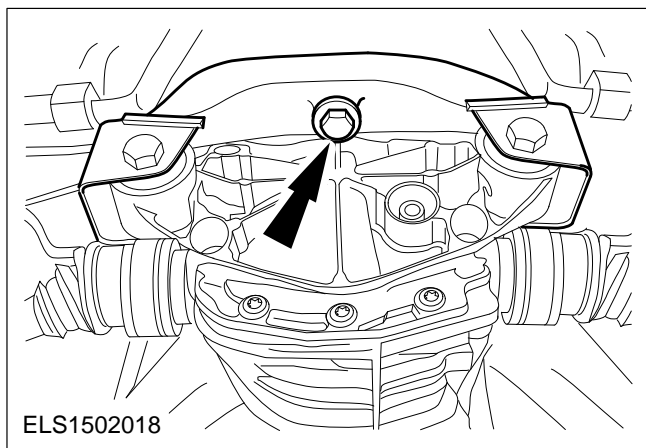

Models from Jan '96 only

13. Detach the differential mounting from the floor assembly.

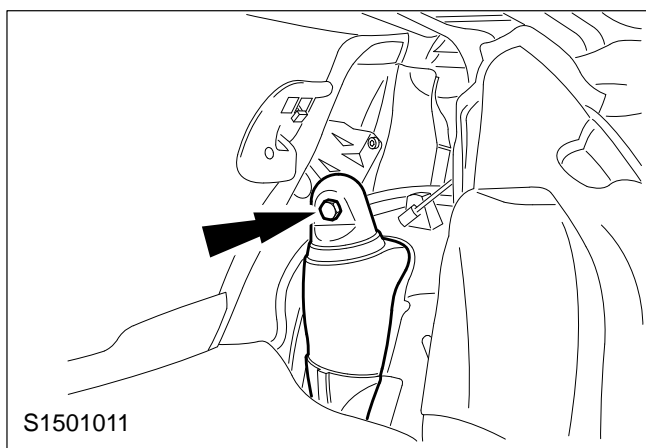

Saloon only

14. Detach both shock absorbers from the body at the top.

- Pull back the rear side trim panels in the luggage compartment.

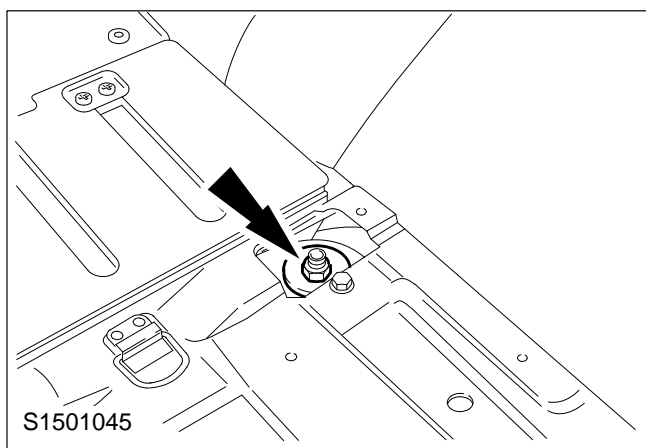

Estate only

15. Detach the shock absorbers from the body at the top.

- Pull the load space carpet to one side and remove the cover.
- Unscrew the nut and remove it with the washer.

16. Remove the rear axle and suspension.

Raise the vehicle on a lift and run the rear axle out on a trolley jack towards the rear.

Install

17. Position the rear axle.

- Run the rear axle underneath the vehicle on the trolley jack and align it.

NOTE: Align the top ends of the shock absorbers correctly.

- Lower the vehicle until the coil springs are under a light load.

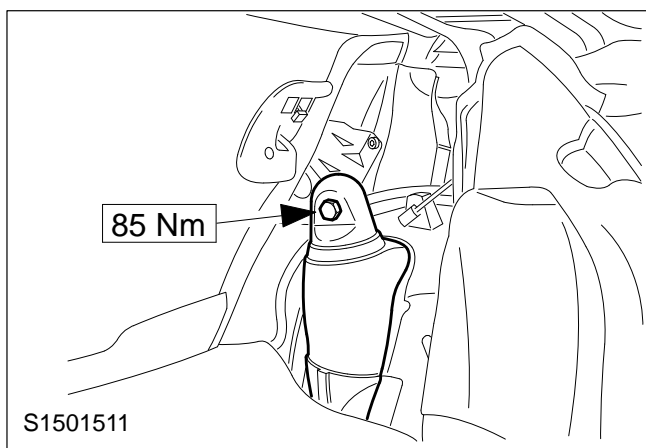

Saloon only

18. Bolt both shock absorbers to the body at the top.

Secure the luggage compartment side trim panels.

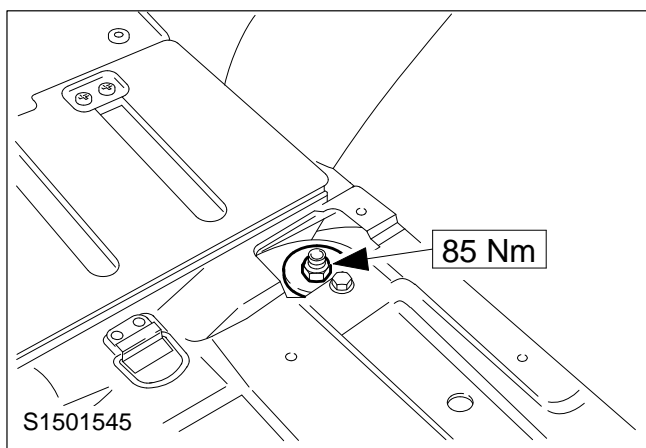

Estate only

19. Bolt both shock absorbers to the body at the top.

- One nut and washer in each case.
- Re-lay the load space carpet.

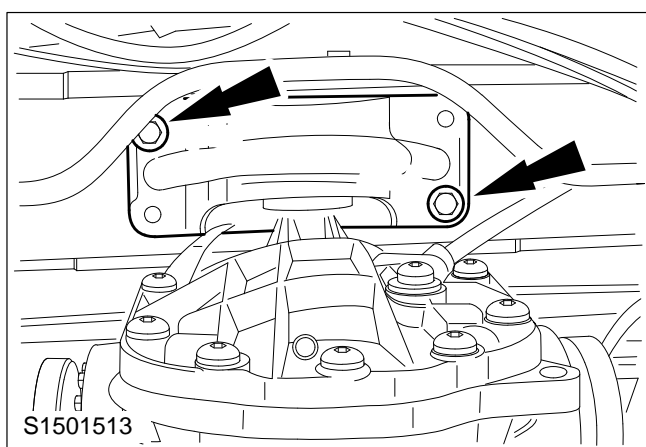

Models up to Dec '95 only

NOTE: Do not tighten the bolts.

20. Secure the differential mounting with two bolts diagonally.

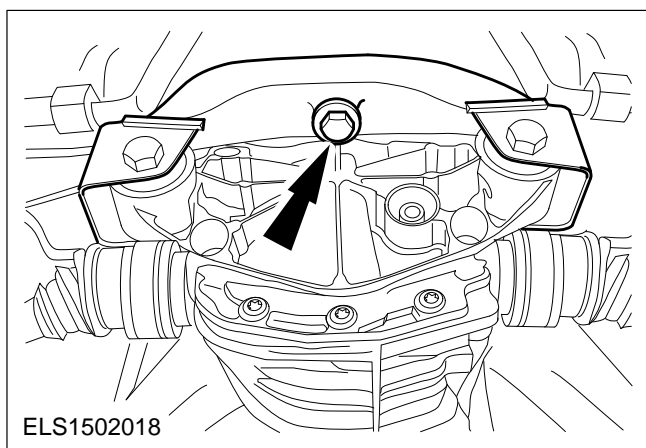

Models from Jan '96 only

NOTE: Do not tighten the bolt.

21. Attach the rear axle suspension.

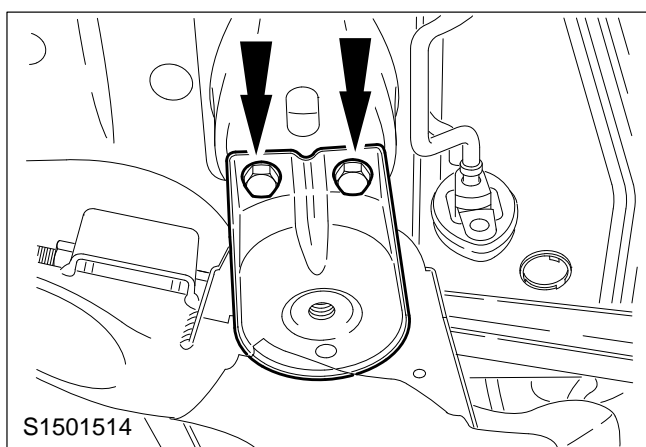

NOTE: Do not tighten the bolts.

22. Attach the two guide plates with two bolts in each case.

23. Raise the vehicle on the lift.

Support the differential assembly on a transmission jack.

24. Guide the crossmember locating sleeves into their holes in the floor assembly.

Align the axle body.

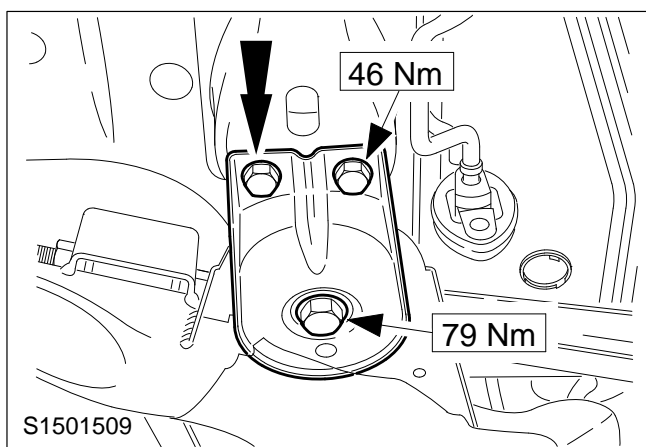

25. Tighten the bolts of the two crossmember guide plates.

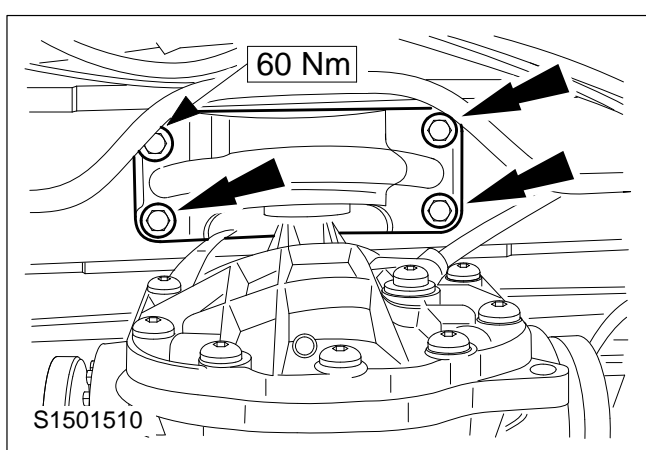

Models up to Dec '95 only

26. Attach the rear axle suspension.

- Screw in the remaining bolts.
- Tighten the bolts.
- Remove the transmission jack.

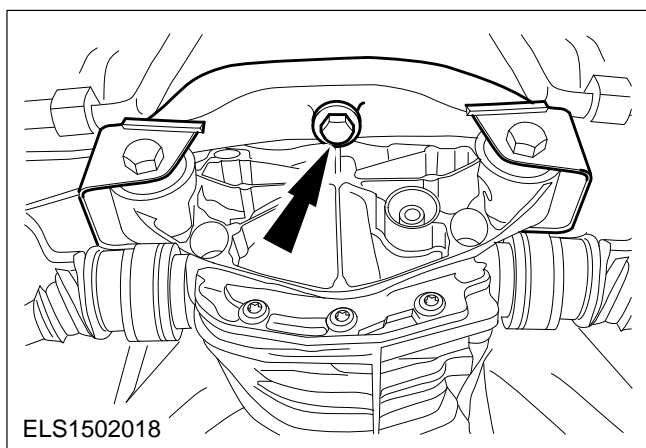

Models from Jan '96 only

NOTE: Torques

27. Tighten the bolt of the rear axle suspension.

- 110 Nm torque up to build month July '97.
- 125 Nm torque from build month Aug '97.

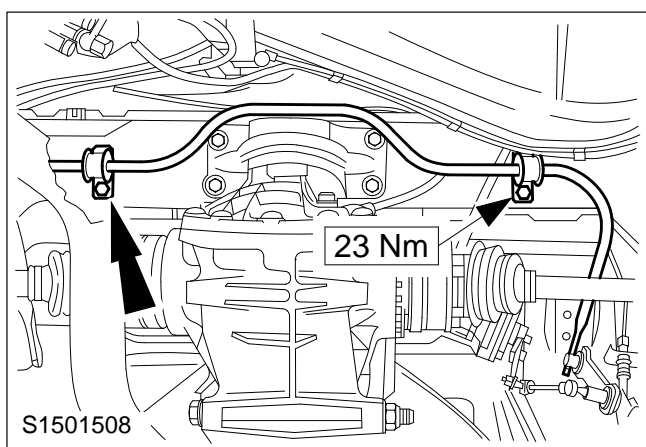

28. Fit the stabiliser (model shown up to Dec '95).

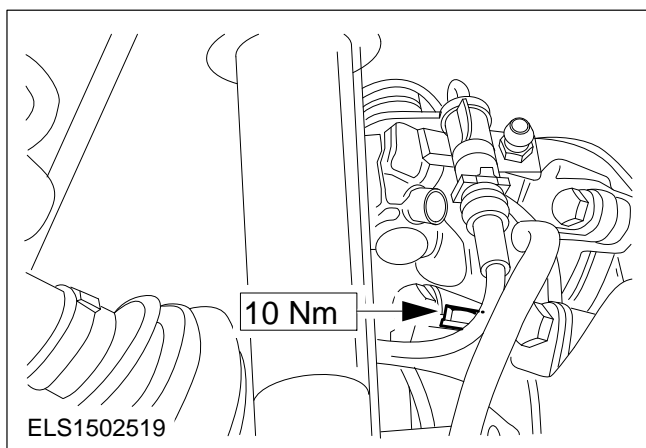

29. Fit the rear ABS sensor sender unit on both sides (one bolt on each side).

- Clip the ABS sensor cables onto the rear axle body (three clips on each side).
- If necessary connect the cables for the auxiliary warning system and clip them onto the crossmember.

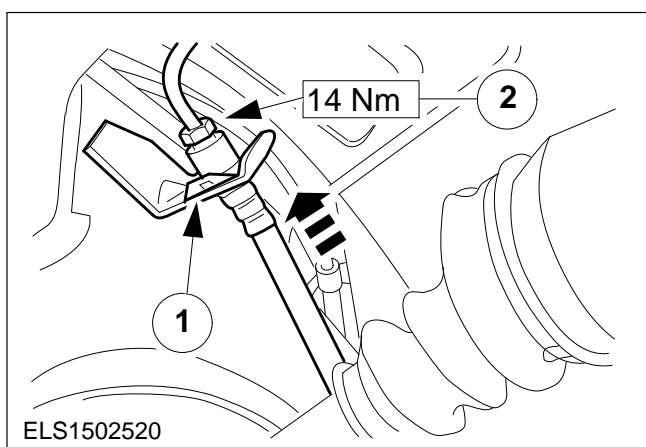

30. Attach the right and left-hand side brake hoses and brake pipes (left-hand side shown).

- Remove the plugs from the brake pipes and hoses.

1 Pass the brake hoses through the brackets and secure them with the U-shaped retainers.

2 Screw the brake pipes in place and secure them.

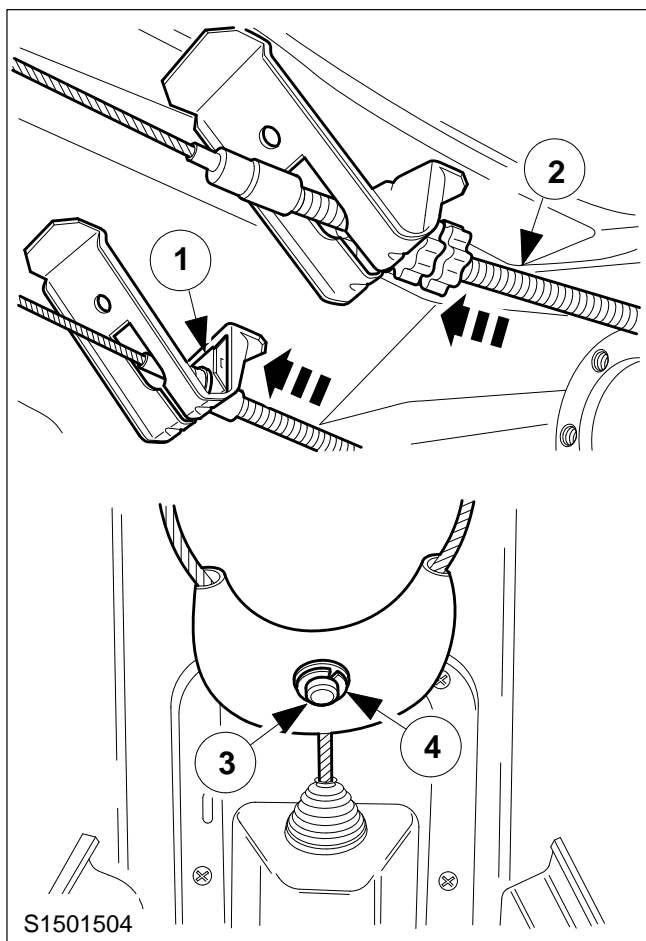

31. Insert the brake cable covers and attach the handbrake cable equaliser.

- 1 First insert the right-hand cable cover and secure it with the U-shaped retainer.
- 2 Guide the left-hand cable cover into the bracket.
- 3 Slide the handbrake cable equaliser over the cable from the handbrake lever and insert the pin.
- 4 Fit the circlip.

32. Adjust the handbrake cable as described in Op.no. 12 662 0.

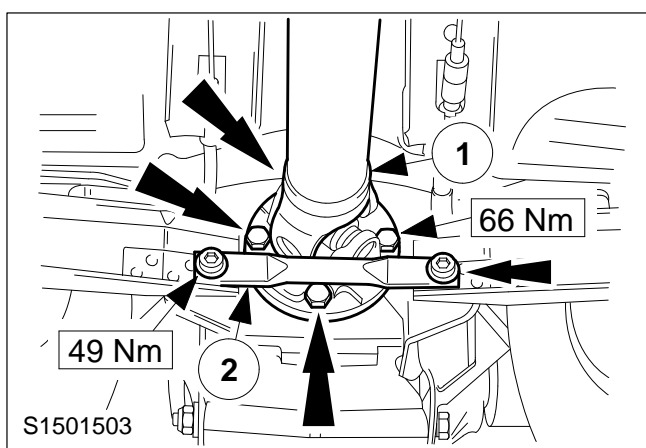

⚠ CAUTION: The driveshaft is precision-balanced by bolts of different lengths. Mark the position of the driveshaft and the bolts.

33. Fit the driveshaft to the rear axle transmission flange.

- 1 Fit the four bolts.

NOTE: The transverse brace will no longer be fitted in models built from Jan '96 onwards.

- 2 Attach the transverse brace.

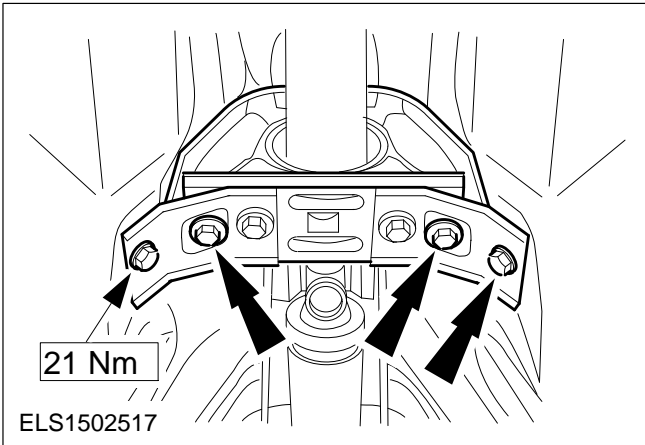

34. Align the centre bearing free of stress and tighten the bolts.

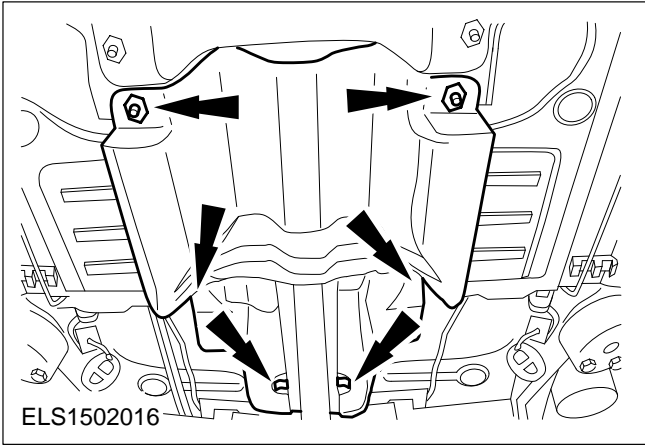

35. Fit the exhaust system rear heat shield.

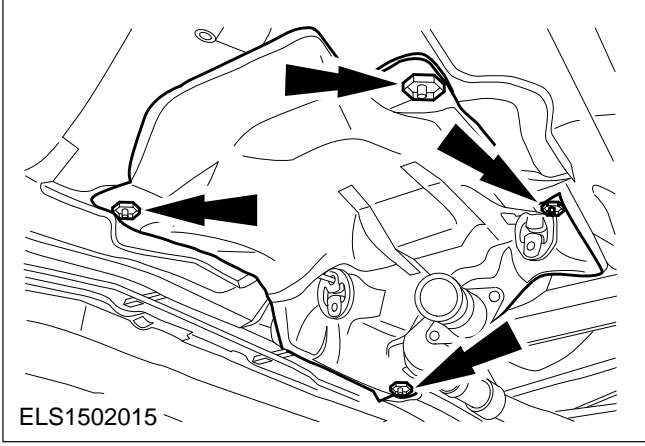

36. Fit the exhaust system front heat shield.

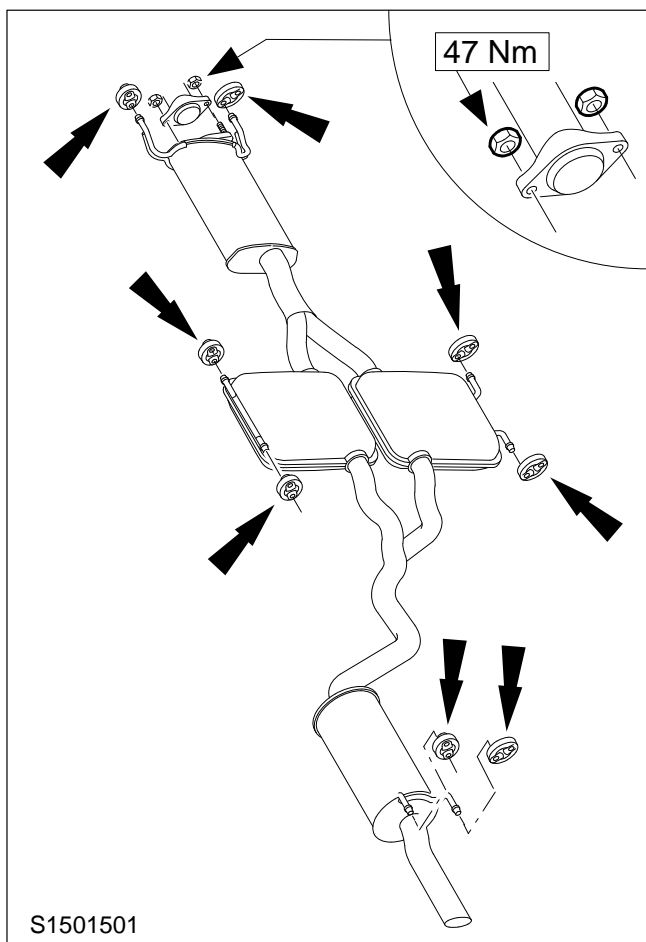

37. Fit the rear part of the exhaust system.

- Connect the pipe flanges, align the system and screw in the bolts.
- Hook the exhaust system into the rubber mountings.
- Tighten the bolts at the centre flange.

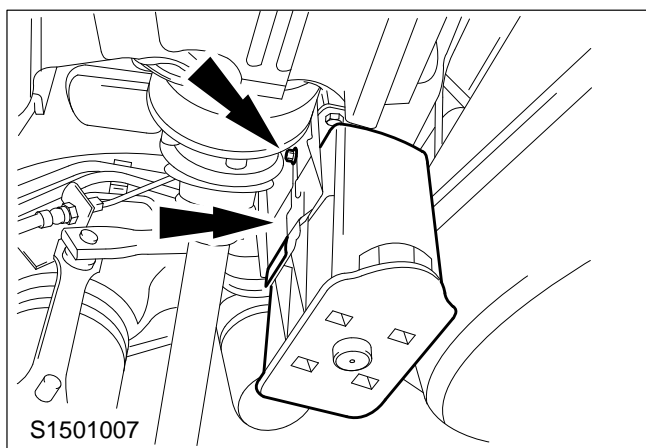

Petrol-engined variants only.

38. Fit the EVAP canister.

Hook the EVAP canister into the bracket and tighten the bolt.

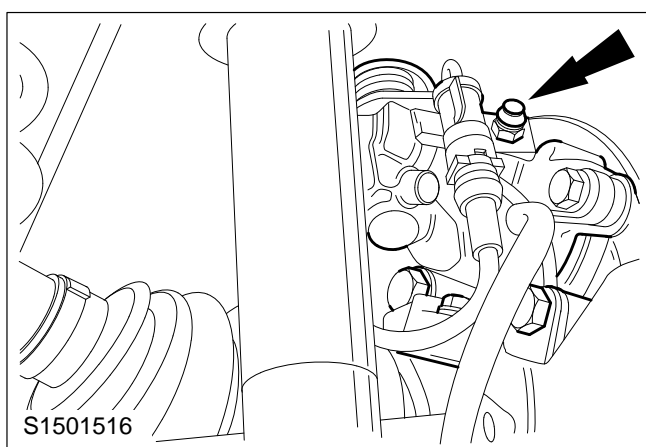

39. Bleed the brake system at both rear wheels as described in Op.no. 12 141 0.

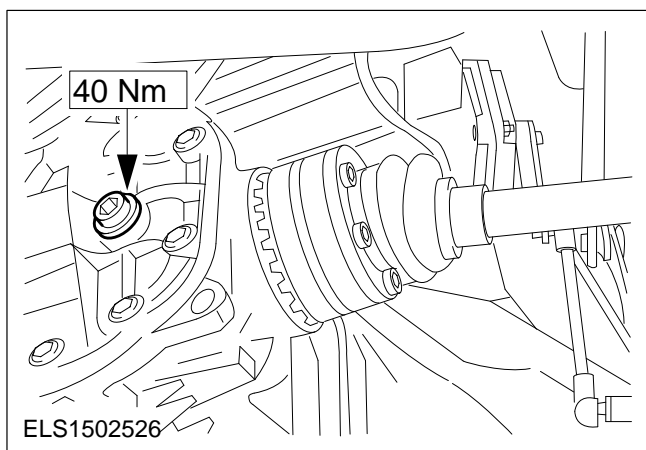
**40. Check the oil level in the differential.**

The differential should be filled with oil to the lower edge of the check bore.

41. Lower the vehicle.