

## Actuator – Speed Control – Remove and Install (33 678 0)

### Remove

**⚠ CAUTION:** Disconnect the battery negative lead.

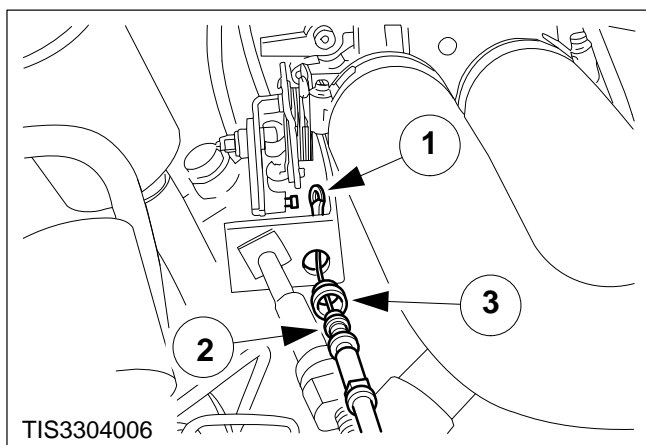

DOHC 2000 engine

### 1. Disconnect the throttle actuating cable.

- 1 Disconnect the actuating cable from the throttle linkage.
- 2 Remove the actuating cable from the throttle bracket.
- 3 Remove the retaining clip from the throttle bracket.

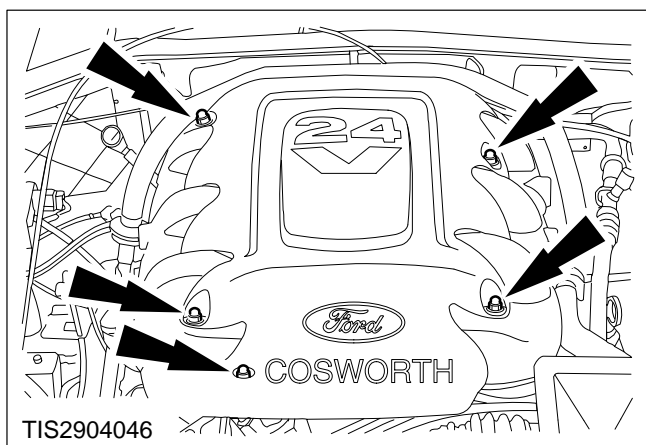

V6 24V engine

### 2. Remove the cover (five dome nuts).

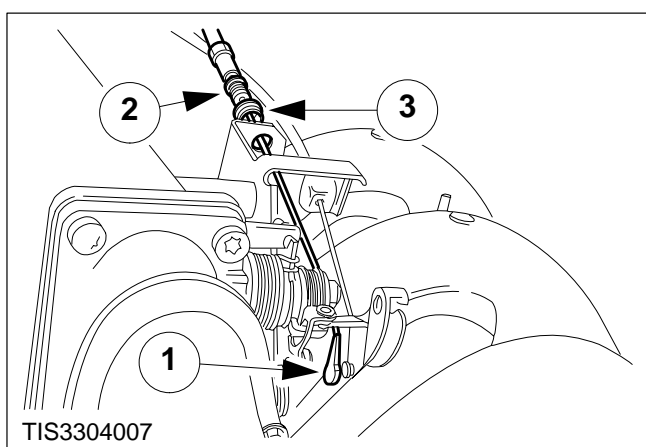

V6 24V engine

### 3. Disconnect the throttle actuating cable.

- 1 Disconnect the actuating cable from the throttle linkage.
- 2 Remove the actuating cable from the throttle bracket.
- 3 Remove the retaining clip from the throttle bracket.

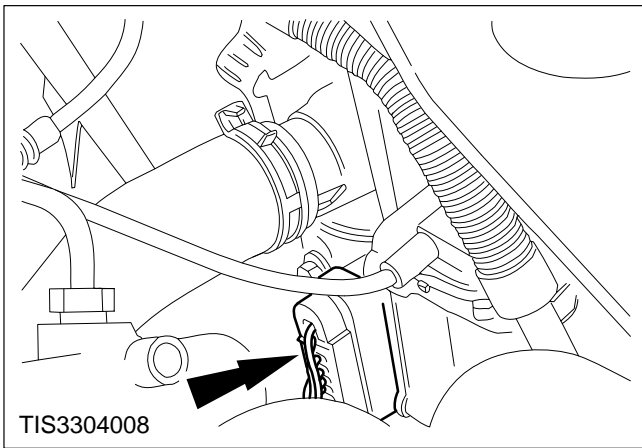

**4. Disconnect the actuator multiplug.**

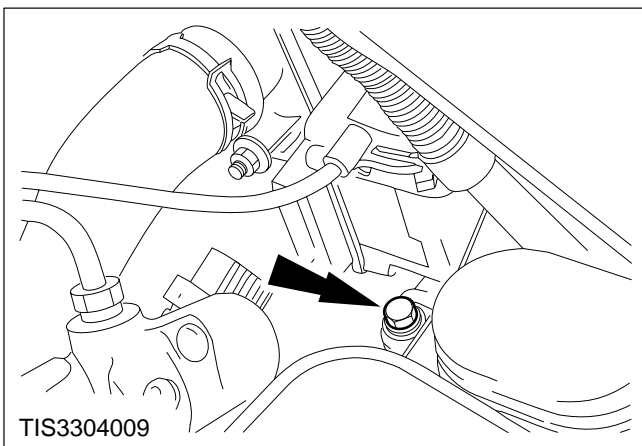

**5. Remove the actuator retaining bolt.**

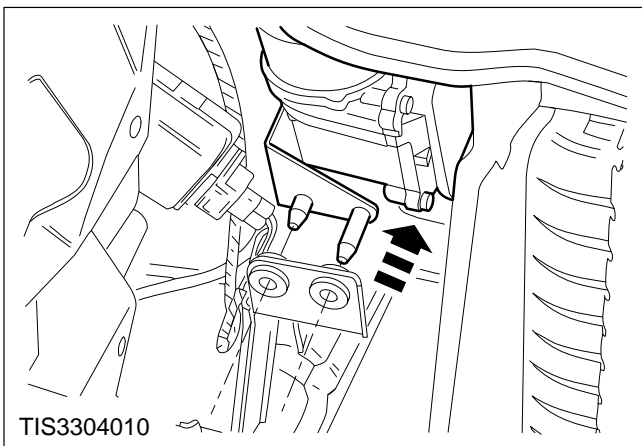

**6. Disengage the actuator retaining pins and remove the actuator (cover at side of headlamp shown removed for clarity).**

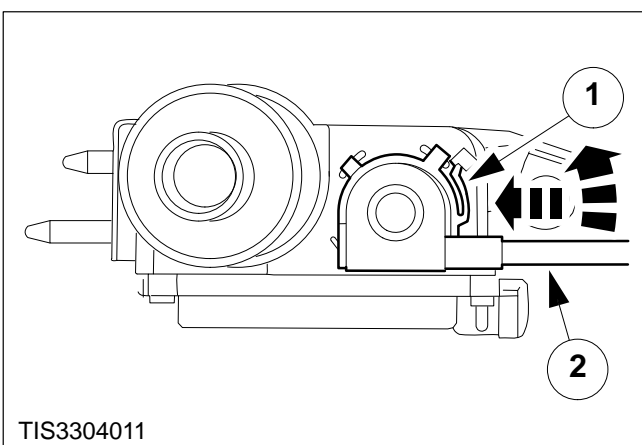

**Cable – Speed Control – Remove (33 679 0)**

**7. Remove the actuator pulley cap.**

- 1 Depress the cap locking arm.
- 2 Turn the cap and cable anti-clockwise.
  - Slide the cap along the cable.

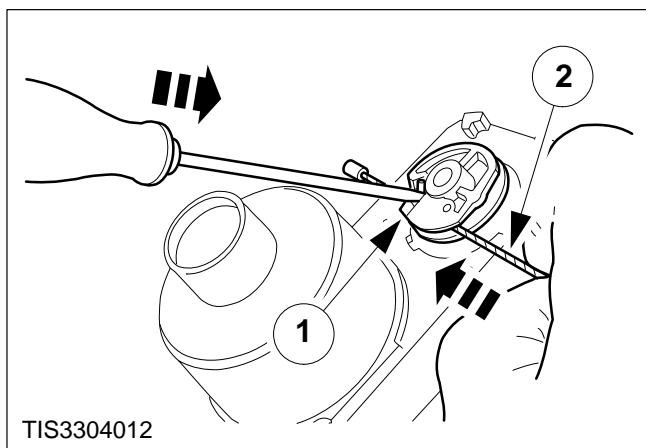

### 8. Remove the speed control cable from the actuator.

- 1 Gently release the cable locking spring.
- 2 Push the cable end out of the pulley slot.

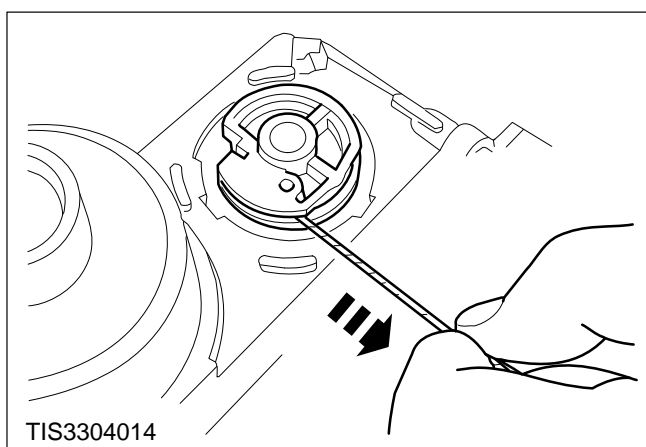

### Install

#### Cable – Speed Control – Install (33 679 0)

**⚠ CAUTION:** Incorrect fitting of the cable around the actuator pulley may result in a high idle condition. Ensure that the throttle lever is at idle position after refitting the cable.

### 9. Refit the cable end to the actuator pulley.

Ensure the cable end locks into the pulley slot.

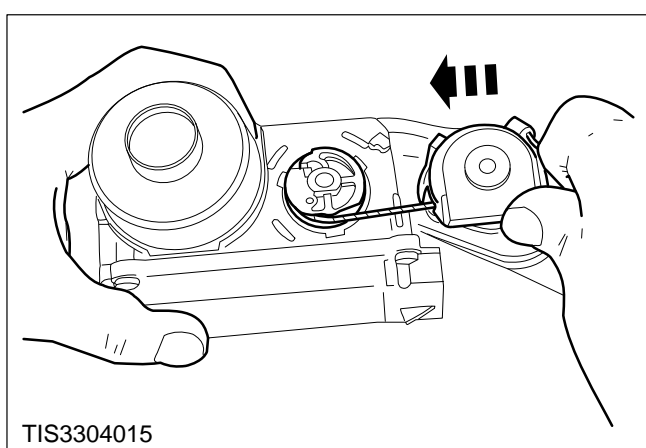

### 10. Locate the actuator pulley cap.

Keeping the cable taut and in the pulley groove, pull the throttle linkage end of the cable drawing the cap onto the actuator pulley.

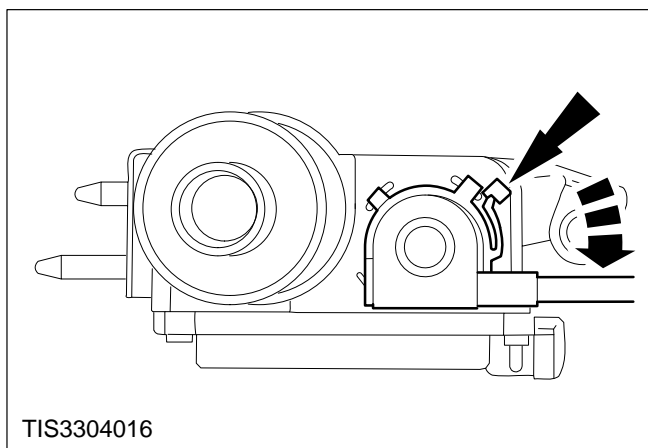
**11. Secure the cap.**

Keeping the cable taut and the pulley still, refit the cap tabs into the slots in the actuator body and turn the cap clockwise until the locking arm locates on the locking stop.

**12. Refit the remaining components in reverse order.**