

Steering Gear Assembly – Remove and Install (13 116 0)

Special Tools

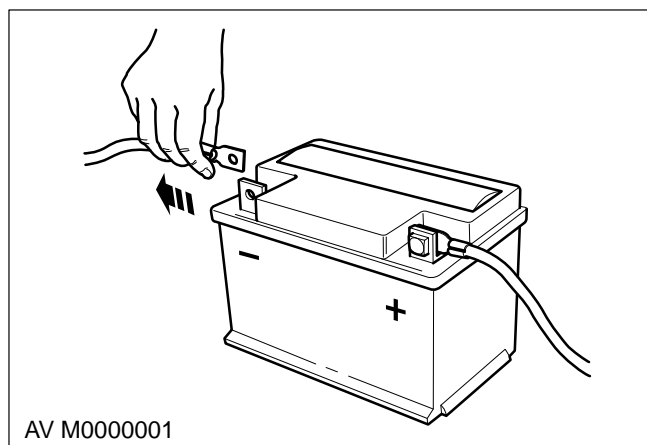
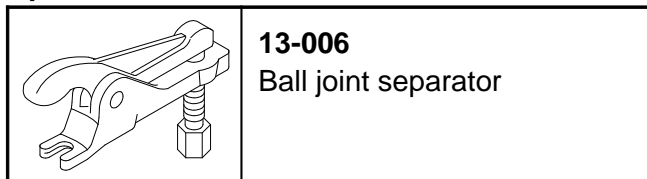

Remove

1. Disconnect the battery negative lead.

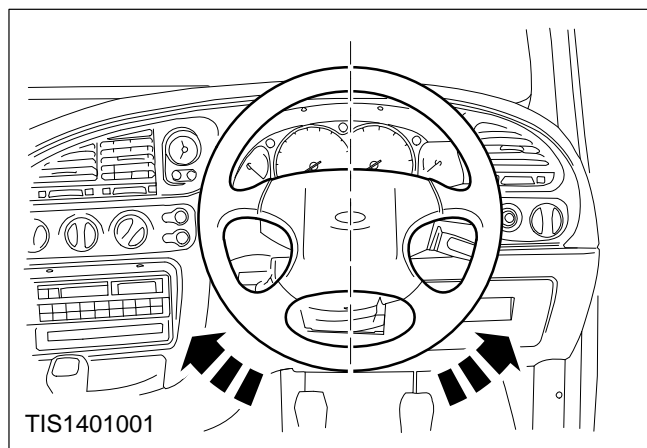

2. Centralise the steering wheel and lock in position.

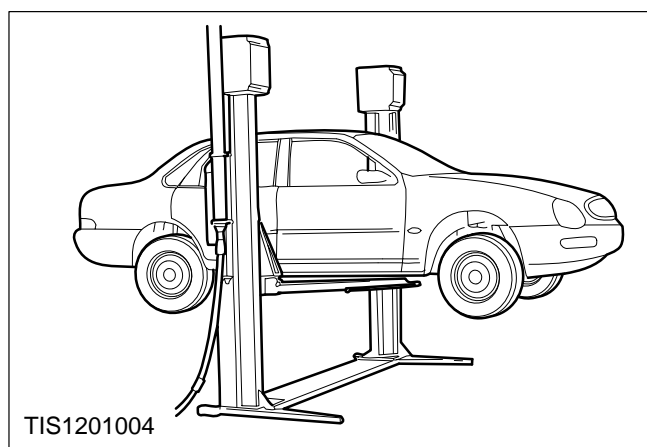

3. Slacken the wheel nuts, raise the vehicle and remove the front road wheels.

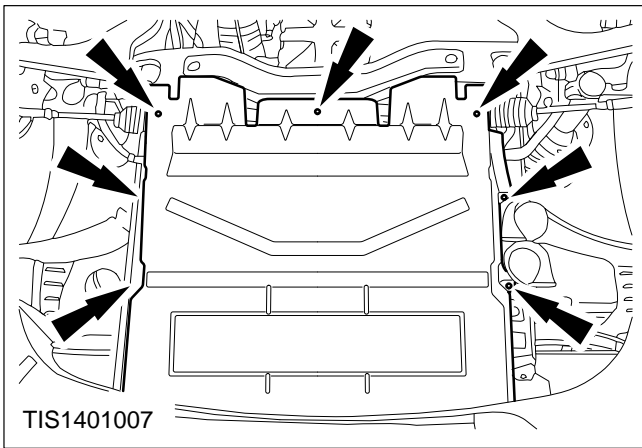

4. Remove the lower engine shield.

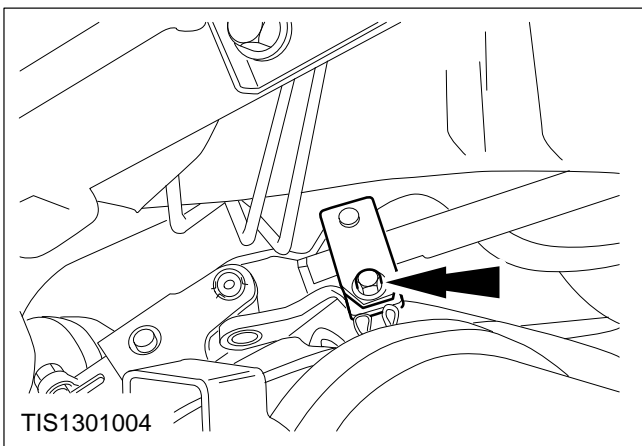

5. Remove the clamp plate bolt securing the flexible coupling to the steering column shaft.

Rotate the clamp plate to disengage.

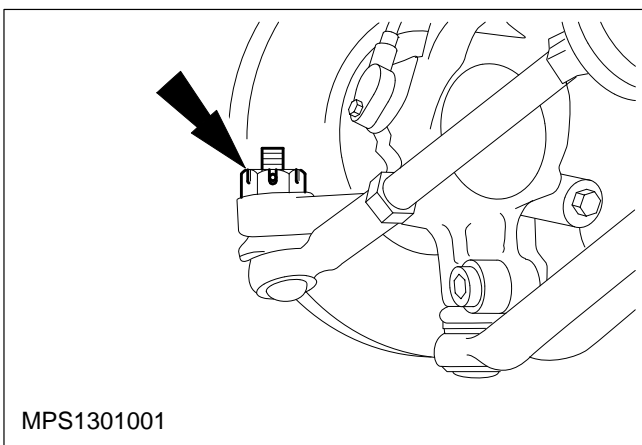

6. Remove the split pin and castellated nut from the steering track rod end.

Discard the split pin.

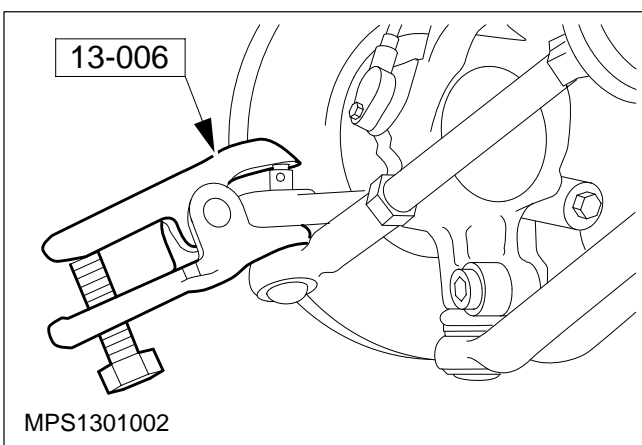

NOTE: When the track rod end is separated from the spindle carrier, the ball joint seal should be protected at all times by wrapping in a cloth.

7. Release the track rod end ball joints from the spindle carriers.

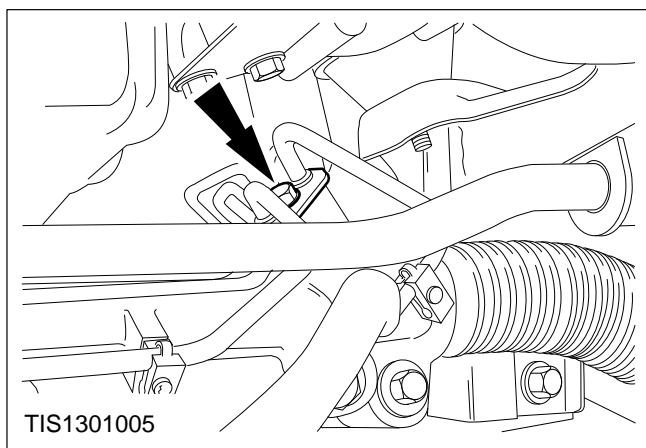

8. Remove the power steering pipe clamp plate bolt.

- Allow the fluid to drain into a suitable container.
- Blank off the pipe connections to prevent any dirt ingress.

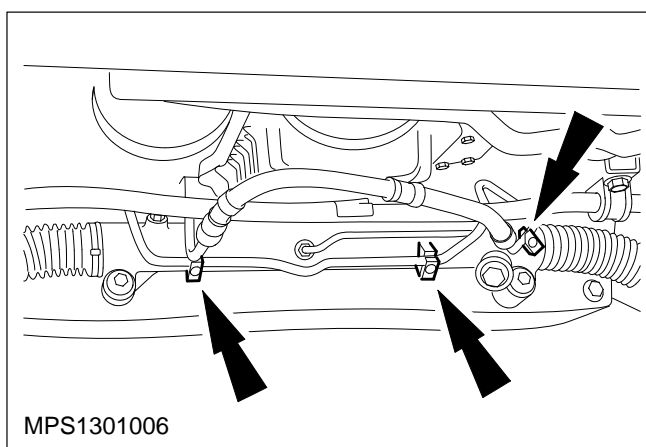

9. Disconnect the power steering pipes from the steering gear.

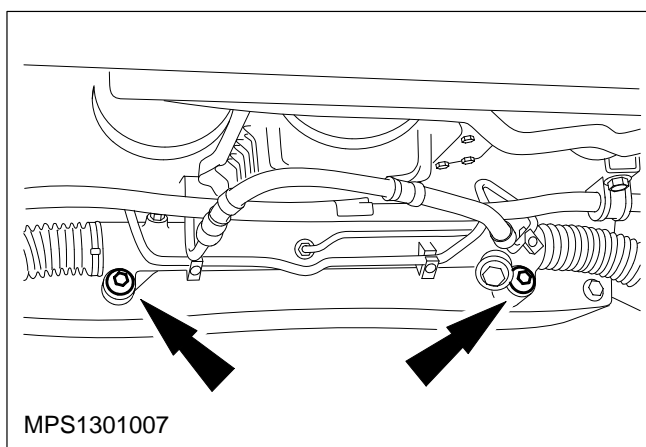

10. Remove the steering gear.

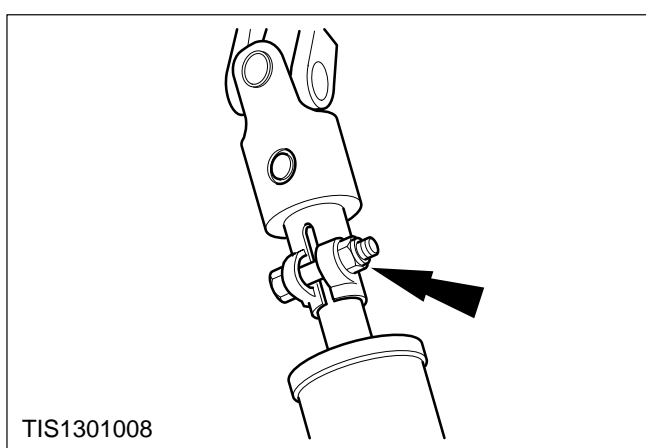

11. Remove the flexible coupling from the steering gear pinion.

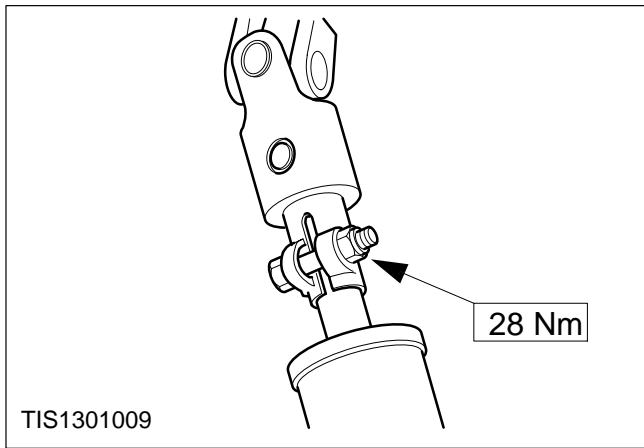
**Install**

- 12. Refit the flexible coupling to the steering gear pinion.**

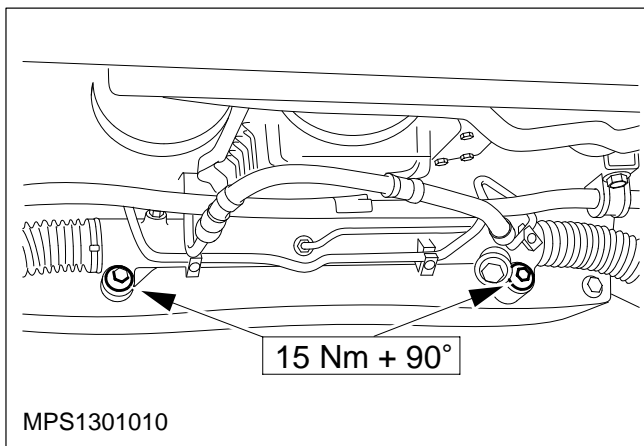

- 13. Refit the steering gear.**

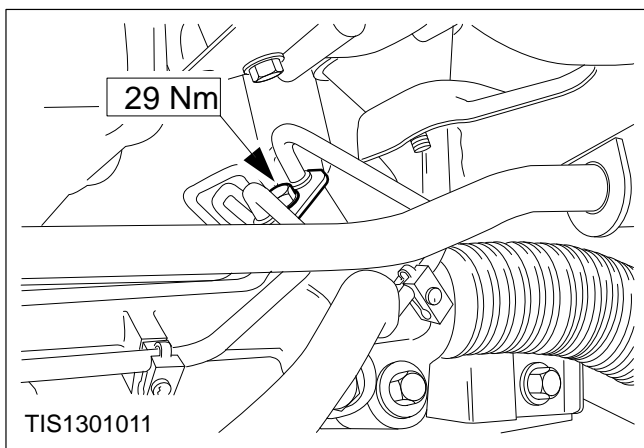

- 14. Refit the power steering pipe clamp plate bolt.**

- 15. Reconnect the power steering pipes to the steering gear.**

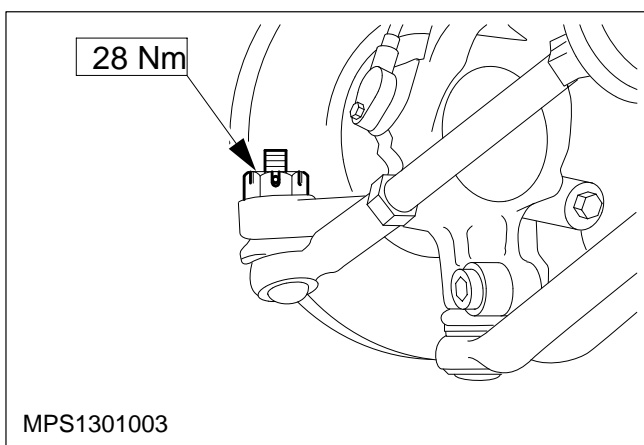

- 16. Refit the track rod end ball joints to the spindle carriers and secure the castellated nuts with new split pins.**

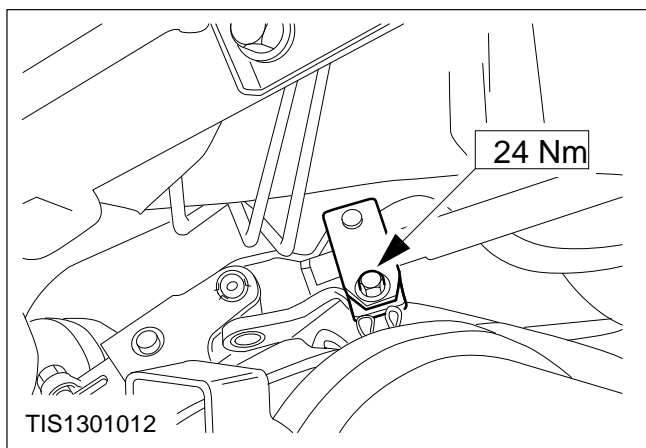

⚠ CAUTION: Before refitting the flexible coupling ensure that the steering is in the straight ahead position.

17. Align the flexible coupling clamp plate over the steering column shaft and secure with a new bolt.

18. Refit the lower engine shield.

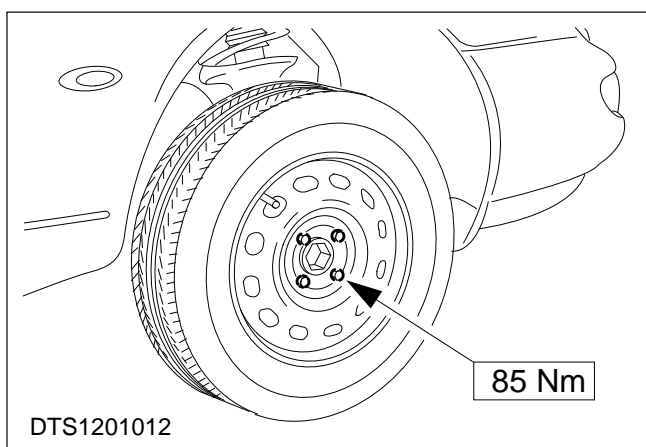

19. Refit the front road wheels and lower the vehicle.

20. Reconnect the battery negative lead.

21. Bleed the power steering system (refer to Operation Number 13 416 1).

22. Check the front wheel alignment (refer to Operation Numbers 14 111 0 and 14 111 3).