

Toe-In – Adjust (14 111 3)

Equipment

Wheel Alignment Gauge	Dunlop, Optiflex, Churchill, etc.
-----------------------	-----------------------------------

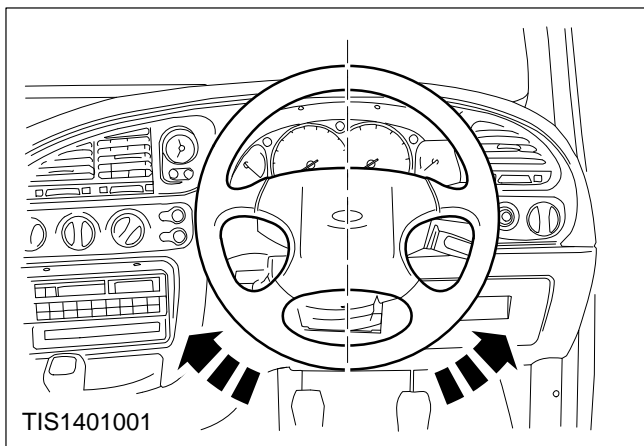

1. Centralise the steering wheel and lock in position.

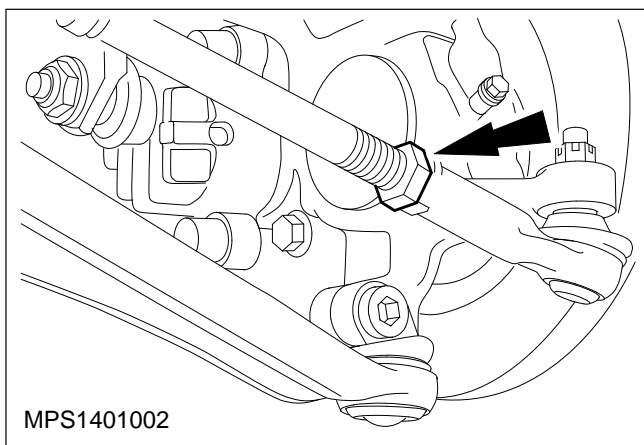

2. Slacken both the track rod end locknuts.

Mark the track rod ends and track rods before slackening the locknuts to aid the operation.

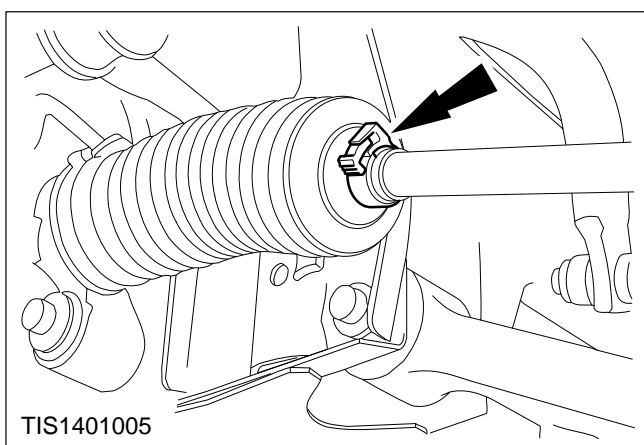

3. Remove the bellows outer retaining clips.

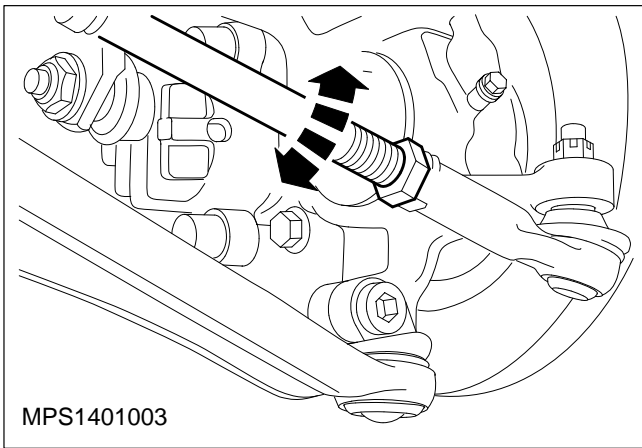

4. Rotate each track rod equally clockwise or anti-clockwise to adjust the toe setting.
5. Recheck toe-in and correct as necessary.

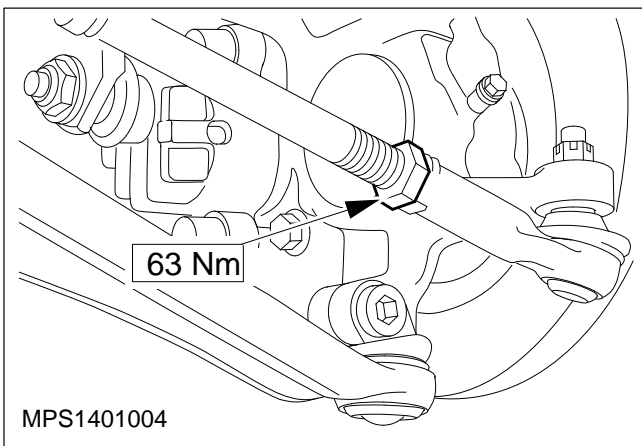

6. Tighten the track rod end locknuts.
7. Secure the bellows with new outer clips.