

## Wheel Bearing – Front Inner And Outer – Renew (Spindle Carrier Assembly Removed) (14 411 4)

### Special Tools

	<b>14-037</b> Installer, wheel hub
	<b>14-037-01</b> Adaptor threaded spindle, (LH thread) for 14-037
	<b>14-040</b> Installer, wheel bearing

	<b>15-091</b> Separator
	<b>15-092</b> Bridge, remover drive pinion bearing
	<b>21-069</b> Replacer/aligner, front cover

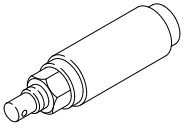
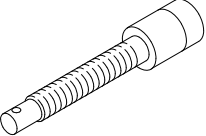
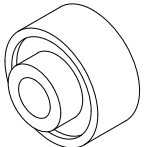
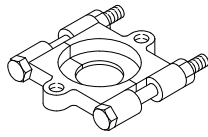
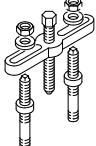
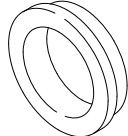
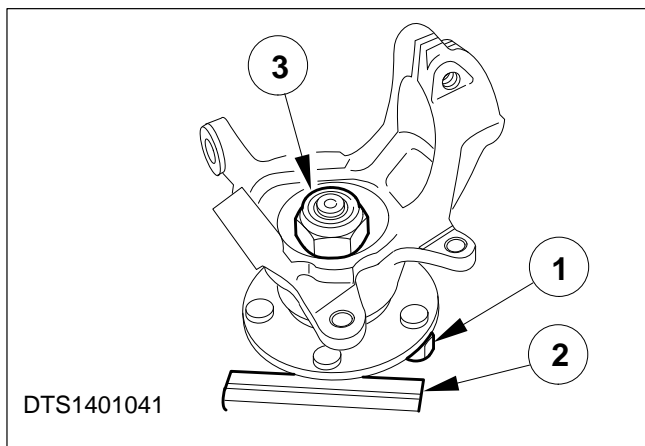

### Remove

**⚠ CAUTION:** The hub retaining nuts are handed. Right-hand thread on left-hand side and left-hand thread on right-hand side.

#### 1. Remove the hub retaining nut.

- 1 Fit the wheel nuts fully onto the wheel studs.
- 2 Mount the spindle carrier in a vice.

**⚠ CAUTION:** Only tighten the vice enough to secure the assembly, do not over tighten the vice.

- 3 Remove the hub retaining nut.

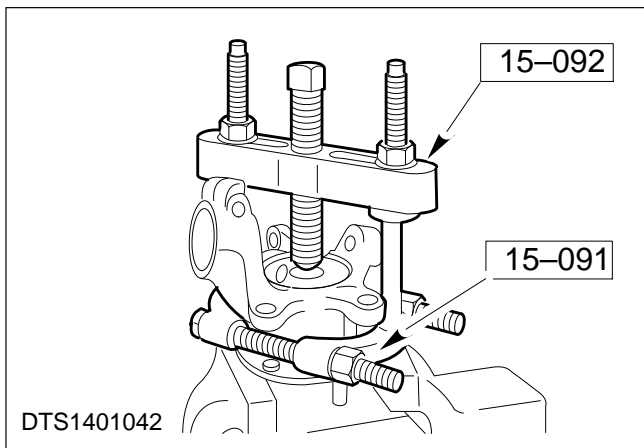

**NOTE:** When the hub assembly is disengaged from the spindle carrier the bearing will be damaged and will need to be renewed.

2. Remove the hub assembly from the spindle carrier.

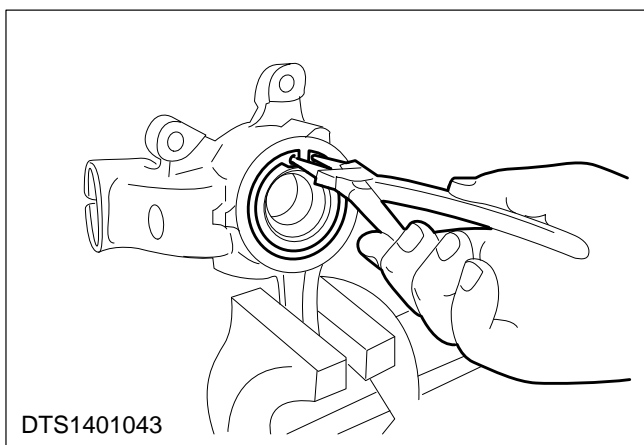

3. Remove the inner and outer snap rings, (outer ring shown).

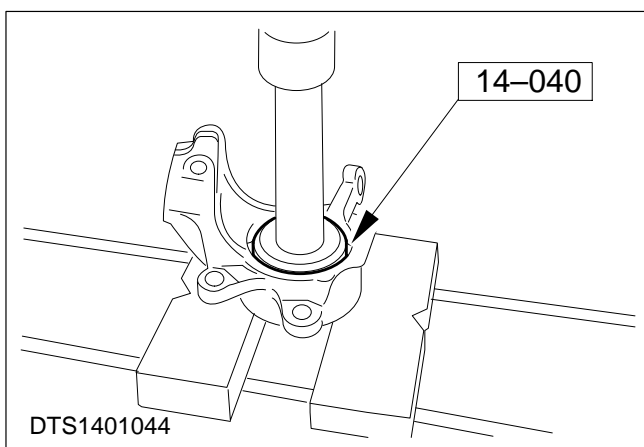

4. Press out the bearing.

**NOTE:** The bearing, when removed, must be discarded and replaced with a new bearing.

5. Clean all parts and inspect the spindle carrier housing for damage.

## Install

6. Fit a new outer snap ring to the spindle carrier.

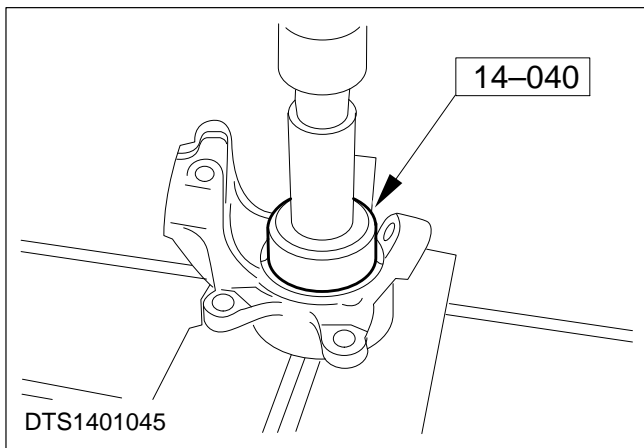

7. Press in the new bearing.
8. Reverse the spindle carrier and check that the bearing has seated correctly onto the outer snap ring.
9. Fit a new inner snap ring to the spindle carrier.

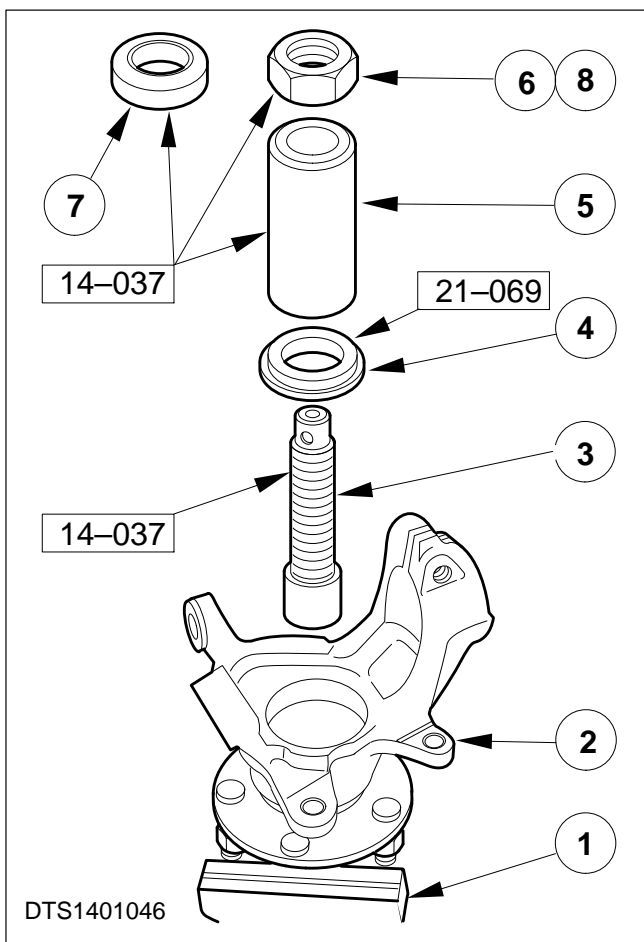

**NOTE:** Rotate the spindle carrier during this operation to ensure correct seating.

**10. Refit the hub assembly to the spindle carrier.**

- 1 Mount the hub assembly in a vice.
- 2 Locate the spindle carrier onto the hub assembly.

**NOTE:** Use special tool 14-037 for right-hand spindles and 14-037-01 for left-hand spindles.

- 3 Fit the spindle into the hub by 6-8 mm.
- 4 Fit special tool 21-069 over the spindle.
- 5 Fit the sleeve over the spindle.
- 6 Draw the hub assembly into the spindle carrier using the nut.
- 7 Remove the nut and fit the thrust bearing.
- 8 Refit the nut and pull the hub assembly fully into place.

**11. Refit the hub retaining nut.**

